

**EXTERIOR LEAD-BASED
PAINT SURVEY PROJECT RECORD**

**Grant Elementary School
2368 Pearl Street
Santa Monica, California 90405**

Prepared for:

**Santa Monica-Malibu Unified School District
1651 16th Street
Santa Monica, CA 90404**

Prepared by:

**CTL Environmental Services
24404 South Vermont Avenue, Suite 307
Harbor City, California 90710
(310) 530-5006**

January 10, 2007
CTL Project No. 106-0531

TABLE OF CONTENTS

EXECUTIVE SUMMARY

INVESTIGATION	1
METHODOLOGY	1
RESULTS	2
CONCLUSIONS & RECOMMENDATIONS	8
ASSUMPTIONS AND LIMITATIONS	9

TABLES/APPENDICES

- A. Lead Paint Chips Material Inventory
- B. Field Notes & Laboratory Results
- C. XRF Inventory and Field Notes
- D. Sample Location Map
- E. CTL Employee Certifications

EXECUTIVE SUMMARY



CTL Environmental Services

24404 South Vermont Avenue, Suite 307 • Harbor City, CA 90710 • TEL: (310) 530-5006 • FAX: (310) 530-0792

REPORTED: January 10, 2007

CTL JOB NO.: 106-0531

CLIENT: Santa Monica-Malibu Unified School District
1651 16th Street
Santa Monica, CA 90404

ATTENTION: Mr. Wally Berriman

RE: Exterior Lead-based Paint Survey
Grant Elementary School
2368 Pearl Street
Santa Monica, California 90405

INVESTIGATION

On December 18, 2006, CTL Environmental Services (CTL) conducted an inspection for the presence of lead based paint (LBP) from the buildings exteriors at the subject property.

Santa Monica-Malibu Unified School District, located at 1651 16th Street, Santa Monica, California, retained CTL for this investigation. The sampling was conducted by Victor Sanchez a DHS Accredited Lead Inspector/ Assessor, employed by CTL.

METHODOLOGY

Various painted surfaces of the building were tested for lead using a portable x-ray fluorescence (XRF) spectrum analyzer. The XRF used was the LPA-1, manufactured by Radiation Monitoring Devices (RMD) of Watertown, Massachusetts. XRF readings were taken by using the device "Quick" mode option. No time setting is required with this option since the device automatically adjusts its reading time to the different paint substrates for precision. The duration of each test result was determined by the substrate density in combination with the age of the radioactive source of the device and the actual reading relative to the "abatement" level (threshold) chosen. The testing combination includes a unique combination of room equivalent, building component type, and substrate.

An XRF Performance Characteristic Sheet (PCS) developed jointly by HUD and the Environmental Protection Agency (EPA) for the RMD LPA-1 was used. The PCS provides information necessary to conduct an inspection of LBP using specific XRF. Based on the PCS, no inconclusive readings in the "Quick" mode were encountered for LBP on brick, concrete, drywall, plaster, metal or wood substrates.

Field calibration checks were performed prior, during, and after each XRF lead inspection to determine that the device is functioning within acceptable limits (tolerance) determined by the manufacturer. Three readings of a red 1.02 mg/cm² Standard Reference Material (SRM) paint film, developed by the National Institute of Standard and Technology (NIST) were taken in the "30-Second Standard" mode option during each calibration check. Each set of readings were averaged and compared to the PCS calibration check limit for the device. Please refer to the attached Appendix C, Field Notes, for the documentation of the quality control calibration checks.

Paint chips were also collected to determine the weight percent concentration of lead in the painted surfaces that were found to be below the EPA, HUD or L.A. County levels analyzed by XRF for construction safety proposed as defined by *Title 8 CCR Section 1532.1*.

Samples of bulk paint chips were collected using a stainless steel scalpel using care to separate the paint chip from the substrate. Samples were placed in sealable sample containers and assigned a unique sample identification number. Various painted surfaces were tested for lead by paint chip sampling. Samples were collected from an approximate minimum area of one-square inch from the affected testing combinations for results to be reported as lead by weight (mg/kg or ppm) only.

Paint chip samples were analyzed at AmeriSci Los Angeles, an ELAP accredited laboratory in Carson, California.

RESULTS

Currently, the State of California, HUD, and the Environmental Protection Agency (EPA) define lead-based paint as paint or other surface coating with lead content equal to or greater than 1.0 mg/cm² of surface area. However, a more stringent level is established by the Los Angeles County Department of Health Services which defines "dangerous level of lead-bearing substances" as paint or other surface coating with lead in excess of 0.7 mg/cm² (*Los Angeles County Code, Title 11, Chapter 11.28, Section 11.28.010 C*).

Based on the location of the subject property in Los Angeles County, the "abatement" level (threshold) setting of 0.7 mg/cm² was chosen for the inspection.

Please refer to Appendix C, XRF Inventory and Field Notes, for a complete listing of locations analyzed. The following results of tested surfaces were found to contain lead equal or greater than 0.7 mg/cm²:

Grant Elementary School

Reading No.	Room Name	Wall	Structure	Material Location	Sample Location	Member	Paint Condition	Substrate	Paint Color	Lead (mg/cm ²)
5	Exterior room 1, Auditorium	A	Window	Auditorium building, all wood windows	Center	Right casing	F	Wood	White	2.0
6	Exterior room 1, Auditorium	A	Window	Auditorium building, all wood windows	Center	Sash	F	Wood	Gray	1.4
8	Exterior room 1, Auditorium	A	Door	Auditorium building, all wood door casings	Left	Left casing	I	Wood	Gray	1.8
16	Exterior room 1, Auditorium	C	Door	Auditorium building, all wood door casings	Right	Right casing	I	Wood	White	2.0
17	Exterior room 1, Auditorium	C	Post	Exterior walkways	Center	N/A	P	Metal	Gray	>9.9
18	Exterior room 1, Auditorium	C	Ceiling	Exterior walkways	Center	N/A	P	Wood	White	3.3
19	Exterior room 1, Auditorium	C	Beam	Exterior walkways	Center	N/A	P	Wood	White	3.0
21	Exterior room 2, Library	A	Window	Library building, all wood windows	Center	Right casing	F	Wood	Gray	5.9
22	Exterior room 2, Library	A	Window	Library building, all wood windows	Center	Sash	F	Wood	Gray	8.5
24	Exterior room 2, Library	A	Door	Library building, all door casings except classrooms	Center	Right casing	P	Wood	Gray	1.5
29	Exterior room 2, Library	D	Wall	Library building, west side (splash wall)	L Center	N/A	I	Ceramic	White	5.0

Grant Elementary School

Reading No.	Room Name	Wall	Structure	Material Location	Sample Location	Member	Paint Condition	Substrate	Paint Color	Lead (mg/cm ²)
39	Exterior room 3, Cafeteria/ rooms 54-63	A	Window	Cafeteria / Buildings 54-63, all windows except classrooms	Center	Right casing	P	Wood	Gray	1.8
41	Exterior room 3, Cafeteria/ rooms 54-63	A	Window	Cafeteria / Buildings 54-63, all windows except classrooms	Center	Sash	F	Wood	Gray	1.2
38	Exterior room 3, Cafeteria/ rooms 54-63	A	Door	Cafeteria / Buildings 54-63, all doors except classrooms	Center	Right casing	P	Wood	Gray	2.1
50	Exterior room 3, Cafeteria/ rooms 54-63	D	Trim	All sides of building	Center	N/A	I	Wood	Gray	3.9
73	Exterior room 5, Buildings 37-40	A	Door	Buildings 37-40, north side entrances to classrooms (w/glass)	Center	Right casing	F	Wood	Gray	9.6
72	Exterior room 5, Buildings 37-40	A	Door	Buildings 37-40, north side entrances to classrooms (w/glass)	Center	U Center	F	Wood	Gray	>9.9
67	Exterior room 5, Buildings 37-40	A	Ceiling	Exterior walkways	Left	N/A	P	Wood	White	>9.9
68	Exterior room 5, Buildings 37-40	A	Beam	Exterior walkways	Left	N/A	P	Wood	White	>9.9
66	Exterior room 5, Buildings 37-40	A	Post	Exterior walkways	Right	N/A	P	Metal	Gray	8.5
61	Exterior room 5, Buildings 37-40	C	Downspout	Buildings 37-40	Left	N/A	F	Metal	White	2.5
64	Exterior room 5, Buildings 37-40	C	Trim	Buildings; Administration, 11-13, 2-5, Cafeteria, Library, Auditorium	Center	N/A	I	Wood	Gray	1.9

Grant Elementary School

Reading No.	Room Name	Wall	Structure	Material Location	Sample Location	Member	Paint Condition	Substrate	Paint Color	Lead (mg/cm ²)
81	Exterior room 6, east Sanitary building	C	Door	East Sanitary building, all	Left	Left casing	F	Wood	Gray	7.8
80	Exterior room 6, east Sanitary building	C	Door	East Sanitary building, all	Left	L Left	F	Wood	Gray	7.2
83	Exterior room 6, east Sanitary building	D	Window	East Sanitary building, all	Center	Right casing	P	Wood	Gray	8.6
82	Exterior room 6, east Sanitary building	D	Window	East Sanitary building, all	Center	Sash	P	Wood	Gray	>9.9
87	Exterior room 7, west Sanitary building	B	Window	West Sanitary building, all	Center	Sash	P	Stucco	White	1.9
88	Exterior room 7, west Sanitary building	B	Window	West Sanitary building, all	Center	Left casing	P	Stucco	White	>9.9
91	Exterior room 7, west Sanitary building	C	Door	West Sanitary building, all	Center	Right casing	I	Stucco	White	6.6
90	Exterior room 7, west Sanitary building	C	Door	West Sanitary building, all	Center	L Center	I	Stucco	White	7.2
105	Exterior room 8, Administration building	A	Window	Administration building, all except classrooms	Left	Sash	I	Wood	Gray	>9.9
104	Exterior room 8, Administration building	A	Window	Administration building, all except classrooms	Left	Left casing	I	Wood	Gray	>9.9
103	Exterior room 8, Administration building	A	Door	Administration building, all	Center	Left casing	F	Wood	Gray	8.9
102	Exterior room 8, Administration building	A	Door	Administration building, all	Center	L Center	F	Wood	Gray	>9.9
107	Exterior room 8, Administration building	A	Trim	Buildings; Administration, 11-13, 2-5, Cafeteria, Library, Auditorium	Left	N/A	I	Wood	Gray	>9.9

Grant Elementary School

Reading No.	Room Name	Wall	Structure	Material Location	Sample Location	Member	Paint Condition	Substrate	Paint Color	Lead (mg/cm ²)
97	Exterior room 8, Administration building	C	Door	Administration building, all	Left	U Left	P	Wood	Gray	6.6
100	Exterior room 8, Administration building	D	Post	Exterior walkways	Center	N/A	P	Metal	Gray	>9.9
117	Exterior room 9, Buildings 11-13	A	Fascia	Buildings 11-13	N/A	N/A	F	Wood	White	5.7
113	Exterior room 9, Buildings 11-13	A	Window	Buildings 11-13, all windows	Right	Right casing	P	Wood	Gray	5.2
114	Exterior room 9, Buildings 11-13	A	Window	Buildings 11-13, all windows	Right	Sash	P	Wood	Gray	5.5
116	Exterior room 9, Buildings 11-13	A	Railing	Buildings 11-13, north side	Center	Railing	P	Metal	White	7.7
115	Exterior room 9, Buildings 11-13	A	Ceiling	Buildings 11-13, north side	Center	N/A	P	Wood	White	3.7
111	Exterior room 9, Buildings 11-13	C	Window	Buildings 11-13, all windows	Center	Right casing	I	Wood	Gray	4.0
110	Exterior room 9, Buildings 11-13	C	Window	Buildings 11-13, all windows	Center	Sash	I	Wood	Gray	6.5
109	Exterior room 9, Buildings 11-13	C	Door	Buildings 11-13, all door casings	Center	Left casing	F	Wood	Gray	1.6
122	Exterior room 10, Buildings 2-5	C	Door	Buildings 2-5, all door casings	Center	Right casing	F	Wood	Gray	2.0
120	Exterior room 10, Buildings 2-5	C	Post	Exterior walkways	Center	N/A	F	Metal	Gray	1.6
127	Exterior room 10, Buildings 2-5	A	Window	Buildings 2-5, all window sills	Center	Sill	P	Wood	Gray	3.9
128	Exterior room 10, Buildings 2-5	A	Downspout	Buildings 2-5, all	Center	N/A	F	Metal	White	1.7

Grant Elementary School

Reading No.	Room Name	Wall	Structure	Material Location	Sample Location	Member	Paint Condition	Substrate	Paint Color	Lead (mg/cm ²)
138	Exterior room 11, Buildings 26-31	B	Door	Buildings 26-31, all doors, except classrooms east and south sides	Left	Left casing	I	Wood	Gray	9.2
137	Exterior room 11, Buildings 26-31	B	Door	Buildings 26-31, all doors, except classrooms east and south sides	Left	U Left	I	Wood	Gray	9.0
142	Exterior room 11, Buildings 26-31	B	Ceiling	Exterior walkways	Center	N/A	F	Wood	White	6.8
143	Exterior room 11, Buildings 26-31	B	Beam	Exterior walkways	Center	N/A	F	Wood	White	5.8
136	Exterior room 11, Buildings 26-31	C	Downspout	Buildings 26-31, all	Center	N/A	F	Metal	White	4.4
140	Exterior room 11, Buildings 26-31	D	Post	Exterior walkways	Left	N/A	F	Metal	Gray	0.8

The following are painted surfaces with results equal to or greater than 5,000 ppm of lead as tested by paint chip analysis. These surfaces are subject to regulation by the County of Los Angeles, the Cal-DHS, and the EPA.

Grant Elementary School

Component	Sample No.	Substrate	Paint Color	Material Location	Results (PPM)
Window casing	5665	Metal	Blue	Building 2-5	7,200

The following are results of painted surfaces with any detectable levels of lead in paint below 5,000 ppm that were determined by paint chip sampling. When disturbed for construction purposes these surfaces are subjected to Cal-OSHA exposure assessment requirements set forth in *Title 8 CCR, Section 1532.1(d)*. This regulation requires initial employee exposure monitoring to evaluate work exposure during work that disturbs paint with any detectable level of lead. If airborne lead levels are above the established Cal-OSHA Action Limit (AL) or Permissible Exposure Limit (PEL), additional monitoring and respiratory protection is required.

Grant Elementary School

Component	Sample No.	Substrate	Paint Color	Material Location	Results (PPM)
Door	5654	Metal	Gray	Auditorium building, Library, Cafeteria, Buildings 37-40, 26-31, 80-83, Sanitary building-all classrooms doors and door casings	140
Downspout	5655	Metal	White	Buildings; Auditorium, Library, Cafeteria/54-63, east and west Sanitary, Administration	670
Piping	5657	Metal	White	Buildings; Auditorium, Library, Cafeteria/54-63, 80-83, 2-5, 11-13, Administration, 37-40, 26-31, east and west Sanitary building	190
Handrail	5666	Metal	Blue	Sanitary buildings	170

CONCLUSIONS & RECOMMENDATIONS

Abatement is recommended for damaged LBPs, or if the condition of the materials, which are noted as being in good condition, change. Abatement is also recommended for paints impacted by renovation or demolition activities.

According to Federal Regulations and Guidelines, LBP abatement is the permanent (defined as designed to last at least 20 years, or, in case of encapsulation, a 20-year product warranty) elimination of LBP hazards through replacement, enclosure, encapsulation, paint removal, and cleaning to remove lead-contaminated dust.

The chance exists that additional suspect lead-containing materials may be exposed during demolition and/or renovation activities. Such materials should be sampled and analyzed for lead content prior to any renovation and/or demolition activities that may impact these materials.

Workers trained in proper safety and respiratory techniques should perform renovation activities that may impact the LBP described in this report.

Work activities impacting LBPs pose a potential exposure risk for workers and/or building occupants. All construction work where an employee may be occupationally exposed to lead must comply with Cal-OSHA requirements set forth in 8 CCR 1532.1. This regulation requires initial employee exposure monitoring to evaluate worker exposure during work that disturbs lead-containing materials (lead present in detectable levels).

CTL suggests that engineering controls, respiratory protection and personal protective equipment be employed at the start of a project that may disturb LBP.

Additionally, waste items generated during an abatement or demolition project should be properly sampled and profiled to determine the final disposition of the waste.

An Operations & Maintenance (O&M) program is recommended for the identified LBPs which are in good condition.

Unlike abatement, an O&M program or interim control is a set of measures designed to temporarily reduce human exposure or possible exposure to LBP hazards. Such measures may include specialized cleaning, repairs, maintenance, painting, temporary containment, and management and resident education programs. Visual monitoring conducted by owners, and/or reevaluations by risk assessors are integral elements of an interim control. An initial evaluation of potential LBP hazard by a certified risk assessor is recommended for a successful implementation of the interim controls.

ASSUMPTIONS AND LIMITATIONS

This report has been prepared for the exclusive use of Santa Monica-Malibu Unified School District. In performing our professional services, we have applied present engineering and scientific judgment and used a level of effort consistent with the standard of practice measured on the date of work in the locale of the project site for similar type studies.

CTL has relied in good faith upon representations and information furnished by individuals with respect to operations and existing property conditions to the extent that they have not been contradicted by data obtained from other sources. Accordingly, CTL accepts no responsibility for any deficiencies, omissions, misrepresentations, or fraudulent acts of persons interviewed. In addition, CTL will not accept liability for any loss, injury, claim, or damage arising directly or indirectly from any use or reliance on this report. CTL makes no warranty, expressed or implied.

Material quantities are in some cases listed within this document. These quantities are not intended to be used for removal bidding purposes. Nor is this document intended as a contract manual. Work methods and sequence, coordination of participants, applicable codes, engineering controls, required submittals, and notifications should in all cases be addressed in a separate and independent bidding and contract document.

If you have any questions, please feel free to contact the undersigned at (310) 530-5006. We appreciate the opportunity to be of service to Santa Monica-Malibu Unified School District.

Respectfully submitted,
CTL Environmental Services



Marie Tullai, CIH
Director, Hazardous Materials Division
Certified Lead Inspector/Assessor
DHS Cert. #I-11088

Reviewed by



Cesar Ruvalcaba, CAC
Project Manager, Hazardous Materials Division
Certified Lead Inspector/Assessor
DHS Cert. #I-6855

MT/lb

Attachments

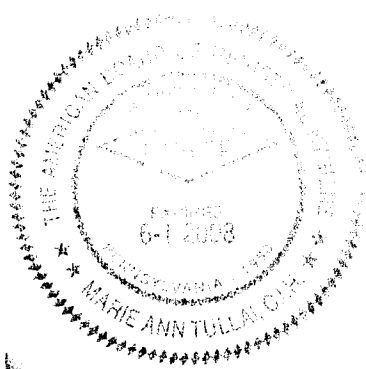

APPENDIX A

LEAD PAINT CHIPS MATERIAL INVENTORY

MATERIAL INVENTORY **PAINT CHIP SAMPLES**

Page 1 of 2

CLIENT: Santa Monica-Malibu Unified School District

PROJECT NO: 106-0531

PROJECT NAME: Grant Elementary School

Component	Sample No.	Substrate	Paint Color	Sample Location	Material Location	Results (PPM)
Wall	5652	Stucco	White	Auditorium building, northwest	Buildings; auditorium, library, cafeteria/54-63, 80-83, 2-5, 11-13, administration, 37-40, 26-31, sanitary building and east and west sanitary walls and walkway ceilings	<100
Flashing	5653	Metal	Gray	Building 26-31, southwest	Buildings; auditorium, library, cafeteria/54-63, 80-83, 2-5, 11-13, administration, 37-40, 26-31, sanitary building and east and west sanitary flashings	<100
Door	5654	Metal	Gray	Buildings 26-31, southeast	Auditorium buildings, library, cafeteria, buildings 37-40, 26-31, 80-83, sanitary building-all classrooms door and door casings	140
Downspout	5655	Metal	White	Administration building, southwest, south face	Buildings; auditorium, library, cafeteria/54-63, east and west sanitary, administration	670
Door	5656	Wood	Gray	Cafeteria building at north entrance to cafeteria	Library building, cafeteria building, and buildings 37-40 - all doors except classroom, Buildings 11-13 all doors, buildings 2-5, all doors	<100
Piping	5657	Metal	White	Building 37-40, southwest	Buildings; auditorium, library, cafeteria/54-63, 80-83, 2-5, 11-13, administration, 37-40, 26-31, east and west sanitary	190
Vent	5658	Metal	White	Building 11-13, northwest above room 13A	Buildings; auditorium, library, cafeteria/54-63, 2-5, 11-13, administration, 37-40, 26-31, east and west sanitary vents on walls and above doors	<100
Wall	5659	Wood	White	Portable 73, northeast	Portables 70-75, exterior walls	<100

MATERIAL INVENTORY PAINT CHIP SAMPLES

CLIENT: Santa Monica-Malibu Unified School District

PROJECT NO: 106-0531

PROJECT NAME: Grant Elementary School

Component	Sample No.	Substrate	Paint Color	Sample Location	Material Location	Results (PPM)
Door	5660	Metal	Gray	Portable 75, northeast, east face	Portables 70-75, doors and door casings	<100
Window casings	5661	Wood	Gray	Portable 70, east center	Portables 70, 71 window casings, wall corner guards, portables 70, 71, 73, 74, 75, skirts and ceilings (walkways)	<100
Downspout	5662	Metal	Gray	Portable 74, northeast	Portables 70-75 downspouts, flashings, and gutters	<100
Support beam/facia	5663	Metal	Gray	Portable 75, northwest	Portables 73, 74, 75, support beams/facia, portables 70, 71, 73, 74, 75, skirts	<100
Wall	5664	Brick	Green	Southwest play ground, west center	Southwest playground	<100
Window casing	5665	Metal	Blue	Building 2-5, northeast	Building 2-5	7,200
Handrail	5666	Metal	Blue	Sanitary building, northwest	Sanitary buildings	170
Handrail	5667	Metal	Blue	Portable 72, southeast	Portables 70-75 on east side	<100

APPENDIX B

FIELD NOTES & LABORATORY RESULTS

CTL ENVIRONMENTAL SERVICES PAINT CHIP SAMPLE LIST

CLIENT: Santa Monica Malibu U.S.O.

PROJECT NO.: 106-0531

PROJECT NAME: Grant E.S.

Technician: N. Sanchez

DATE: 12-18-06

PAGE: 1 of 2

PHOTO #	COMPONENT	SAMPLE #	SUBSTRATE	PAINT COLOR	SAMPLE LOCATION	MATERIAL LOCATION
	wall	5652	stucco	white	Auditorium bldg. w/w.	Bldgs: Auditorium, library, cafeteria/54-63, 80-83, 2-5, 11-13, Admin, 37-40
						26-31, sanitary bldg. & EAST & WEST sanitary walls and walking ceilings
	flashing	5653	metal	gray	bldg 26-31 s/w.	Bldgs: Auditorium, library, cafeteria/54-63 80-83, 2-5, 11-13, Admin, 37-40, 26-31 Sanitary bldg. & EAST & WEST Sanitary. Flashings.
	door	5654	metal	gray	bldg 26-31 s/e.	Auditorium bldg., library bldg. classroom doors & ceilings cafeteria bldg. classroom doors & ceilings, bldg 80-83 doors & ceilings, bldg 37-40 classroom doors & ceilings bldg 26-31 classroom doors & ceilings, sanitary bldg.
	door	5655	metal	white	Admin bldg s/w. (south faced)	Bldgs: Auditorium, library, cafeteria/54-63 EAST & WEST Sanitary, ceiling,
	door	5656	wood	gray	cafeteria bldg. & w/o entrance to cafeteria.	library bldg. all doors except classrooms cafeteria bldg all doors except classrooms, bldg 37-40 all doors except classrooms bldg 11-13 all doors bldg 2-5 all doors
	Piping	5657	metal	white	bldg 37-40 s/w	Bldgs: Auditorium, library, cafeteria/54-63 8083, 2-5, 11-13, Admin, 37-40, 26-31, EAST & WEST Sanitary.

CTL ENVIRONMENTAL SERVICES PAINT CHIP SAMPLE LIST

CLIENT: Santa Monica Malibu USD
 PROJECT NO.: 106-0537
 PROJECT NAME: Grant E.S.

Technician: N. Sanchez
 DATE: 12-18-06
 PAGE: 2 of 2

PHOTO #	COMPONENT	SAMPLE #	SUBSTRATE	PAINT COLOR	SAMPLE LOCATION	MATERIAL LOCATION
	vent	5658	metal	white	Bldg 11-13 p/w above rm 13A	Bldgs: Auditorium, Library, cafeteria/5661 275, 11-13 Admin, 37-40 26-31, EAST & WEST SANITARY VENTS on walls & above doors.
	wall	5659	wood	white	portable 73 w/e	portables 70-75 exterior walls
	door	5660	metal	gray	portable 75 w/e EAST FACE	portables 70-75 doors & door casings
	wooden casing	5661	wood	gray	portable 70 EAST CORN	portables 70, 71 window casings, wall corner guards, portables 70, 71, 73, 74, 75 skirts & ceilings (ceilingings)
	downspout	5662	metal	gray	portable 74 w/e	portables 70-75 downspouts flashings & gutters
	support beam/beam/wall	5663	metal	gray	portable 75 w/e	portables 73, 74, 75 support beam/flashings
	wall	5664	brick	green	sp/w play ground west side	portables 70, 71, 72, 74, 75 skirts sp/w play ground
	wooden casing	5665	metal	blue	bldg 2-5 w/e	bldg 2-5
	wood panel	5666	metal	blue	sanitary bldg w/e	sanitary bldgs sanitary
	wood panel	5667	metal	blue	portable 72 s/e	portables 70-75 on west side

AMERISCI

AmeriSci Los Angeles

24416 SOUTH MAIN STREET • SUITE 308

CARSON, CA 90745

TEL: (310) 834-4868 • FAX: (310) 834-4772

December 27, 2006

CTL Environmental Services
Attn: Cesar Rubalcaba
24404 S. Vermont Ave.
Suite 307
Harbor City, CA 90710

RE: CTL Environmental Services
Job Number 406121230
P.O. # SMMUSD
SMMUSD; 106-0531; Grant E.S.

Dear Cesar Rubalcaba:

Enclosed are the results for lead analysis of the following CTL Environmental Services sample(s) received at AmeriSci on December 18, 2006, for a 5 day turnaround:

5652, 5653, 5654, 5655, 5656, 5657, 5658, 5659, 5660, 5661, 5662, 5663, 5664, 5665, 5666, 5667

The 16 sample(s) contained in Ziplock Bags were shipped to AmeriSci via Hand delivery. The sample(s) were received in Good condition. The sample(s) were prepared and analyzed by modified EPA SW-846 Methods 3050 & 7420 using Flame Atomic Absorption Spectroscopy.

Table I represents a summary of the analysis results. Unless otherwise specified, all quality control data met acceptance criteria.

This report relates ONLY to the sample analysis expressed as lead in ppm (mg/kg). AmeriSci assumes no responsibility for customer supplied data such as "sample location" or "area of collection". Complete analytical documentation is archived and available upon written request. The National Institute of Standards and Technology Accreditation requirements, mandates that this report must not be reproduced, except in full without the written approval of the laboratory.

AmeriSci appreciates this opportunity to serve your organization. Please contact us for any further assistance or questions.

Sincerely,

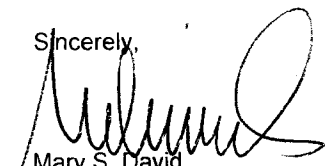

Mary S. David
Client Services Manager

**AmeriSci Los Angeles**

24416 S. Main Street, Ste 308
Carson, California 90745
TEL: (310) 834-4868 • FAX: (310) 834-4772

AmeriSci Job #: 406121230

Lead Analysis Results

Date Received: 12/18/06

Date Analyzed: 12/27/06

Paint

EPA Method 3050/7420

CTL Environmental Services

Harbor City, CA

Job Site: SMMUSD; 106-0531; Grant E.S.

AmeriSci # 406121230	Client Number	Sample Location	% Lead (w/w)	Lead (mg/kg = ppm)
01	5652	Wall Stucco White	<0.01	<100
02	5653	Flashing Metal Gray	<0.01	<100
03	5654	Door Metal Gray	0.014	140
04	5655	Downspout Metal White	0.067	670
05	5656	Door Wood Gray	<0.01	<100
06	5657	Piping Metal White	0.019	190
07	5658	Vent Metal White	<0.01	<100
08	5659	Wall Wood White	<0.01	<100
09	5660	Door Metal Gray	<0.01	<100
10	5661	Window Casing Wood Gray	<0.01	<100
11	5662	Downspout Metal Gray	<0.01	<100
12	5663	Support Beam / Facia Metal Gray	<0.01	<100
13	5664	Wall Brick Green	<0.01	<100
14	5665	Window Casing Metal Blue	0.72	7200
15	5666	Handrail Metal Blue	0.017	170
16	5667	Handrail Metal Blue	<0.01	<100

AmeriSci Reporting Limit is 0.01%, or 100mg/kg.
AmeriSci does not correct sample results by the blank value.
CA ELAP No. 2322. AIHA Lab No. 100530.

Reviewed by:

Analyzed by:

Minh Q. Phung

APPENDIX C

XRF INVENTORY AND FIELD NOTES

Positive XRF Shot List

Grant Elementary School

Reading No.	Room Name	Wall	Structure	Material Location	Sample Location	Member	Paint Condition	Substrate	Paint Color	Lead (mg/cm ²)
5	Exterior room 1, Auditorium	A	Window	Auditorium building, all wood windows	Center	Right casing	F	Wood	White	2.0
6	Exterior room 1, Auditorium	A	Window	Auditorium building, all wood windows	Center	Sash	F	Wood	Gray	1.4
8	Exterior room 1, Auditorium	A	Door	Auditorium building, all wood door casings	Left	Left casing	I	Wood	Gray	1.8
16	Exterior room 1, Auditorium	C	Door	Auditorium building, all wood door casings	Right	Right casing	I	Wood	White	2.0
17	Exterior room 1, Auditorium	C	Post	Exterior walkways	Center	N/A	P	Metal	Gray	>9.9
18	Exterior room 1, Auditorium	C	Ceiling	Exterior walkways	Center	N/A	P	Wood	White	3.3
19	Exterior room 1, Auditorium	C	Beam	Exterior walkways	Center	N/A	P	Wood	White	3.0
21	Exterior room 2, Library	A	Window	Library building, all wood windows	Center	Right casing	F	Wood	Gray	5.9
22	Exterior room 2, Library	A	Window	Library building, all wood windows	Center	Sash	F	Wood	Gray	8.5
24	Exterior room 2, Library	A	Door	Library building, all door casings except classrooms	Center	Right casing	P	Wood	Gray	1.5
29	Exterior room 2, Library	D	Wall	Library building, west side (splash wall)	L Center	N/A	I	Ceramic	White	5.0
39	Exterior room 3, Cafeteria/ rooms 54-63	A	Window	Cafeteria / Buildings 54-63, all windows except classrooms	Center	Right casing	P	Wood	Gray	1.8

Positive XRF Shot List

Grant Elementary School

Reading No.	Room Name	Wall	Structure	Material Location	Sample Location	Member	Paint Condition	Substrate	Paint Color	Lead (mg/cm ²)
41	Exterior room 3, Cafeteria/ rooms 54-63	A	Window	Cafeteria / Buildings 54-63, all windows except classrooms	Center	Sash	F	Wood	Gray	1.2
38	Exterior room 3, Cafeteria/ rooms 54-63	A	Door	Cafeteria / Buildings 54-63, all doors except classrooms	Center	Right casing	P	Wood	Gray	2.1
50	Exterior room 3, Cafeteria/ rooms 54-63	D	Trim	All sides of building	Center	N/A	I	Wood	Gray	3.9
73	Exterior room 5, Buildings 37-40	A	Door	Buildings 37-40, north side entrances to classrooms (w/glass)	Center	Right casing	F	Wood	Gray	9.6
72	Exterior room 5, Buildings 37-40	A	Door	Buildings 37-40, north side entrances to classrooms (w/glass)	Center	U Center	F	Wood	Gray	>9.9
67	Exterior room 5, Buildings 37-40	A	Ceiling	Exterior walkways	Left	N/A	P	Wood	White	>9.9
68	Exterior room 5, Buildings 37-40	A	Beam	Exterior walkways	Left	N/A	P	Wood	White	>9.9
66	Exterior room 5, Buildings 37-40	A	Post	Exterior walkways	Right	N/A	P	Metal	Gray	8.5
61	Exterior room 5, Buildings 37-40	C	Downspout	Buildings 37-40	Left	N/A	F	Metal	White	2.5
64	Exterior room 5, Buildings 37-40	C	Trim	Buildings; Administration, 11-13, 2-5, Cafeteria, Library, Auditorium	Center	N/A	I	Wood	Gray	1.9
81	Exterior room 6, east Sanitary building	C	Door	East Sanitary building, all	Left	Left casing	F	Wood	Gray	7.8
80	Exterior room 6, east Sanitary building	C	Door	East Sanitary building, all	Left	L Left	F	Wood	Gray	7.2
83	Exterior room 6, east Sanitary building	D	Window	East Sanitary building, all	Center	Right casing	P	Wood	Gray	8.6

Positive XRF Shot List

Grant Elementary School

Reading No.	Room Name	Wall	Structure	Material Location	Sample Location	Member	Paint Condition	Substrate	Paint Color	Lead (mg/cm ²)
82	Exterior room 6, east Sanitary building	D	Window	East Sanitary building, all	Center	Sash	P	Wood	Gray	>9.9
87	Exterior room 7, west Sanitary building	B	Window	West Sanitary building, all	Center	Sash	P	Stucco	White	1.9
88	Exterior room 7, west Sanitary building	B	Window	West Sanitary building, all	Center	Left casing	P	Stucco	White	>9.9
91	Exterior room 7, west Sanitary building	C	Door	West Sanitary building, all	Center	Right casing	I	Stucco	White	6.6
90	Exterior room 7, west Sanitary building	C	Door	West Sanitary building, all	Center	L Center	I	Stucco	White	7.2
105	Exterior room 8, Administration building	A	Window	Administration building, all except classrooms	Left	Sash	I	Wood	Gray	>9.9
104	Exterior room 8, Administration building	A	Window	Administration building, all except classrooms	Left	Left casing	I	Wood	Gray	>9.9
103	Exterior room 8, Administration building	A	Door	Administration building, all	Center	Left casing	F	Wood	Gray	8.9
102	Exterior room 8, Administration building	A	Door	Administration building, all	Center	L Center	F	Wood	Gray	>9.9
107	Exterior room 8, Administration building	A	Trim	Buildings Administration, 11-13, 2-5, Cafeteria, Library, Auditorium	Left	N/A	I	Wood	Gray	>9.9
97	Exterior room 8, Administration building	C	Door	Administration building, all	Left	U Left	P	Wood	Gray	6.6
100	Exterior room 8, Administration building	D	Post	Exterior walkways	Center	N/A	P	Metal	Gray	>9.9
117	Exterior room 9, Buildings 11-13	A	Fascia	Buildings 11-13	N/A	N/A	F	Wood	White	5.7
113	Exterior room 9, Buildings 11-13	A	Window	Buildings 11-13, all windows	Right	Right casing	P	Wood	Gray	5.2
114	Exterior room 9, Buildings 11-13	A	Window	Buildings 11-13, all windows	Right	Sash	P	Wood	Gray	5.5

Positive XRF Shot List

Grant Elementary School

Reading No.	Room Name	Wall	Structure	Material Location	Sample Location	Member	Paint Condition	Substrate	Paint Color	Lead (mg/cm ²)
116	Exterior room 9, Buildings 11-13	A	Railing	Buildings 11-13, north side	Center	Railing	P	Metal	White	7.7
115	Exterior room 9, Buildings 11-13	A	Ceiling	Buildings 11-13, north side	Center	N/A	P	Wood	White	3.7
111	Exterior room 9, Buildings 11-13	C	Window	Buildings 11-13, all windows	Center	Right casing	I	Wood	Gray	4.0
110	Exterior room 9, Buildings 11-13	C	Window	Buildings 11-13, all windows	Center	Sash	I	Wood	Gray	6.5
109	Exterior room 9, Buildings 11-13	C	Door	Buildings 11-13, all door casings	Center	Left casing	F	Wood	Gray	1.6
122	Exterior room 10, Buildings 2-5	C	Door	Buildings 2-5, all door casings	Center	Right casing	F	Wood	Gray	2.0
120	Exterior room 10, Buildings 2-5	C	Post	Exterior walkways	Center	N/A	F	Metal	Gray	1.6
127	Exterior room 10, Buildings 2-5	A	Window	Buildings 2-5, all window sills	Center	Sill	P	Wood	Gray	3.9
128	Exterior room 10, Buildings 2-5	A	Downspout	Buildings 2-5, all	Center	N/A	F	Metal	White	1.7
138	Exterior room 11, Buildings 26-31	B	Door	Buildings 26-31, all doors, except classrooms east and south sides	Left	Left casing	I	Wood	Gray	9.2
137	Exterior room 11, Buildings 26-31	B	Door	Buildings 26-31, all doors, except classrooms east and south sides	Left	U Left	I	Wood	Gray	9.0
142	Exterior room 11, Buildings 26-31	B	Ceiling	Exterior walkways	Center	N/A	F	Wood	White	6.8
143	Exterior room 11, Buildings 26-31	B	Beam	Exterior walkways	Center	N/A	F	Wood	White	5.8
136	Exterior room 11, Buildings 26-31	C	Downspout	Buildings 26-31, all	Center	N/A	F	Metal	White	4.4
140	Exterior room 11, Buildings 26-31	D	Post	Exterior walkways	Left	N/A	F	Metal	Gray	0.8

DETAILED REPORT OF LEAD PAINT INSPECTION FOR: SMMUSD

Inspection Date: 12/18/06
 Report Date: 12/27/2006
 Abatement Level: 0.8
 Report No. 12/18/06 10:11
 Total Readings: 178
 Job Started: 12/18/06 10:11
 Job Finished: 12/18/06 13:19
 Conducted by: Victor Sanchez
 Certification number: 10148
 CTL job number: 106-0531
 Grant Elementary School

Read No.	Wall	Structure	Location	Member	Paint Cond	Substrate	Paint Color	Lead (mg/cm ²)	Mode
Exterior Room 001 Auditorium									
004	A	Wall	L Ctr		I	Stucco	White	0.1	QM
005	A	Window	Ctr	Rgt casing	F	Wood	White	2.0	QM
006	A	Window	Ctr	Sash	F	Wood	Gray	1.4	QM
008	A	Door	Lft	Lft casing	I	Wood	Gray	1.8	QM
007	A	Door	Lft	U Lft	I	Metal	Gray	-0.2	QM
012	B	Wall	U Ctr		I	Stucco	White	0.1	QM
013	B	Handrail	Lft		F	Metal	Gray	-0.1	QM
014	B	D Spout.	Lft		I	Metal	White	0.0	QM
015	B	Vent	Ctr		I	Metal	White	0.5	QM
011	C	Wall	L Ctr		I	Stucco	White	0.2	QM
016	C	Door	Rgt	Rgt casing	I	Wood	White	2.0	QM
017	C	Post	Ctr		P	Metal	Gray	>9.9	QM
018	C	Ceiling	Ctr		P	Wood	White	3.3	QM
019	C	Beam	Ctr		P	Wood	White	3.0	QM
010	D	Door	Ctr	Rgt casing	I	Metal	Gray	0.0	QM
009	D	Door	Ctr	L Ctr	I	Metal	Gray	-0.1	QM
Exterior Room 002 Library									
020	A	Wall	L Ctr		I	Stucco	White	0.0	QM
021	A	Window	Ctr	Rgt casing	F	Wood	Gray	5.9	QM
022	A	Window	Ctr	Sash	F	Wood	Gray	8.5	QM
024	A	Door	Ctr	Rgt casing	P	Wood	Gray	1.5	QM
025	A	Door	Ctr	L Ctr	I	Wood	Gray	-0.1	QM
023	A	D Spout.	Ctr		I	Metal	White	0.0	QM
026	B	Wall	L Rgt		I	Stucco	White	0.3	QM
027	C	Wall	L Rgt		I	Metal	Gray	0.0	QM
032	C	Wall	U Rgt		I	Stucco	White	0.3	QM
028	C	Door	Rgt	Rgt casing	I	Metal	Gray	-0.1	QM
031	C	Flashing	Ctr		I	Metal	Gray	0.0	QM
033	C	Pipe	Rgt		I	Metal	White	0.2	QM
029	D	Wall	L Ctr		I	Ceramic	White	5.0	QM
030	D	Wall	L Ctr		I	Ceramic	Blue	-0.1	QM
034	D	Wall	L Ctr		I	Stucco	White	-0.1	QM
035	D	Vent	Ctr		I	Metal	White	0.0	QM

DETAILED REPORT OF LEAD PAINT INSPECTION FOR: SMMUSD

Inspection Date: 12/18/06
 Report Date: 12/27/2006
 Abatement Level: 0.8
 Report No. 12/18/06 10:11
 Total Readings: 178
 Job Started: 12/18/06 10:11
 Job Finished: 12/18/06 13:19
 Conducted by: Victor Sanchez
 Certification number: 10148
 CTL job number: 106-0531
 Grant Elementary School

Exterior Room 003 Cafeteria/ Rooms 54-63

036	A	Wall	L Rgt	I	Stucco	White	0.2	QM
039	A	Window	Ctr Rgt casing	P	Wood	Gray	1.8	QM
041	A	Window	Ctr Sash	F	Wood	Gray	1.2	QM
038	A	Door	Ctr Rgt casing	P	Wood	Gray	2.1	QM
037	A	Door	Ctr U Ctr	P	Wood	Gray	0.2	QM
042	A	Vent	Lft	I	Metal	White	0.1	QM
040	A	Pipe	Ctr	I	Metal	White	0.0	QM
043	B	Wall	U Ctr	I	Stucco	White	0.3	QM
047	B	Door	Lft Lft casing	I	Metal	Gray	-0.1	QM
046	B	Door	Lft L Lft	I	Metal	Gray	0.0	QM
044	B	D Spout.	Rgt	F	Metal	White	-0.1	QM
045	B	Flashing	Rgt	I	Metal	Gray	0.1	QM
049	C	Wall	L Ctr	I	Stucco	White	0.0	QM
048	D	Wall	U Ctr	I	Stucco	White	0.0	QM
050	D	Trim	Ctr	I	Wood	Gray	3.9	QM

Exterior Room 004 Bldg 80-83

053	A	Wall	L Rgt	I	Metal	Gray	0.5	QM
054	B	Wall	L Ctr	I	Metal	Gray	0.4	QM
055	C	Wall	U Lft	I	Metal	Gray	0.4	QM
056	C	Fascia		I	Metal	Gray	0.0	QM
057	C	Flashing	Ctr	I	Metal	Gray	0.0	QM
052	D	Door	Ctr Rgt casing	I	Metal	Gray	0.4	QM
051	D	Door	Ctr U Ctr	I	Metal	Gray	0.0	QM

Exterior Room 005 Bldg 37-40

070	A	Wall	L Ctr	I	Stucco	White	-0.1	QM
073	A	Door	Ctr Rgt casing	F	Wood	Gray	9.6	QM
072	A	Door	Ctr U Ctr	F	Wood	Gray	>9.9	QM
067	A	Ceiling	Lft	P	Wood	White	>9.9	QM
068	A	Beam	Lft	P	Wood	White	>9.9	QM
066	A	Post	Rgt	P	Metal	Gray	8.5	QM
069	B	Wall	L Lft	I	Stucco	White	0.2	QM
058	C	Wall	L Ctr	I	Stucco	White	0.2	QM
063	C	Door	Lft Lft casing	I	Metal	Gray	0.0	QM
062	C	Door	Lft U Lft	I	Metal	Gray	0.1	QM
060	C	Door	Rgt Rgt casing	F	Wood	Gray	-0.3	QM
059	C	Door	Rgt U Rgt	F	Wood	Gray	0.0	QM
061	C	D Spout.	Lft	F	Metal	White	2.5	QM
065	C	Flashing	Lft	I	Metal	Gray	0.1	QM
064	C	Trim	Ctr	I	Wood	Gray	1.9	QM
071	D	Wall	U Lft	I	Stucco	White	0.0	QM

DETAILED REPORT OF LEAD PAINT INSPECTION FOR: SMMUSD

Inspection Date: 12/18/06
 Report Date: 12/27/2006
 Abatement Level: 0.8
 Report No. 12/18/06 10:11
 Total Readings: 178
 Job Started: 12/18/06 10:11
 Job Finished: 12/18/06 13:19
 Conducted by: Victor Sanchez
 Certification number: 10148
 CTL job number: 106-0531
 Grant Elementary School

Exterior Room 006 East Sanitary Bldg

078	A	Wall	U Ctr	I	Ceramic	White	0.2	QM
079	A	D Spout.	Lft	I	Metal	White	-0.2	QM
077	B	Wall	L Ctr	I	Ceramic	White	0.2	QM
075	C	Wall	L Ctr	I	Stucco	White	0.0	QM
076	C	Wall	L Ctr	I	Ceramic	White	-0.3	QM
081	C	Door	Lft Lft casing	F	Wood	Gray	7.8	QM
080	C	Door	Lft L Lft	F	Wood	Gray	7.2	QM
074	D	Wall	L Ctr	I	Stucco	White	0.2	QM
083	D	Window	Ctr Rgt casing	P	Wood	Gray	8.6	QM
082	D	Window	Ctr Sash	P	Wood	Gray	>9.9	QM

Exterior Room 007 West Sanitary Bldg

084	A	Wall	U Lft	F	Stucco	White	0.2	QM
085	A	Flashing	Lft	I	Stucco	White	0.0	QM
086	B	Wall	L Ctr	F	Stucco	White	0.1	QM
087	B	Window	Ctr Sash	P	Stucco	White	1.9	QM
088	B	Window	Ctr Lft casing	P	Stucco	White	>9.9	QM
089	B	Flashing	Ctr	I	Stucco	White	0.2	QM
093	C	Wall	L Lft	I	Stucco	White	0.2	QM
092	C	Wall	L Ctr	I	Stucco	White	-0.1	QM
091	C	Door	Ctr Rgt casing	I	Stucco	White	6.6	QM
090	C	Door	Ctr L Ctr	I	Stucco	White	7.2	QM
094	D	Wall	L Rgt	I	Stucco	White	0.2	QM

Exterior Room 008 Administration Bldg

106	A	Wall	L Ctr	I	Stucco	White	0.0	QM
105	A	Window	Lft Sash	I	Wood	Gray	>9.9	QM
104	A	Window	Lft Lft casing	I	Wood	Gray	>9.9	QM
103	A	Door	Ctr Lft casing	F	Wood	Gray	8.9	QM
102	A	Door	Ctr L Ctr	F	Wood	Gray	>9.9	QM
107	A	Trim	Lft	I	Wood	Gray	>9.9	QM
095	C	Wall	U Lft	F	Stucco	White	0.0	QM
099	C	Door	Ctr Rgt casing	I	Wood	Gray	0.0	QM
098	C	Door	Ctr L Ctr	P	Wood	Gray	-0.2	QM
097	C	Door	Lft U Lft	P	Wood	Gray	6.6	QM
096	C	D Spout.	Lft	F	Metal	White	-0.1	QM
101	D	Wall	L Ctr	I	Stucco	White	0.0	QM
100	D	Post	Ctr	P	Metal	Gray	>9.9	QM

DETAILED REPORT OF LEAD PAINT INSPECTION FOR: SMMUSD

Inspection Date: 12/18/06
 Report Date: 12/27/2006
 Abatement Level: 0.8
 Report No. 12/18/06 10:11
 Total Readings: 178
 Job Started: 12/18/06 10:11
 Job Finished: 12/18/06 13:19
 Conducted by: Victor Sanchez
 Certification number: 10148
 CTL job number: 106-0531
 Grant Elementary School

Exterior Room 009 Bldg 11-13

112	A	Wall	L Ctr		I	Stucco	White	0.3	QM
118	A	Wall	L Ctr		I	Stucco	White	0.1	QM
117	A	Fascia			F	Wood	White	5.7	QM
113	A	Window	Rgt	Rgt casing	P	Wood	Gray	5.2	QM
114	A	Window	Rgt	Sash	P	Wood	Gray	5.5	QM
116	A	Railing	Ctr	Railing	P	Metal	White	7.7	QM
115	A	Ceiling	Ctr		P	Wood	White	3.7	QM
111	C	Window	Ctr	Rgt casing	I	Wood	Gray	4.0	QM
110	C	Window	Ctr	Sash	I	Wood	Gray	6.5	QM
109	C	Door	Ctr	Lft casing	F	Wood	Gray	1.6	QM
108	C	Door	Ctr	U Ctr	I	Wood	Gray	-0.2	QM

Exterior Room 010 Bldg 2-5

119	C	Wall	L Ctr		I	Stucco	White	0.2	QM
121	C	Gutter			I	Metal	Gray	0.0	QM
122	C	Door	Ctr	Rgt casing	F	Wood	Gray	2.0	QM
123	C	Door	Ctr	U Ctr	I	Wood	Gray	0.0	QM
120	C	Post	Ctr		F	Metal	Gray	1.6	QM
124	C	Vent	Rgt		I	Metal	White	-0.2	QM
129	A	Wall	L Rgt		I	Stucco	White	0.0	QM
126	A	Window	Lft	Sash	F	Metal	Gray	0.3	QM
125	A	Window	Lft	Lft casing	F	Metal	Gray	0.2	QM
127	A	Window	Ctr	Sill	P	Wood	Gray	3.9	QM
128	A	D Spout.	Ctr		F	Metal	White	1.7	QM
130	A	Flashing	Rgt		I	Metal	Gray	0.3	QM
131	B	Wall	L Ctr		I	Concrete	Mosaic	0.1	QM

Exterior Room 011 Bldg 26-31

144	B	Wall	L Ctr		I	Stucco	White	0.1	QM
138	B	Door	Lft	Lft casing	I	Wood	Gray	9.2	QM
137	B	Door	Lft	U Lft	I	Wood	Gray	9.0	QM
142	B	Ceiling	Ctr		F	Wood	White	6.8	QM
143	B	Beam	Ctr		F	Wood	White	5.8	QM
134	C	Wall	L Ctr		I	Stucco	White	0.2	QM
139	C	Wall	L Rgt		I	Stucco	White	0.2	QM
133	C	Door	Ctr	Rgt casing	I	Metal	Gray	0.1	QM
132	C	Door	Ctr	U Ctr	I	Metal	Gray	0.0	QM
136	C	D Spout.	Ctr		F	Metal	White	4.4	QM
135	D	Wall	L Ctr		I	Stucco	White	0.2	QM
140	D	Post	Lft		F	Metal	Gray	0.8	QM
141	D	Pipe	Rgt		F	Metal	Gray	0.1	QM

DETAILED REPORT OF LEAD PAINT INSPECTION FOR: SMMUSD

Inspection Date: 12/18/06
 Report Date: 12/27/2006
 Abatement Level: 0.8
 Report No. 12/18/06 10:11
 Total Readings: 178
 Job Started: 12/18/06 10:11
 Job Finished: 12/18/06 13:19
 Conducted by: Victor Sanchez
 Certification number: 10148
 CTL job number: 106-0531
 Grant Elementary School

Exterior Room 012 Sanitary Bldg/Playground (S/W)

147	A	Wall	L Lft	I	Stucco	White	0.5	QM
150	A	Wall	L Rgt	I	Brick	Green	0.1	QM
146	A	Door	Ctr Rgt casing	I	Metal	Gray	0.0	QM
145	A	Door	Ctr U Ctr	I	Metal	Gray	0.0	QM
148	A	Handrail	Rgt	P	Metal	Gray	0.2	QM
149	D	Flashing	Ctr	I	Metal	Gray	0.0	QM

Exterior Room 013 Portable 75

158	A	Skirt board		I	Wood	Gray	0.0	QM
157	A	Fascia		I	Metal	Gray	-0.4	QM
151	B	Wall	L Ctr	I	Wood	White	-0.1	QM
154	B	Door	Rgt Rgt casing	F	Metal	Gray	-0.2	QM
153	B	Door	Rgt U Rgt	F	Metal	Gray	-0.1	QM
152	B	Column	Lft	F	Metal	Gray	0.0	QM
155	B	Handrail	Rgt	F	Metal	Gray	0.0	QM
156	B	D Spout.	Rgt	I	Metal	Gray	-0.1	QM

Exterior Room 014 Portable 74

161	A	D Spout.	Lft	I	Metal	Gray	-0.1	QM
159	C	Wall	L Ctr	I	Wood	White	-0.3	QM
160	C	Flashing	Ctr	I	Metal	Gray	0.0	QM

Exterior Room 015 Portable 73

163	B	Door	Lft Lft casing	I	Metal	Gray	-0.1	QM
162	B	Door	Lft U Lft	I	Metal	Gray	0.0	QM
164	B	Ceiling	Lft	I	Wood	Gray	-0.1	QM

Exterior Room 016 Portable 72

168	A	Wall	U Lft	I	Wood	White	-0.2	QM
166	B	Skirt board		I	Wood	White	-0.2	QM
165	B	Window	Ctr Rgt casing	I	Wood	White	-0.2	QM
167	B	Handrail	Rgt	P	Metal	Gray	0.0	QM

Exterior Room 017 Portable 71

170	B	Window	Ctr Rgt casing	I	Wood	Gray	0.0	QM
172	B	Door	Rgt Rgt casing	I	Metal	Gray	0.0	QM
171	B	Door	Rgt U Rgt	I	Metal	Gray	0.0	QM
169	B	Ramp	Ctr	P	Wood	Gray	-0.1	QM

Exterior Room 018 Portable 70

173	A	Wall	L Lft	I	Wood	Gray	0.2	QM
175	A	Skirt board		I	Metal	Gray	0.1	QM
174	A	Flashing	Ctr	I	Metal	Gray	-0.1	QM

DETAILED REPORT OF LEAD PAINT INSPECTION FOR: SMMUSD

Inspection Date: 12/18/06
Report Date: 12/27/2006
Abatement Level: 0.8
Report No. 12/18/06 10:11
Total Readings: 178
Job Started: 12/18/06 10:11
Job Finished: 12/18/06 13:19
Conducted by: Victor Sanchez
Certification number: 10148
CTL job number: 106-0531
Grant Elementary School

Calibration Readings

001	1.1	TC
002	1.0	TC
003	1.0	TC
176	1.1	TC
177	1.0	TC
178	1.0	TC

----- End of Readings -----

Calibration Check Test Results

Page 1 of 1

Address/Unit No. Grant E.S. (SMMUSD)

Device RMD.

Date 12-18-06

XRF Serial No. 1184
2026

Contractor CTL

Inspector Name VICTOR Sanchez

Signature [Signature]

NIST SRM Used 1.04 mg/cm2

Calibration Check Tolerance Used ±.3 mg/cm2

First Calibration Check

NIST SRM			First Average	Difference Between first Average and NIST SRM*
First Reading	Second reading	Third reading	1.03	0.01
1.1	1.0	1.0		

Second Calibration Check

NIST SRM			First Average	Difference Between first Average and NIST SRM*
First Reading	Second reading	Third reading	1.03	0.01
1.1	1.0	1.0		

Third Calibration Check (if required)

NIST SRM			First Average	Difference Between first Average and NIST SRM*
First Reading	Second reading	Third reading		

Fourth Calibration Check (not required)

NIST SRM			First Average	Difference Between first Average and NIST SRM*
First Reading	Second reading	Third reading		

* if the difference of the Calibration Check Average from the NIST SRM film value is greater than the specified Calibration Check Tolerance for this device, consult the manufacturer's recommendations to bring the instrument back into control. Retest all testing combinations tested since the last successful Calibration Check test.

LEAD HAZARD EVALUATION REPORT

Section 1—Date of Lead Hazard Evaluation 12-18-06

Section 2—Type of Lead Hazard Evaluation (Check one box only)

☒ Lead inspection ☐ Risk assessment ☐ Clearance inspection ☐ Other (specify) _____

Section 3—Structure Where Lead Hazard Evaluation Was Conducted

Address (number, street, apartment (if applicable)) <u>2368 Pearl St.</u>	City <u>Santa Monica</u>	County <u>LA</u>	ZIP code
Construction date (year) of structure	Type of structure (check one box only) <input type="checkbox"/> Single family dwelling <input type="checkbox"/> Multi-unit building <input type="checkbox"/> Child-occupied facility <input type="checkbox"/> Other (specify) _____		

Section 4—Owner of Structure (If business/agency, list contact person)

Name <u>Santa Monica Harbor U.S.D.</u>	Telephone number <u>(310) 4508338</u>		
Address (number, street, apartment (if applicable)) <u>1651 16th St.</u>	City <u>Santa Monica</u>	State <u>CA</u>	ZIP code <u>90404</u>

Section 5—Results of Lead Hazard Evaluation (Check one box only)

☐ No lead-based paint detected.

A lead inspection was conducted following the procedures outlined in Title 17, California Code of Regulations, Division 1, Chapter 8. No lead-based paint was detected during this lead inspection. This structure is found to be lead-based paint free.

☐ No lead hazards detected.

Lead hazard evaluation was conducted following the procedures outlined in Title 17, California Code of Regulations, Division 1, Chapter 8. No lead hazards were detected.

☒ Lead-based paint and/or lead hazards detected.

Lead hazard evaluation was conducted following the procedures outlined in Title 17, California Code of Regulations, Division 1, Chapter 8. Lead-based paint and/or lead hazards were detected.

Section 6—Individual Conducting Lead Hazard Evaluation

Name <u>Victor Sanchez</u>	Telephone number <u>(310) 530-5006</u>		
Address (number, street, apartment (if applicable)) <u>24404 S. Vermont Avenue, Suite 307</u>	City <u>Harbor City</u>	State <u>CA</u>	ZIP code <u>90710</u>
Brand name and serial number of any portable x-ray fluorescence (XRF) instrument used (if applicable) <u>RND 1184</u>			

DHS certification number <u>10-148</u>	Signature 	Date <u>12-18-06</u>
---	--	-------------------------

Section 7—Attachments

- A foundation diagram or sketch of the structure indicating the specific locations of each lead hazard or presence of lead-based paint;
- Each testing method, device, and sampling procedure used;
- All data collected, including quality control data, laboratory results, including laboratory name, address, and phone number.

First copy and attachments retained by inspector

Second copy and attachments retained by owner

Third copy only (no attachments) mailed to:
Department of Health Services
Childhood Lead Poisoning Prevention Branch
Reports
1515 Clay Street, No. 1801
Oakland, CA 94612
FAX (510) 622-5002

APPENDIX D

SAMPLE LOCATION MAP

GRANT ELEMENTARY SCHOOL

2006-2007

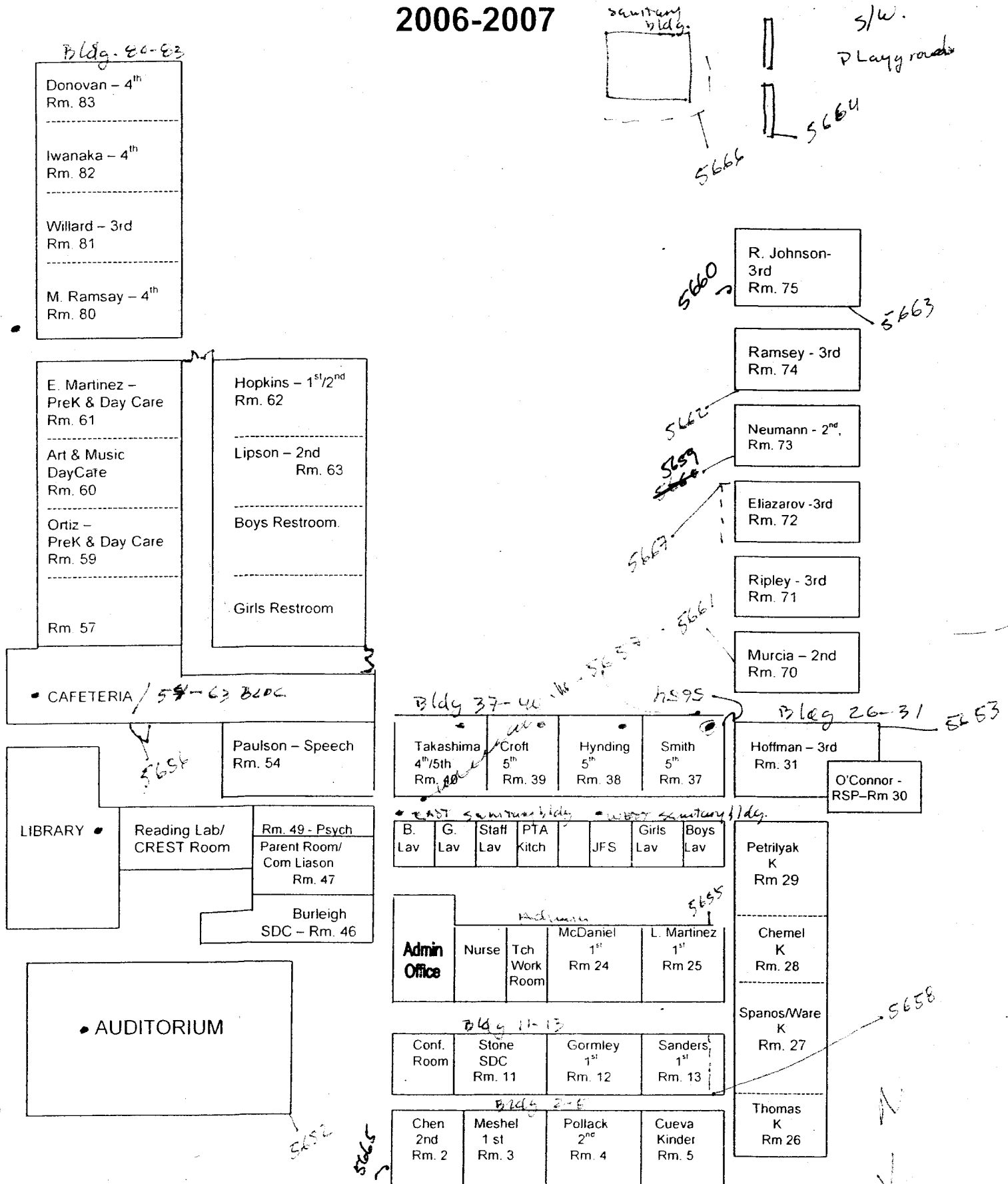

Note: Map not to scale

APPENDIX E

CTL EMPLOYEE CERTIFICATIONS

State of California Department of Health Services

Lead-Related
Construction

Certificate

Certificate

Type

Expiration

Date

Inspector/Assessor 11/09/2007

Supervisor 11/09/2007

Project Monitor 11/09/2007



Victor M. Sanchez

ID #: 10148