

**LEAD ABATEMENT  
PROJECT RECORD**

**Juan Cabrillo Elementary School  
30237 Morningview Drive  
Malibu, California 90265**

Prepared for:

**Santa Monica - Malibu Unified School District  
1651 16th Street  
Santa Monica, California 90404**

Prepared by:

**CTL Environmental Services  
24404 South Vermont Avenue, Suite 307  
Harbor City, California 90710  
(310) 530-5006**

---

January 24, 2007  
CTL Project No. 106-0537

## **TABLE OF CONTENTS**

- I. SUMMARY REPORT**
- II. DAILY FIELD REPORTS**
- III. CTL EMPLOYEE CERTIFICATIONS**

**I**

**SUMMARY REPORT**



# CTL Environmental Services

24404 South Vermont Avenue, Suite 307 • Harbor City, CA 90710 • TEL: (310) 530-5006 • FAX: (310) 530-0792

**REPORTED:** January 24, 2007 **CTL PROJECT NO.:** 106-0537

**CLIENT:** Santa Monica - Malibu Unified School District  
1651 16th Street  
Santa Monica, California 90404

**ATTENTION:** Mr. Wally Barriman

**RE:** **Lead Monitoring and Contractor Observation**  
**Juan Cabrillo Elementary School – exteriors**  
**30237 Morningview Drive**  
**Malibu, California 90265**

## INTRODUCTION

CTL Environmental Services (CTL) conducted monitoring and contractor observation during the lead based paint related work activities from Juan Cabrillo Elementary School. The monitoring was conducted on January 4<sup>th</sup>, 2007 by James Choe, DHS Certified Lead Project Monitor employed by CTL.

Fix Painting located in Woodland Hills, California, conducted lead-based paint related activities. The contractor’s work force was supervised by Andres Loizu, Project Foreman.

A CTL representative was present at the beginning of this project to insure that the contractor’s work crew and removal methods were consistent with those workers and methods established at Roosevelt Elementary School and Will Rogers Elementary Schools, which were completed by Fix Painting under the same contract.

## SCOPE OF WORK

The scope of work included the stabilization of damaged loose and flaky lead-based paint on components identified on CTL’s Report #106-0310 dated August 14, 2006 as mentioned in the table below:

COMPONENT	SUBSTRATE / COLOR	LOCATION
Ceilings	Wood / White	All exterior walkways
Post, beam, handrails	Metal / Blue-white-green	All exterior walkways
Ceiling	Stucco / White	All exterior walkways

At project completion, Fix Painting cleaned the area, wet wiped, and HEPA vacuumed as necessary.

## **CONTRACTOR OBSERVATION**

CTL performed contractor observation and was able to document that the work methods were consistent with those methods completed at Roosevelt and Will Rogers Elementary Schools. The work methods included but were not limited to the following:

- Fix Painting, generally conformed to all binding federal, state, and local regulations.
- Engineering controls included but were not limited to drop cloths, barrier tape, and HEPA equipped vacuum cleaners.
- Protective equipment included full-body disposable clothing; foot protection, gloves, eye goggles, and NIOSH approved half-face, air-purifying respirators, equipped with HEPA P100 filters.

## **RESULTS**

Prior to releasing each work area, it was visually inspected for evidence of residual lead-based paint debris. No debris was observed.

All wipe sample results collected on these projects were below the established California Department of Health Services clearance level of 800 parts per million for exterior floors.

## **RECOMMENDATIONS**

All construction work where an employee may be occupationally exposed to lead must comply with Cal-OSHA requirements set forth in 8 CCR 1532.1. This regulation requires initial employee exposure monitoring to evaluate worker exposure during work, which disturbs lead in paint in any detectable levels. If airborne lead levels are above the established OSHA Permissible Exposure Limits (PEL), additional monitoring and respiratory protection may be required as well as engineering controls such as containments and personal protective clothing.

CTL suggests that engineering controls, respiratory protection and personal protective equipment be employed at the start of a project, which may disturb lead-based paint. Engineering controls should be continued until it can be proven that airborne lead levels are below the OSHA levels. It is further recommended that a qualified environmental consultant be utilized to design, coordinate, and manage lead and asbestos work activities.

## ASSUMPTIONS AND LIMITATIONS

This report has been prepared for the exclusive use of Santa Monica - Malibu Unified School District. In performing our professional services, we have applied present engineering and scientific judgment and used a level of effort consistent with the standard of practice measured on the date of work in the locale of the project site for similar type studies.

CTL has relied in good faith upon representations and information furnished by individuals with respect to operations and existing property conditions to the extent that they have not been contradicted by data obtained from other sources. Accordingly, CTL accepts no responsibility for any deficiencies, omissions, misrepresentations, or fraudulent acts of persons interviewed. In addition, CTL will not accept liability for any loss, injury, claim, or damage arising directly or indirectly from any use or reliance on this report. CTL makes no warranty, expressed or implied.

If you have any questions, please do not hesitate to contact the undersigned at (310) 530-5006.

Prepared by,  
**CTL Environmental Services**

Cesar Ruvalcaba  
Project Manager, Hazardous Materials Division  
Certified Inspector/Assessor  
DHS Cert #I-6855

CR/lb

Attachments

Reviewed by,



Marie Tullai, CIH  
Director, Hazardous Materials Division  
Certified Inspector/Assessor  
DHS Cert #I-11088

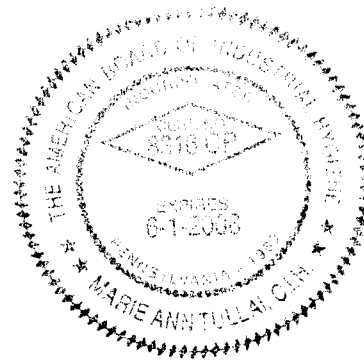

**II**

**DAILY FIELD REPORTS**



PROJECT LOG/DAILY WORK AREA INSPECTION CHECKLIST

Date: 1/4/07 CTL Representative: James Chase
Project No. 106-0537 Project Name: Juan Cabrillo Elementary School
Project Location 30237 Morning View Dr. Project Area: Bldgs & walkways
Material Removed: Paint stabilization Quantity Removed: N/A

Type of Containment:
full-3 stage decon/walls/ceiling/shower
splash-3 stage decon-shower
mini-2 stage decon-shower
glovebag/secondary containment
other (describe) barrier tape & signs

Respiratory Protection Used:
1/2 face-P100
1/2 face-P100/Organic
Full face-P100
PAPR-HEPA

Arrival Time (CTL): 0700 Hr
Departure Time (CTL): 1000 Hr

Abatement Contractor: Fix Painting
Contractor Supervisor's Name: Anderson
Contractor Arrival: 0820 Contractor Departure Time: after CTL

# of Workers Present: 7
Worker certifications current/available on site: DHS Cards
Reviewed by CTL

Contractor's job board present including Cal-OSHA notification and AQMD if applicable: Yes

Other contractor's on site/Activities:

Daily Work Area Inspection (Check 4 times/shift)

Table with columns: Decontamination Unit, Time of Inspection, QA, Pressure Differential Isolation Barriers, Time of Inspection, QA. Rows include: Proper signs at entrance and bag-out, Airlock flaps intact, Street clothing properly stored, Suits/respirator filters present, Area clean: waste bags not obstructing path, Shower/pump/filters operating properly, Proper # of AFD's for area, Containment smoke tested, AFD's properly vented, Pre-filter clean, Exhaust tubing intact, Critical barriers intact.

Work Practices:
No saws/brooms in work area
Material kept wet
Material promptly bagged
Workers in proper PPE:
No cut off sleeves of suit, no cut off feet of suit, eye protection used, gloves used, hood up, respirator straps inside hood
No eating, smoking, drinking in work area

Waste Disposal:
Waste/debris bagged
Waste double bagged, sealed, decontaminated, labeled prior top removal
Dumpster lined, labeled
Dumpster closed top/locked
Type of manifest (HAZ/FRIABLE) (NON-FRIABLE)
# of bags Manifest #

Was not on site to observed the debris storage.



**PROJECT LOG/DAILY INSPECTION CHECKLIST**

Date: 1/4/07 CTL Representative: James Choi  
 Project No. 106-0537 Project Name: Juan Cabrillo Elementary School  
 Project Location: 30237 Morning View Dr Project Area: Bldgs & walkway S/

**Air Sampling Protocol**

Location	Type of pump	Recommended Flow rate: Requirement (use calibrated rotometer/record #)	Regulatory
Inside work area	low volume*	1-2 lpm (recommended)	0.5-2.5 lpm (personals)
Critical barriers	high volume	8-10 lpm (recommended)	No higher than 16 lpm**
Decontamination facility	high volume	8-10 lpm (recommended)	No higher than 16 lpm**
Neg. air exhaust stream	high or low volume*	8-10 or 1-2 lpm (recommended)	No higher than 16 lpm**
Floor above/below	high volume	8-10 lpm (recommended)	No higher than 16 lpm**
Occupied areas	high or low volume	8-10 or 1-2 lpm (recommended)	No higher than 16 lpm**
Waste load out route	low volume	1-2 lpm (recommended)	0.5-2.5 lpm (personals)
Dumpster	low volume	1-2 lpm (recommended)	0.5-2.5 lpm (personals)

*\*If neg. air exhaust stream cannot be monitored with a high volume pump, use low volume pump. Do not place high volume pump inside work area until final visual inspection is complete and approved. \*\*AHERA clearances must be conducted at 10 lpm with a min. sample volume of 1200 liters of air. The recommended flow rate may be superseded by specification requirements.*

# Samples collected/shift NA inside work area NA outside work area NA

Pre-abatement visual inspect. Conducted <input checked="" type="checkbox"/>	on-site correspondence complete	<input checked="" type="checkbox"/>
Date/Time <u>1/4/07 0900hr</u>		
Smoke test conducted <input checked="" type="checkbox"/>	on-site correspondence complete	<input checked="" type="checkbox"/>
Date/Time _____		
Fire Dept. inspect. conducted <input checked="" type="checkbox"/>	on-site correspondence complete	<input checked="" type="checkbox"/>
Date/Time _____		
Final visual inspect. conducted <input checked="" type="checkbox"/>	on-site correspondence complete	<input checked="" type="checkbox"/>
Date/Time _____		
Clearance sampling conducted <input checked="" type="checkbox"/>	PCM Results:	<input checked="" type="checkbox"/>
Date/Time _____	_____	
	_____	
	on-site correspondence complete	<input checked="" type="checkbox"/>

Comments: \_\_\_\_\_  
 \_\_\_\_\_  
 \_\_\_\_\_  
 \_\_\_\_\_

CTL Representative: James Choi Date 1/4/07  
 Signature: [Signature]

PROJECT LOG/DAILY INSPECTION CHECKLIST

Date: 1/4/07 CTL Representative: James Choe  
 Project No. 106-0537 Project Name: Juan Cabrillo Elementary School  
 Project Location 30237 Morning View Dr. Project Area: School Bldgs & Walkways

Time of observation	Observations
0700	CTL is on site; Start time is 0800hr.
0800	CTL is standing by
0820	Fix Paint on site
	1. Foreman: Jose Zuniga
	2. Worker: Damian Portillo (waiting for DHS card to be mailed)
	3. Fidencia G. Delgadillo DHS exp 8/26/07 worker # 16363
	4. Jaime Contreras DHS exp 1/19/08 worker # 17040
	5. Ernesto Morales DHS exp 1/25/08 Worker # 17046
	6. Oliverio Arellano DHS exp 6/27/07 worker # 15985
	7. Hermes E. Contreras DHS exp 2/28/07 worker # 15986
	DHS Supervisor <sup>(first)</sup> Andreas <sup>(Last Name?)</sup> is not present due to recent surgery. Foreman Zuniga has no Pb training.
	The crew is the same as the 1st day of project at Will Rogers Elementary School.
0900	Paint stabilization starts Bldg B S side, Flashing & facia of the ceiling walkway. Containment: drop cloth and Pb warning barrier tape. P.P.E.: X face respirator w/ Hepa P100 cartridges, full body disposable suits, and gloves. Hepa vacuum and water sprayer are set. Drop cloth is moved from 1 spot to another and being reused. Upon inquiry to CTL Project Coordinator Lesa Rivalcava concerning BIL & ZPP, respirator fit tests, and medical eval to use respirators, Project Coordinator instructs CTL to allow the work; The above documents are not on site, however maybe included in the faxed Contractor Submittals to CTL office.
0915	Workers move on to walkway "2", same set up as 0900hr.
1000	The crew is conducting own personal air monitoring. Work is progressing Northward direction walkway "2". CTL leaves for another site.

CTL Representative: James Choe Date 1/4/07  
 Signature: [Signature]  
 Cal-OSHA Cert. No. 64-3666

DESCRIPTION: Pre Paint Stabilization Visual Inspection

NAME: Juan Cabrillo Elementary School

NO: 106-0537

DATE: 1/4/07

PAGE 1 OF 1



CTL ENVIRONMENTAL SERVICES  
24404 S. Vermont Avenue, Suite 307  
Harbor City, California 90710  
(310) 530-5006 FAX: (310) 530-0792  
Email: info@ctles.com

Exterior Surfaces Bldgs and walkway  
- currently S side of Bldg B has been set up.

Contractor: Fix Paint

Supervisor: Andrea

CTL Technician: James Choe  
DHS Project Monitor # 16632

At the request of Fix Paint, CTL Environmental Services conducted a visual inspection of the work area described above prior to the stabilization of ~~Pb~~ Pb-based and Pb-containing paint. Isolation is achieved with Pb warning barrier tape, and Pb signs are posted. Polyethylene sheeting drop cloth is set. The procedure may begin.

Work Area Map  
 Juan Cabrillo Elementary School  
 106-0537 1/4/07  
 James Choe

# MAIN PLAYGROUND

LEVY GR3 Rm 24	VOCAL LAMBERT Rm 25
(AT REAR OF PLAYGROUND)	

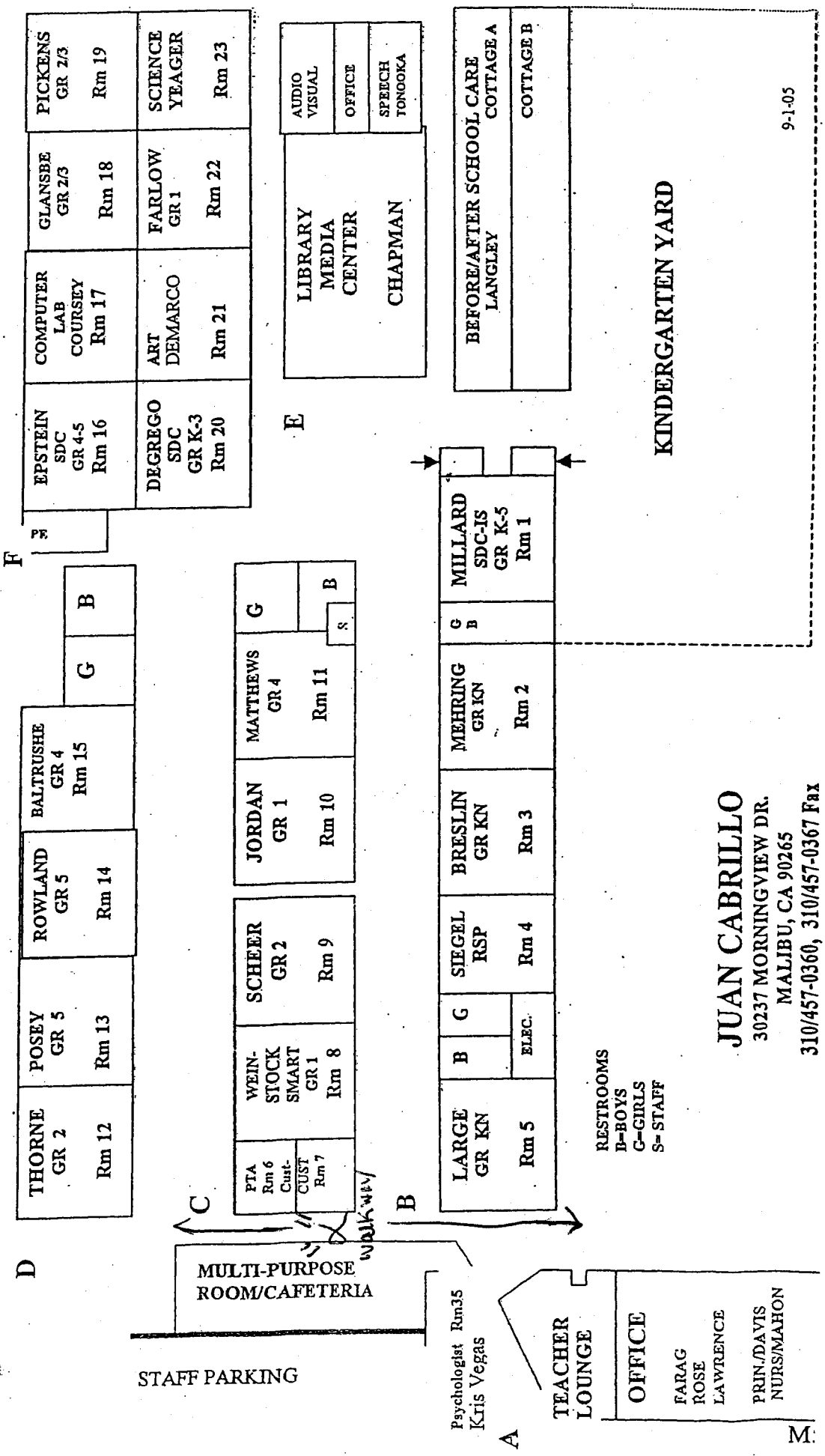

**JUAN CABRILLO**  
 30237 MORNINGVIEW DR.  
 MALIBU, CA 90265  
 310/457-0360, 310/457-0367 Fax

### **III**

## **CTL EMPLOYEE CERTIFICATIONS**

# State of California Department of Health Services

Lead-Related  
Construction  
Certificate

Certificate  
Type

Expiration  
Date

Project Monitor

06/28/2008



James W. Choo

ID # 16632