



Franklin Elementary School

Board Meeting

January 18, 2024



Agenda

- Introduction: Carey Upton
- Principal Statement: Eran Zeevi
- Campus Master Plan Overview: dsk architects
 - Master Plan Process
 - Core Leadership - Workshop Activities & Campus Analysis
 - 2020 & 2021 Master Plan Iterations
 - 2021 April Board Meeting
 - Makerspace & Yard Improvements Project
 - 2022 December Community Meeting
 - 2023 Master Plan Refinement
 - 2023 New Campus Master Plan
 - Proposed Phasing
- Questions

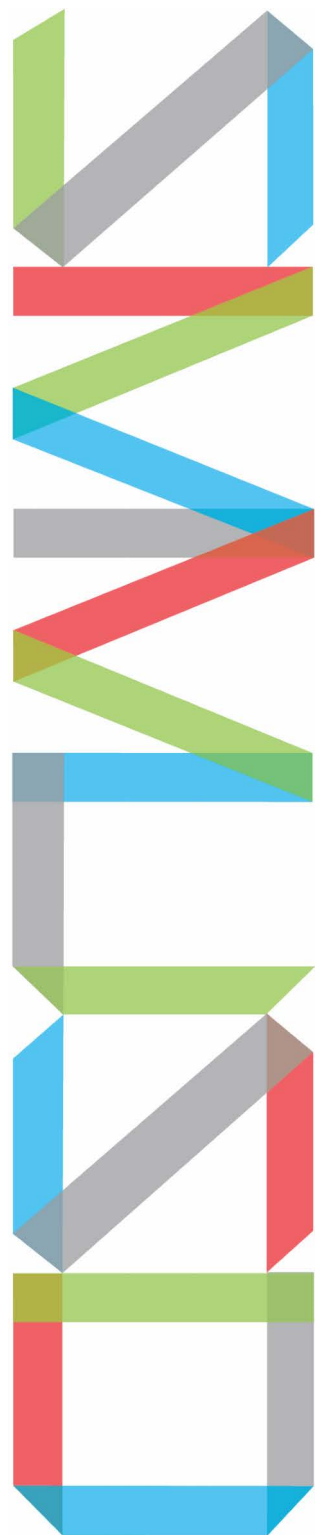

Existing Site

District Ed Specs



Objectives:

- **Establish Future Instructional Delivery** That Aligns to Goals of the SMMUSD LCAP and Excellence Through Equity Initiative
- Provide **21st Century Learning Environments** That Encourage Individual, Small Group and All Class Collaboration That Embraces the Unique Programs at SMMUSD
- **Design Spaces for Students to Function at the Highest Level**
- Enlist Results Driven Approach to Student Success
- **Increase Student Engagement** as Part of a **Project Based Learning Model**
- **Enhance Student and Family Access** to Resources to Increase Student Success
- **Improve Technological Infrastructure** to Support Learning Spaces Designed for 21st Century Skills
- Provide **Safe and Secure Schools** Designed with a **Whole Child Approach** to Learning Aligned with SMMUSD Vision
- Provide **Healthful Learning Environments** Aligned with District **Sustainability** Goals and Designed to Contribute and Improve Student Performance
- Provide a **Road Map** Designed to Align With **Future Facilities Master Planning**

Elementary Model School: Future Planning by Room Type

Campus Capacity	Building & Site Requirements
Capacity	600-700 Students
	Parking
	56 Stalls

	QTY	STUDENT TEACHER RATIO	TOTAL STUDENT COUNT	SF/EACH	TOTAL SF	
Academic Core						
PK	1	1:20	20	1,350	1,350	
T-K	1	1:20	20	1,350	1,350	
Kindergarten	3	1:24	72	1,350	4,050	
1st Grade	4	1:24	96	1,200	4,800	
2nd Grade	4	1:24	96	1,200	4,800	
3rd Grade	4	1:30	120	1,200	4,800	
4th Grade	4	1:30	120	1,200	4,800	
5th Grade	4	1:30	120	1,200	4,800	
Special Education	3	1:8	24	1,200	3,600	
Total	25		688		34,350	
Specialized/Flexible						
Teaming Area	4	--	--	2,200	8,800	1 for Every 6 Classrooms
Block Classrooms - 4	--	--	--	--	--	Use Inventory From Above
Flex Science/Art	2	1:30	--	1,400	2,800	Distributed as Campus Hubs
Maker Lab	2	1:30	--	2,000	4,000	
Multipurpose	1	400	--	5,200	5,200	Including Flex Sports
Cafe/Culinary	1	400	--	8,000	8,000	Including Full Service Kitchen
Flex Music	2	1:30	--	960	1,920	
Library	1	--	--	7,900	7,900	
Total					38,620	

	QTY	STUDENT TEACHER RATIO	TOTAL STUDENT COUNT	SF/EACH	TOTAL SF	
Support						
Administration	1	--	--	4,330	4,330	
Other						
B/G Restrooms	--	--	--	2,200	8,800	1 for Every 6 Classrooms
Staff Restrooms	--	--	--	--	--	Use Inventory From Above
M/E/P Service Rooms	--	1:30	--	1,400	2,800	Distributed as Campus Hubs
MDF	--	1:30	--	2,000	4,000	
Circulation (15%)	--	400	--	5,200	5,200	Including Flex Sports
Total					23,760	
Outdoor Instructional						
Early Childhood Play	--	--	--	75/student	3,000	
Kinder Play	--	--	--	75/student	5,400	
Elementary Play	--	--	--	100/student	57,600	Included, Outdoor Learning
Lunch Shelter	--	--	--	--	1,800	
Outdoor Performance	--	--	--	--	5,200	
Cafe Garden	--	--	--	--	5,000	
Parking	--	--	--	--	58 Stalls	

Master Plan Process - Outreach & Design Meetings



DISTRICT ED SPECS

3+ YEAR REVIEW PROCESS
TEACHER & ED. PLANNER REVIEW

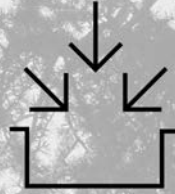

STAKEHOLDER INPUT

TEACHERS, PRINCIPAL, PTA,
M&O, FOOD SERVICES, FACILITIES



DRAFT PLANS

BASED ON INPUT
AND STANDARDS

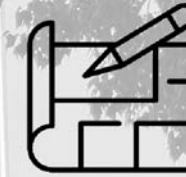

COMMUNITY

DISCUSS WITH BROADER
COMMUNITY



REVISE

BASED ON FEEDBACK
FROM STAKEHOLDER

COMMUNITY MEETINGS

- SPRING COMMUNITY MEETING - JUNE 26, 2020
- FALL COMMUNITY MEETING - OCTOBER 20, 2020
- SPRING COMMUNITY MEETING - MARCH 8, 2022
- CEQA COMMUNITY MEETING - DECEMBER 14, 2022

CORE LEADERSHIP MEETINGS (DISTRICT, SITE ADMIN, TEACHERS & PTA)

- WORKSHOP #1 - APRIL 27, 2020
- WORKSHOP #2 - MAY 12, 2020
- WORKSHOP #3 - MAY 29, 2020
- CORE LEADERSHIP MEETING - SEPTEMBER 16, 2020
- BOARD MEETING - APRIL 29, 2021
 - 2021 MASTER PLAN RECEIVED BOARD APPROVAL
- MAKERSPACE DESIGN MEETINGS
 - JUNE 3, 2021
 - SEPTEMBER 30, 2021
 - APRIL 20, 2022
- STAFF PRESENTATION - SEPTEMBER 6, 2023
- SITE COMMITTEE MEETING - OCTOBER 17, 2023

ADDITIONAL GROUP MEETINGS

- PRINCIPAL MEETINGS
 - FEBRUARY 27, 2020
 - SEPTEMBER 1, 2020
 - AUGUST 5, 2021
 - SEPTEMBER 10, 2021
 - FEBRUARY 3, 2022
 - JUNE 14, 2023
 - AUGUST 8, 2023
- M&O, FOOD SERVICES, & FACILITIES MEETING - APRIL 14, 2020
- PTA MEETINGS
 - FEBRUARY 3, 2021
 - SEPTEMBER 22, 2022
 - SEPTEMBER 7, 2023
- FDAC MEETINGS
 - FEBRUARY 7, 2022
 - FEBRUARY 15, 2022
 - OCTOBER 27, 2022



YOUR PROJECT PRIORITIES:

● CRITICAL ● HIGH ● NORMAL ● LOW

- ### #3 • PERFORMING ARTS SPACE / AUDITORIUM

- DINING AND CULINARY EDUCATION / CAFETERIA ● ●

- #### #4 • PROJECT BASED LEARNING SPACES (LABS, STUDIOS, MAKER SPACES)

- LIBRARY

- FRONT OFFICE / ADMINISTRATION / CAMPUS SUPPORT SPACES

- ## #2 • CLASSROOM IMPROVEMENTS (TEAMING SPACES, BREAK-OUT AREAS, PROGRAMMED OUTDOOR CLASSROOM SPACES)

- **CAMPUS IDENTITY**

- ## #1 • SECURITY (PERIMETER, MAIN ENTRY)

- **GROUNDS AND PLAYGROUNDS**

- OUTDOOR CLASSROOMS ●

- OTHER?

+++ SECURITY, OUTDOOR IMPROVEMENTS
++ PERFORMING ARTS AND MAKER SPACE
+ SUPPORT, DINING, "NUTS AND BOLTS"



NOT EVERY SPACE IS AN "UP" SPACE.
MAKE ROOM FOR CALM, QUIET SPACES
AS WELL.

Core Leadership Meetings - Workshop Activities



Core Leadership Meetings - Campus Analysis

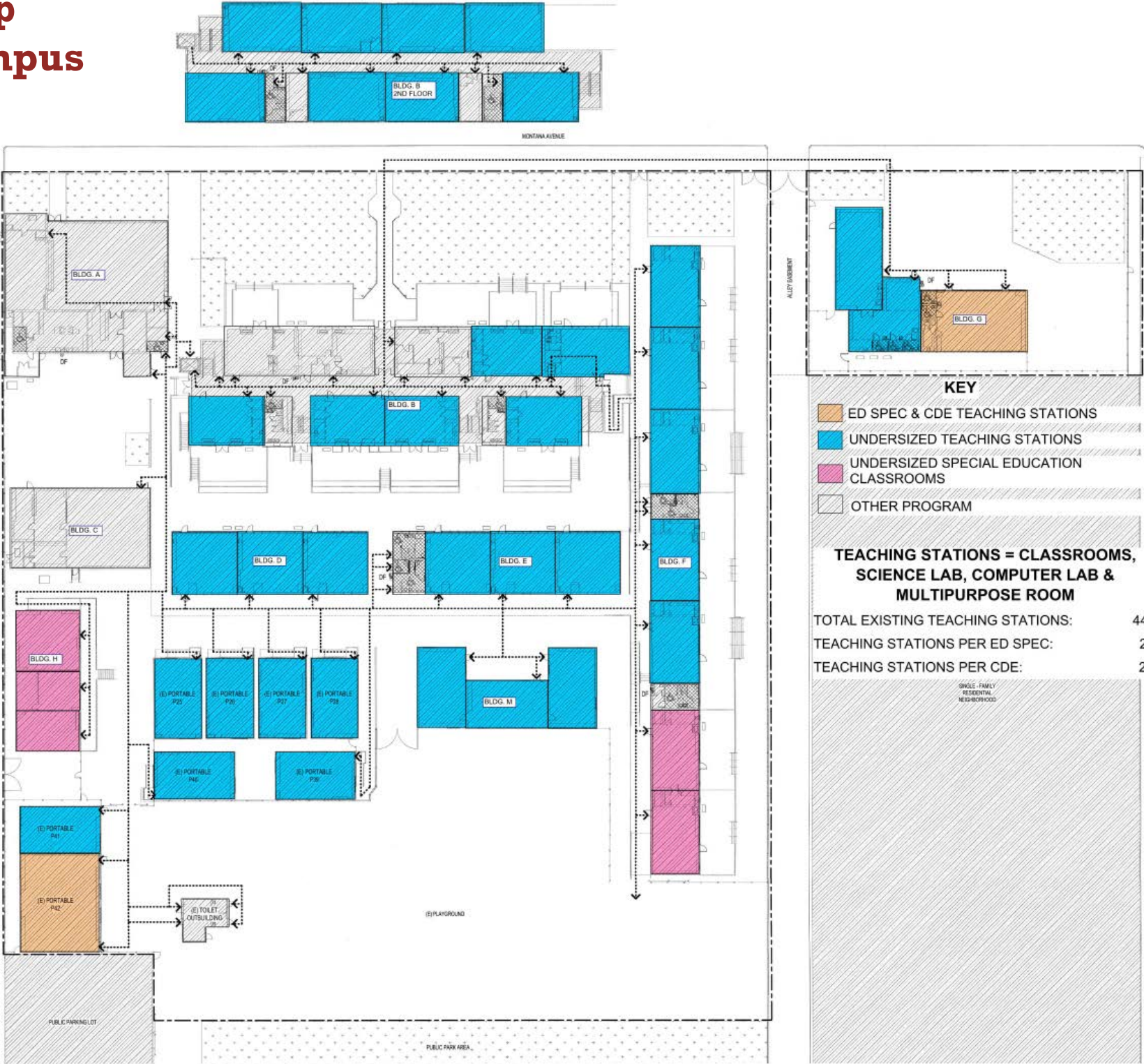

Core Leadership Meetings - Campus Analysis

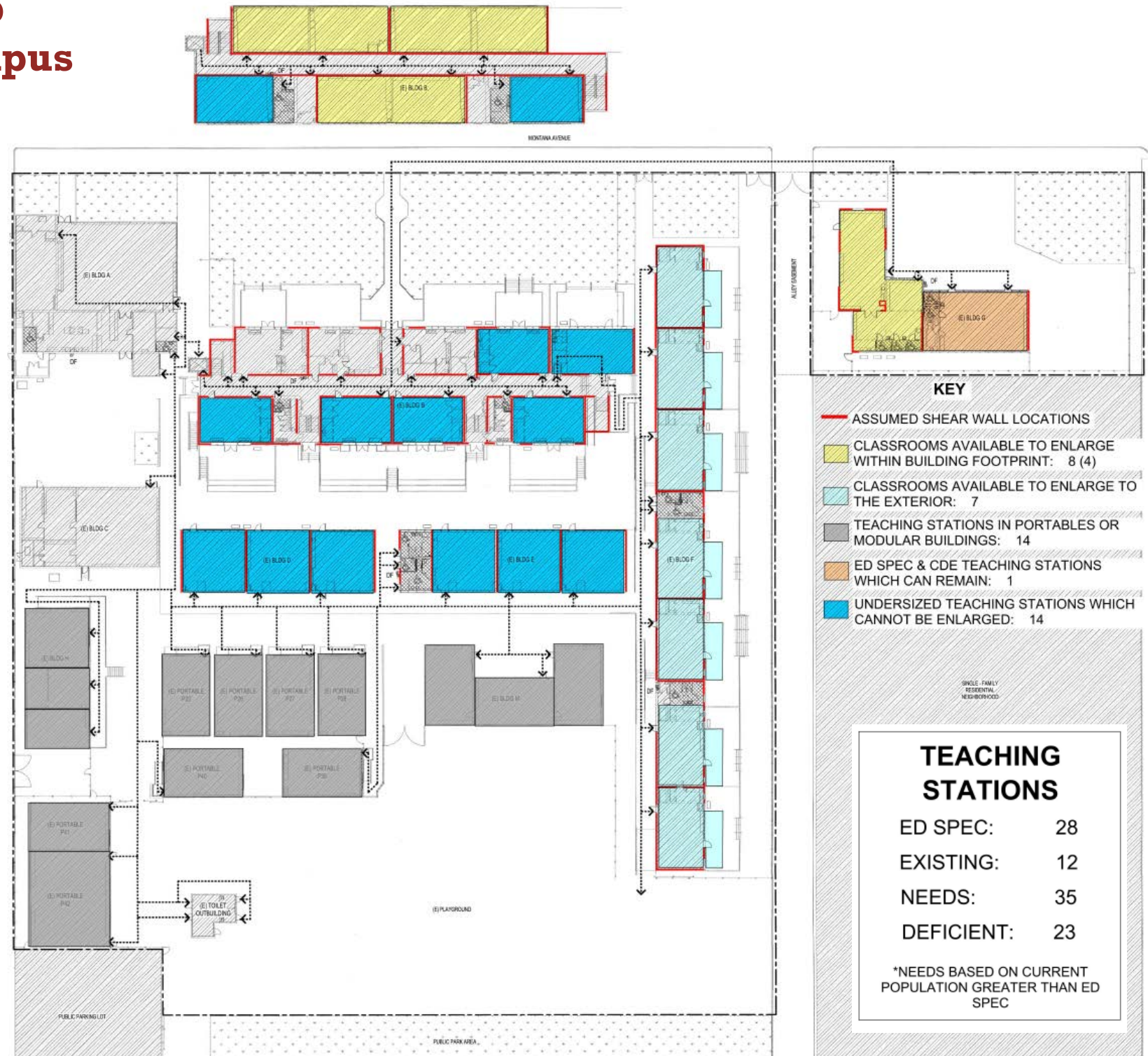

Master Plan Iterations 2020

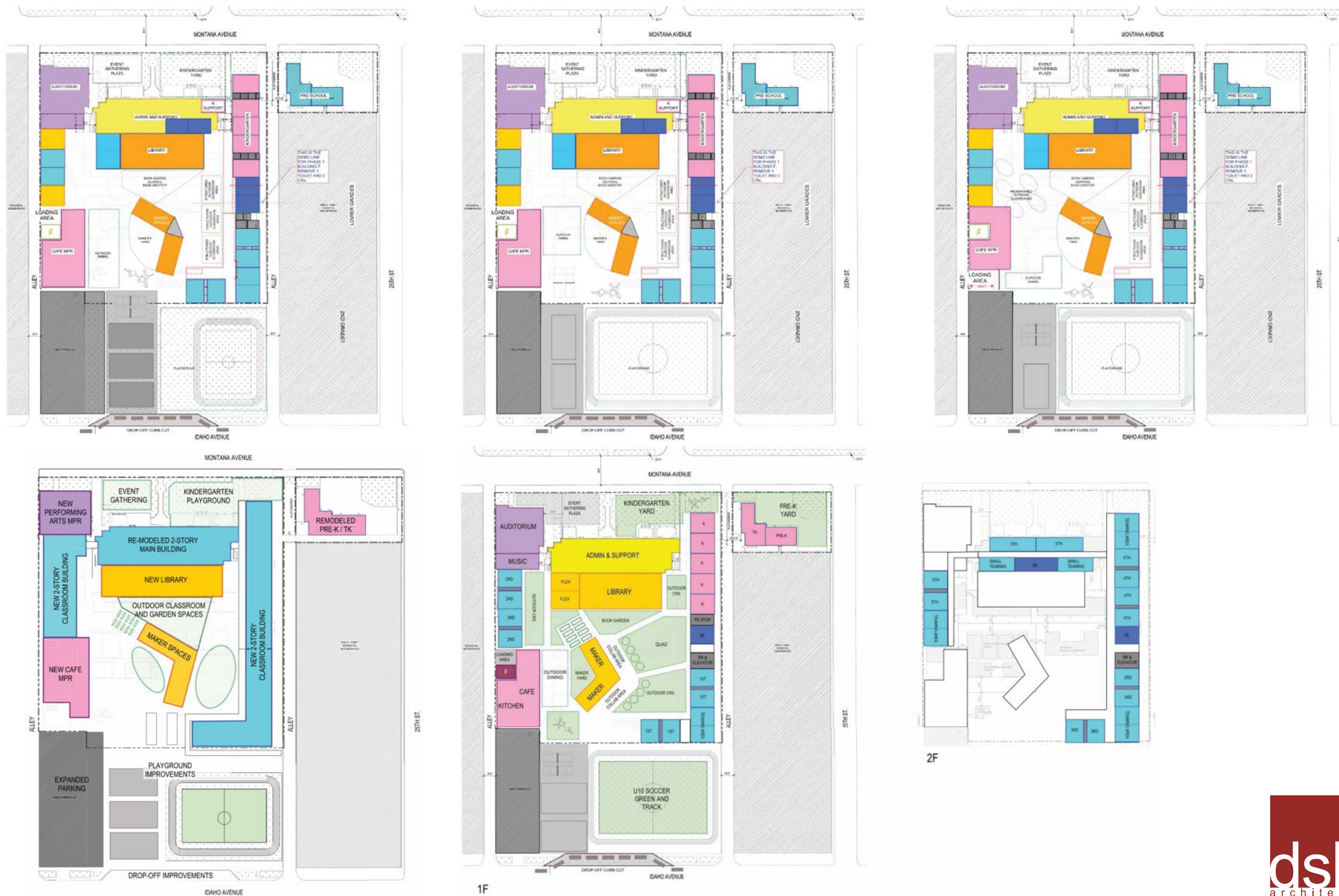

Master Plan Iterations 2021



Master Plan Presented at April 2021 Board Meeting

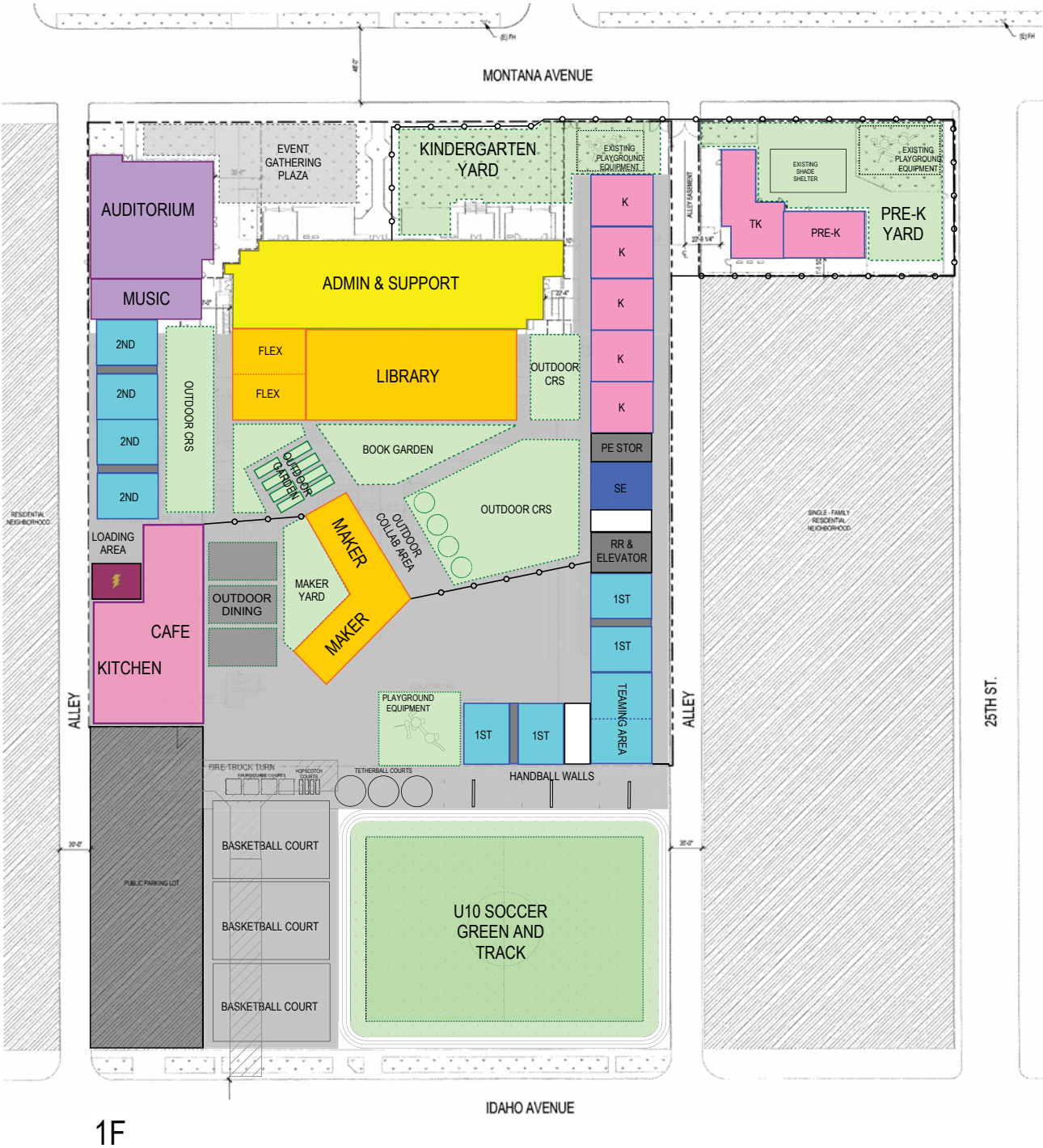

1F

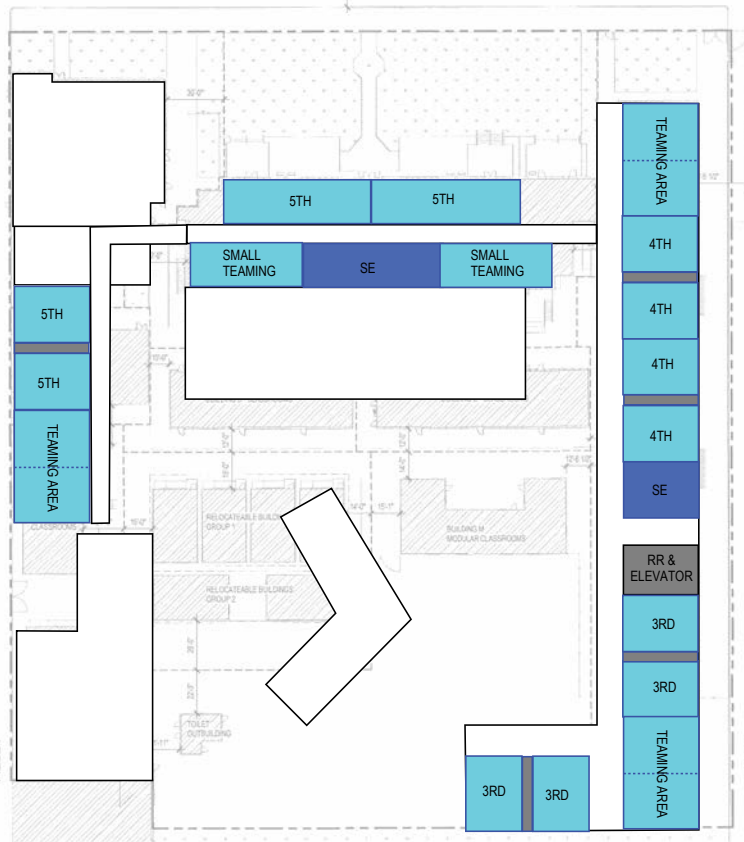

2F

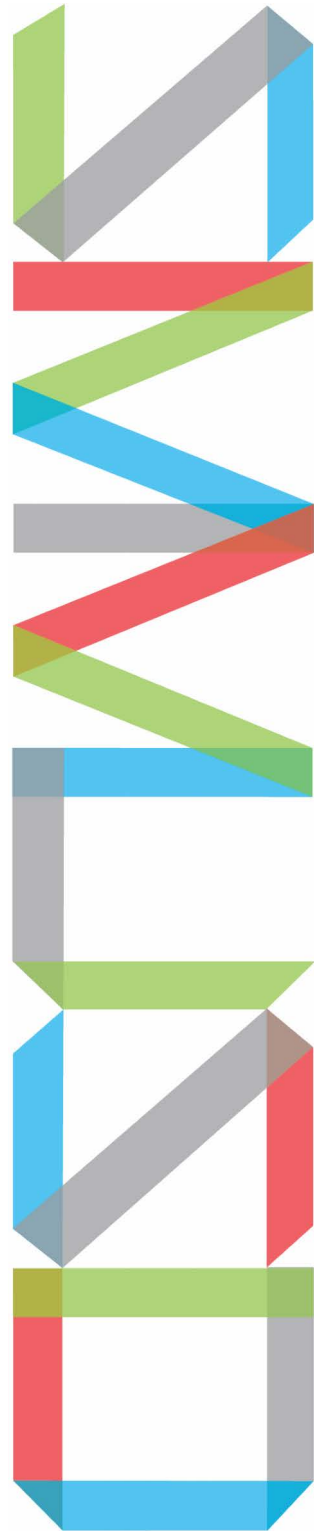

4. Bldg. B Front Lawn Improvements



5. Bldg. B First Floor Renovation



3. New Makerspace Building



6. New Cafe / Dining Building

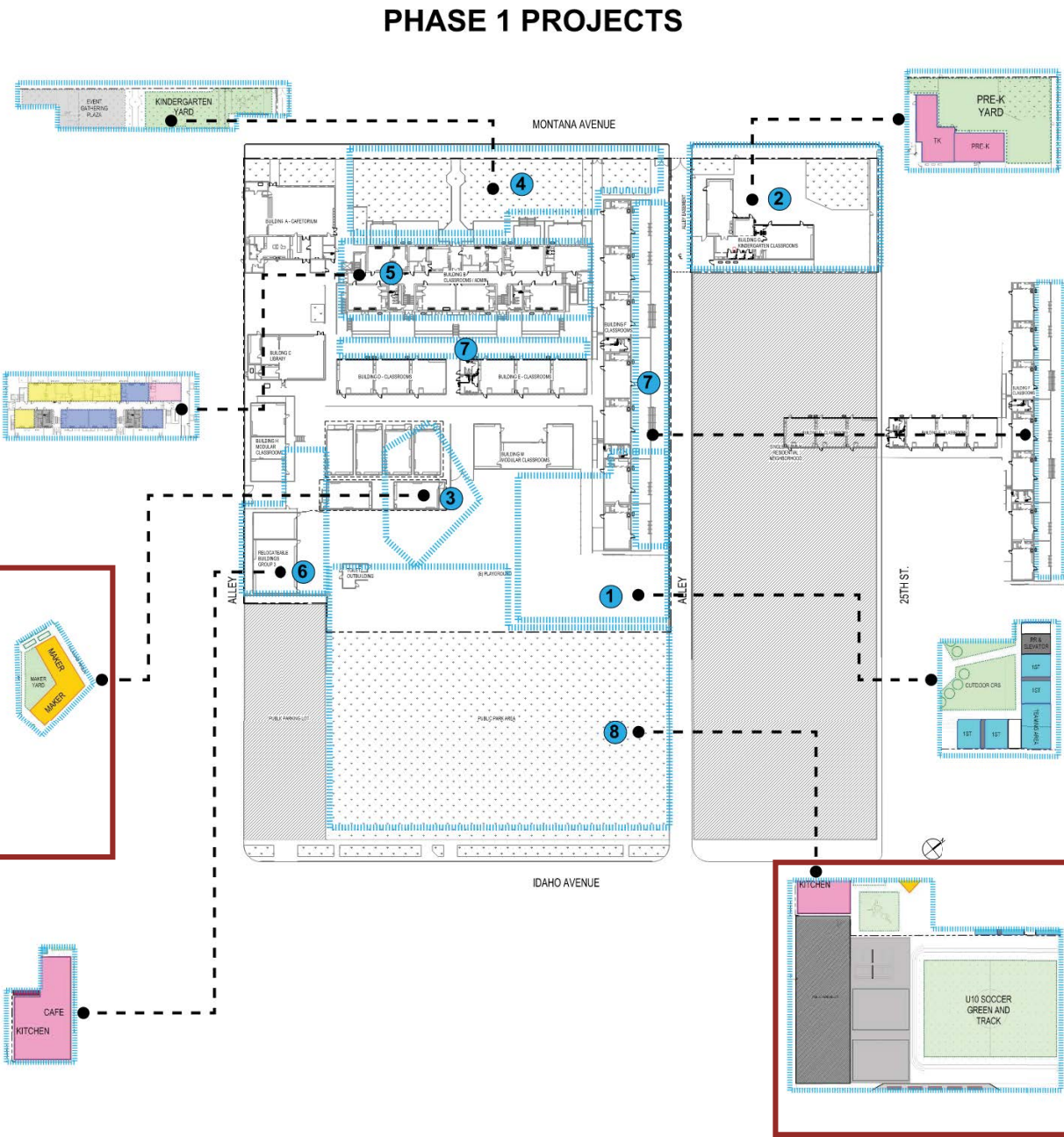

2. PK/TK Satellite Campus Improvements



7. Patio / Outdoor Classroom Improvements



1. New 2-Story Classroom Bldg.



8. Playfield & Yard Improvements

Phase 1 Project: Makerspace & Field Improvements

Makerspace & Field Improvements Project



Received DSA Approval 7/18/23

Makerspace & Field Improvements Project

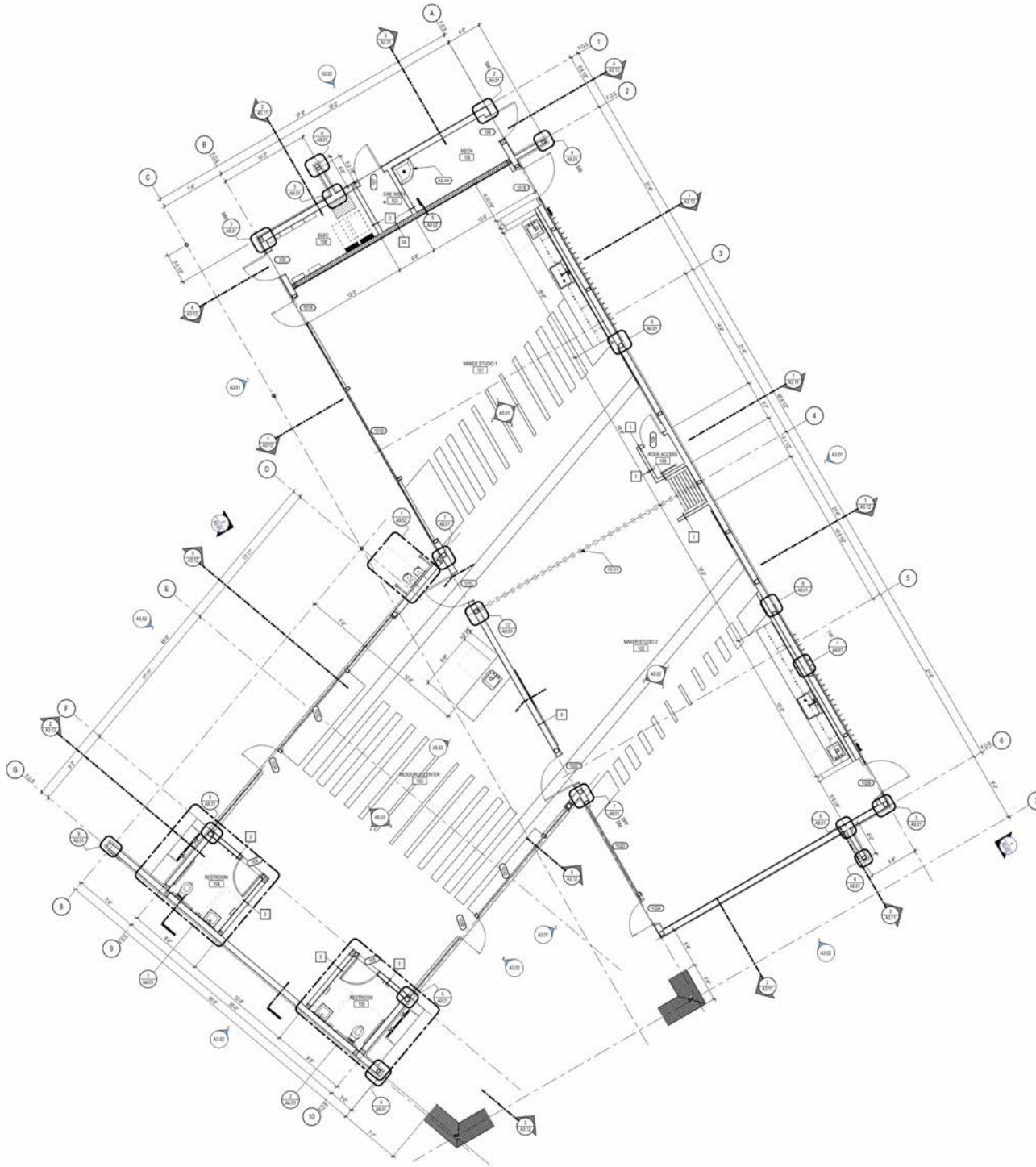

Makerspace & Field Improvements Project

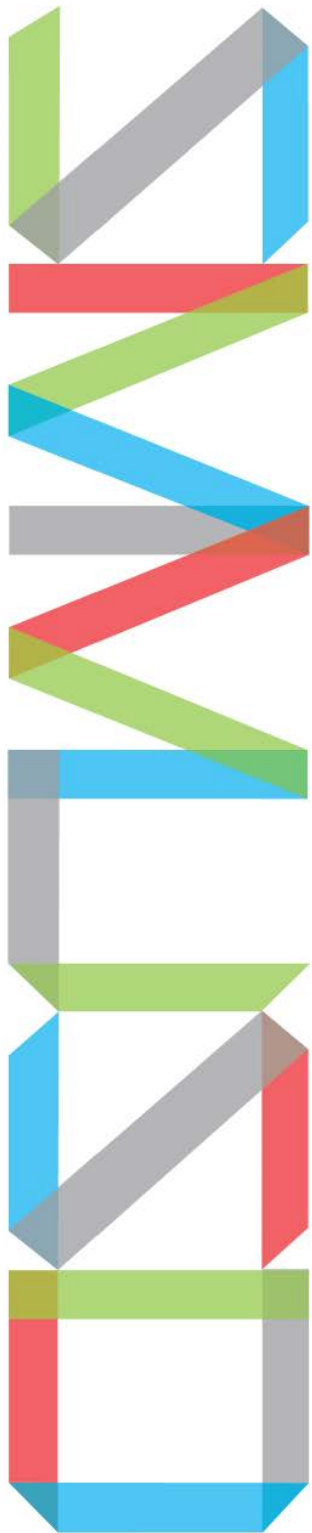

Community Meeting December 2022

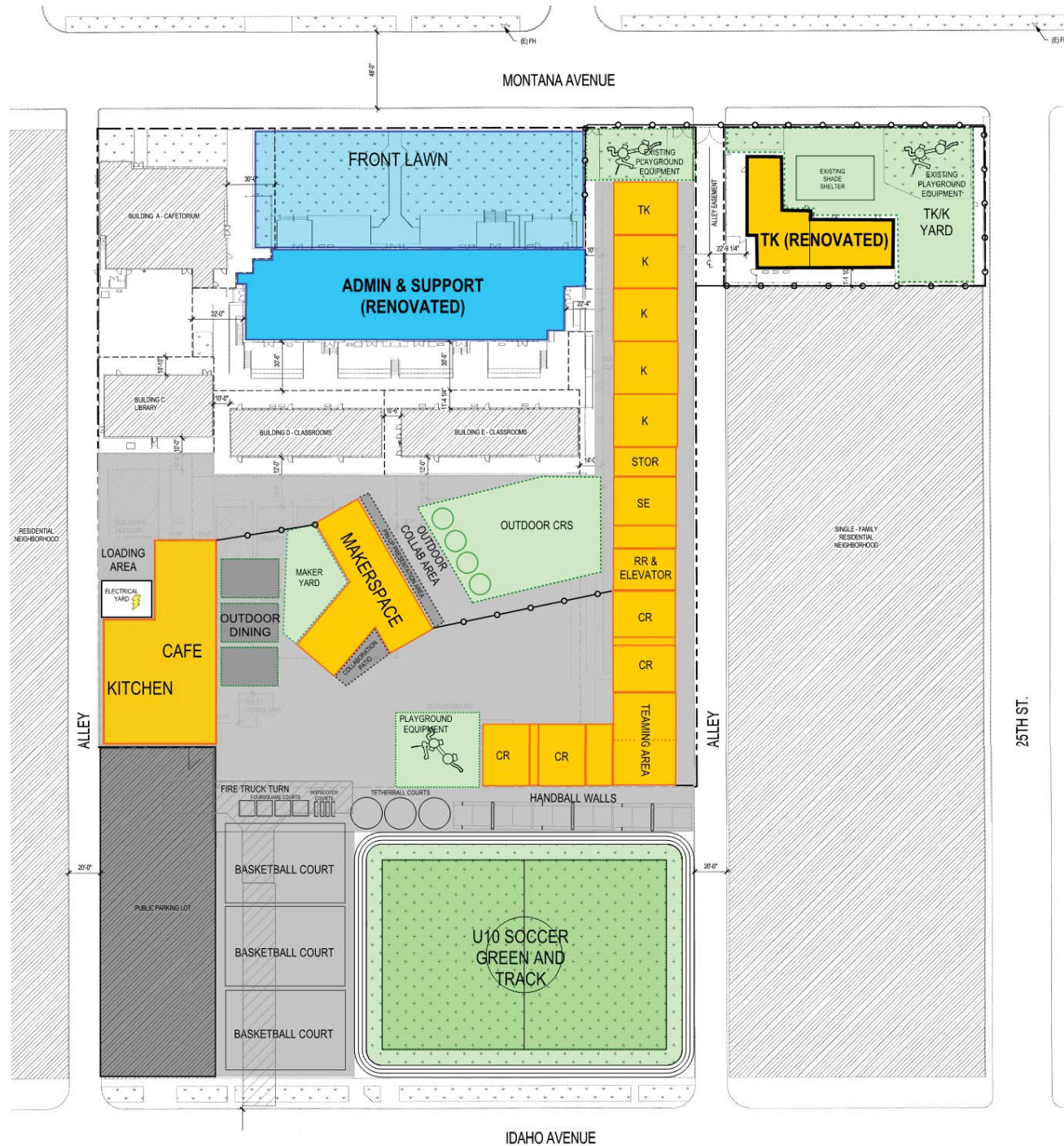

1F

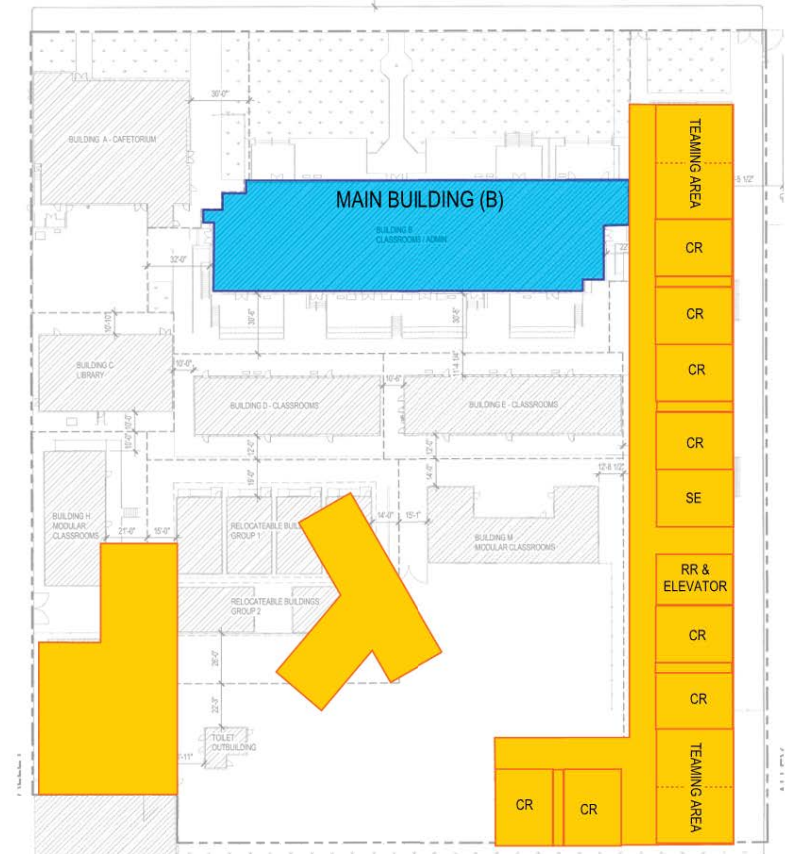

2F

- 2022 Campus Master Plan (revised after 2021 April Board Meeting)
- Determined at the meeting the 2022 Campus Master Plan needed to be revised to accommodate current campus needs, enrollment, and post COVID services

Master Plan Refinement 2023



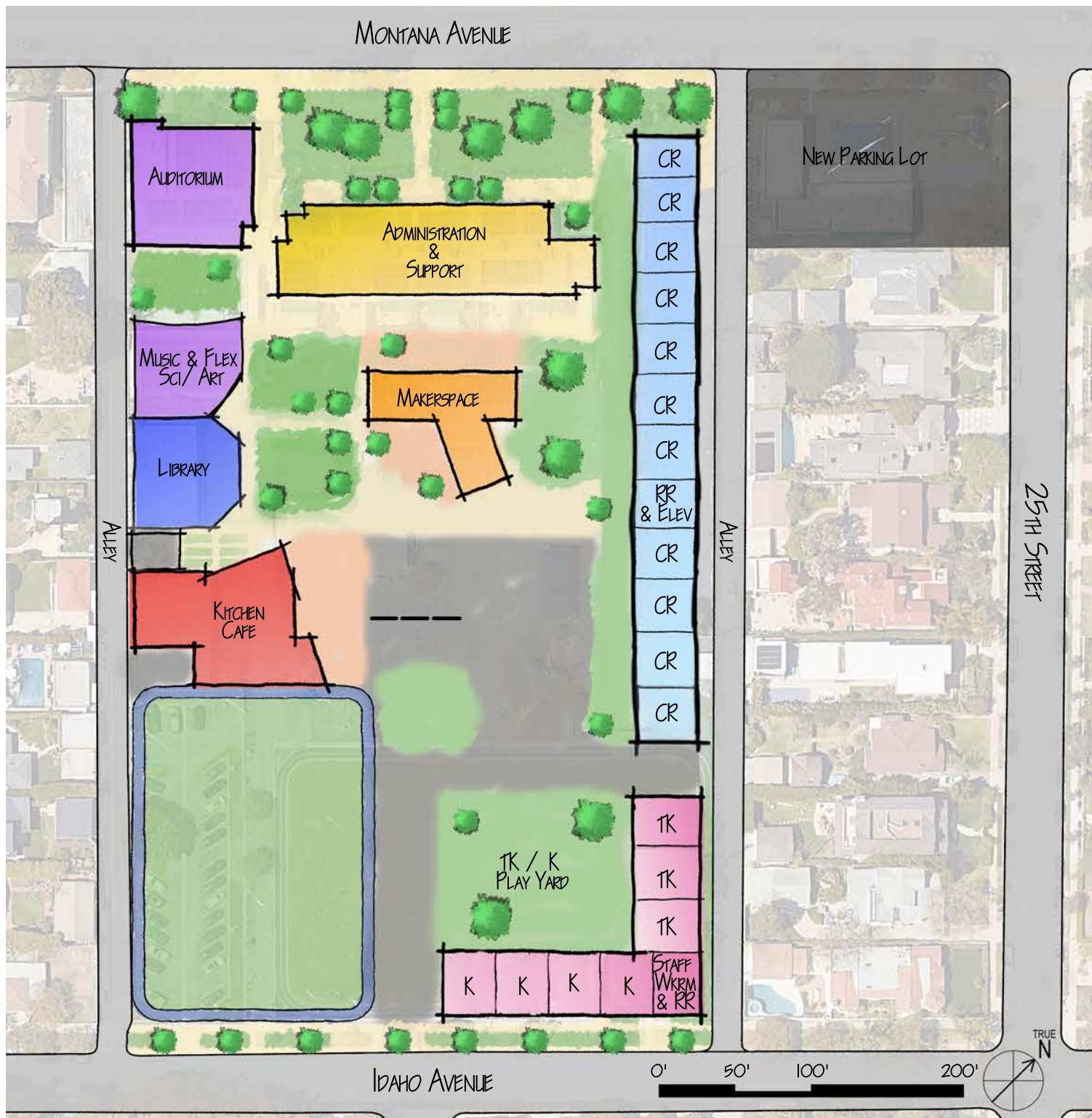

Administration & Support - First Floor

- Interior Building Renovation

4,769 Square Feet

- Interior Building Renovation
- Outdoor Performance Area

4,300 Square Feet

- Music, Science, and Art Classrooms

5,000 Square Feet

- Modern Library, Book Storage, and Book Garden

7,600 Square Feet

- Complete Culinary Kitchen
- Indoor / Outdoor seating

4,200 Square Feet

- Indoor / Outdoor Maker Studios
- Presentation Yard w/ Flexible Outdoor Spaces

15,500 Square Feet

- 11 Classrooms
- Student and Staff Restrooms
- Elevator and Stairs
- Outdoor Classrooms

10,700 Square Feet

- 4 Kindergarten and 3 Transitional Kindergarten Classrooms
- Student Restrooms within the classrooms
- Teacher Workroom and Staff Restroom
- Enclosed K / TK Play Yard

- U-10 Soccer Field w/ Running Track
- Hardscape Play Area including 3 Basketball Courts and 3 Handball Courts
- New Play Equipment
- New Parking Lot with approximately 44 spots

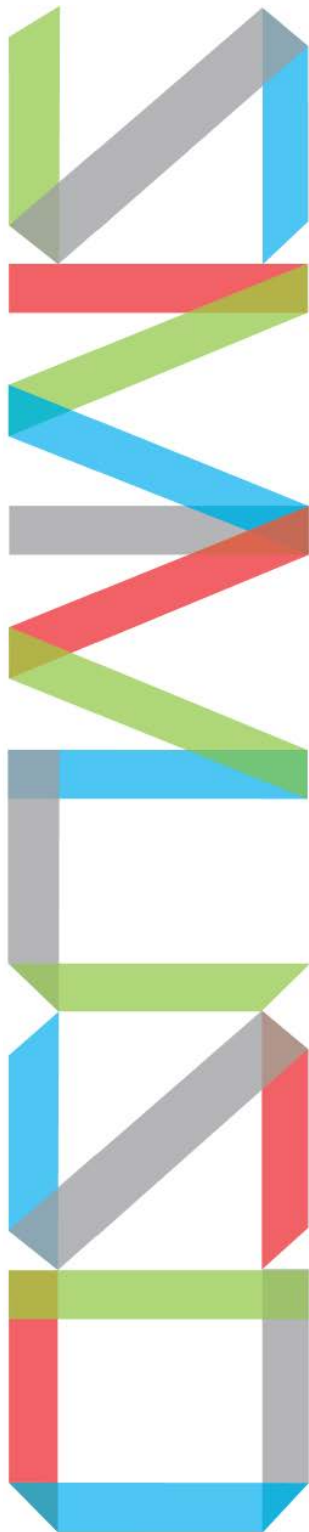

Proposed Master Plan - Second Floor

Administration & Support - Second Floor

10,950 Square Feet

- Interior Building Renovation
- 2 Teaming Rooms
- 1 Classroom

Classroom Building - Second Floor

15,500 Square Feet

- 11 Classrooms
- Student and Staff Restrooms
- Elevator and Stairs

Proposed Master Plan



Proposed TK/K Classroom Complex



Proposed Makerspace



Proposed Kitchen / Cafe



Proposed Library & Flex Building



Proposed Phasing: Existing

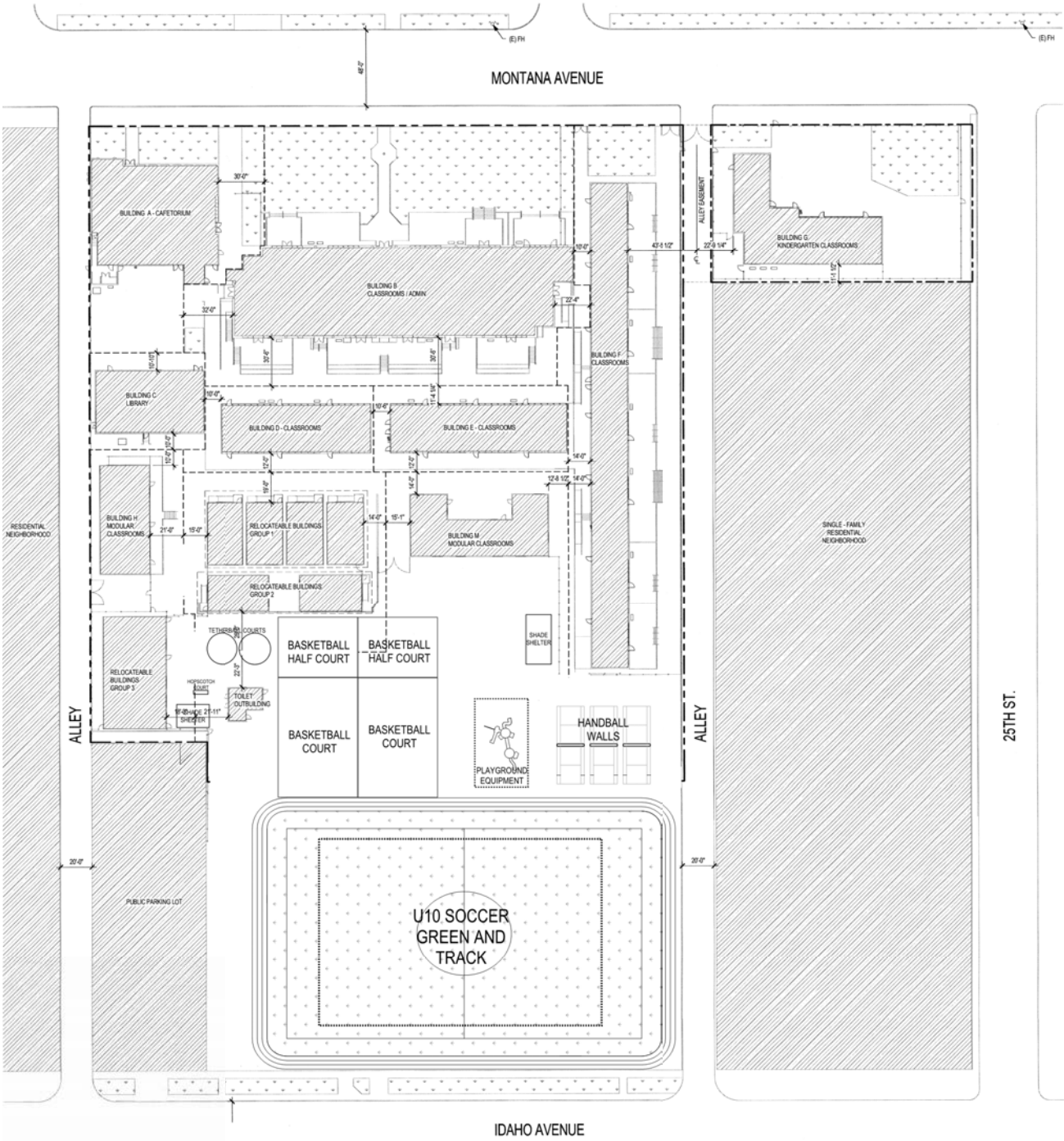

1F

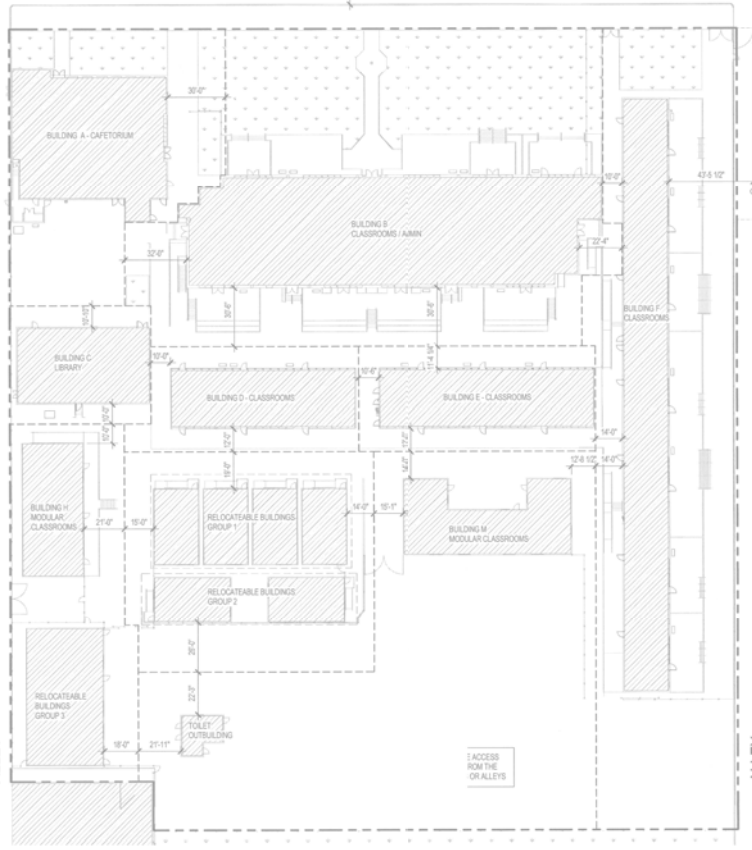

2F

Proposed Phasing: 1A Demo

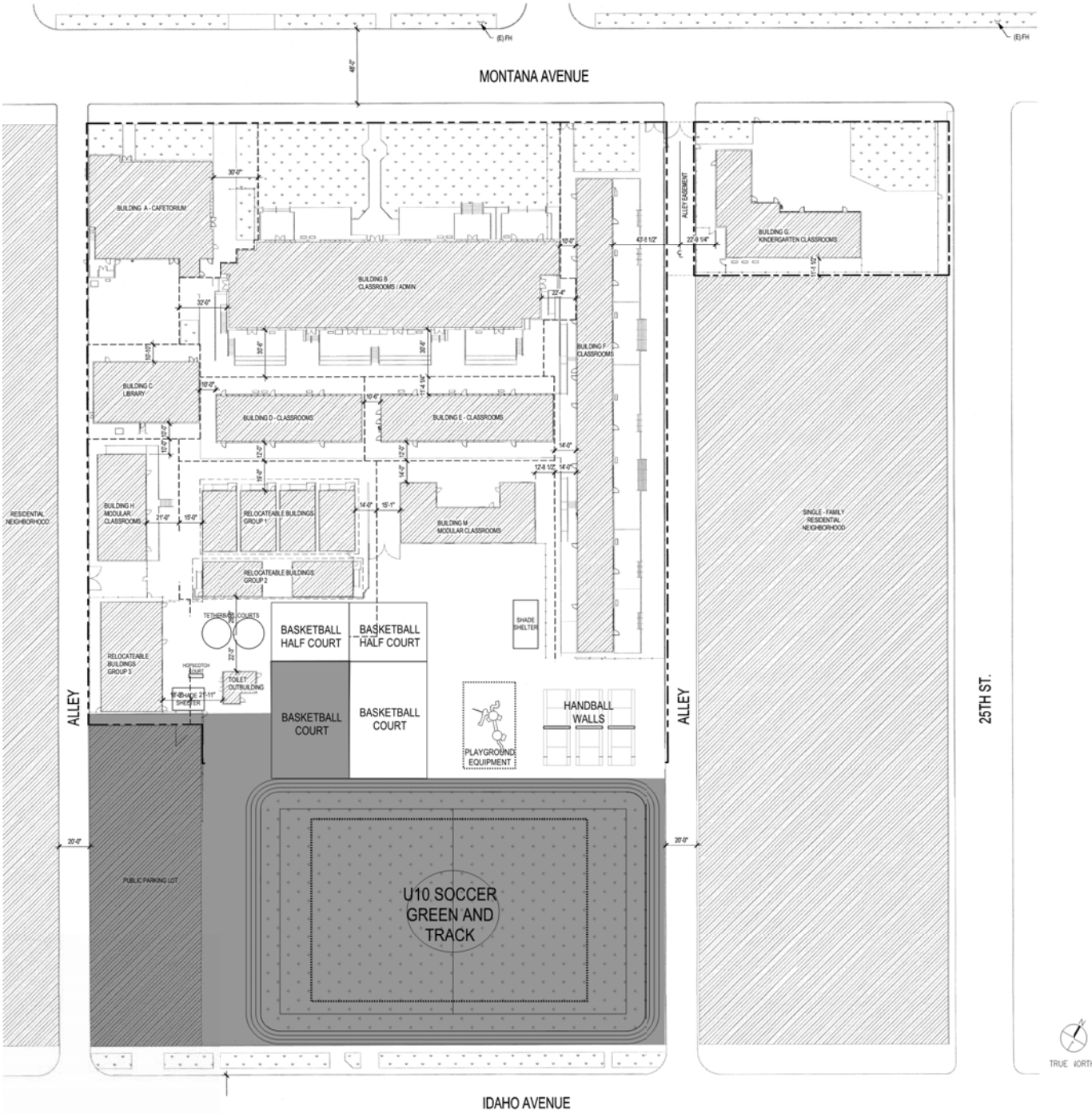

1F

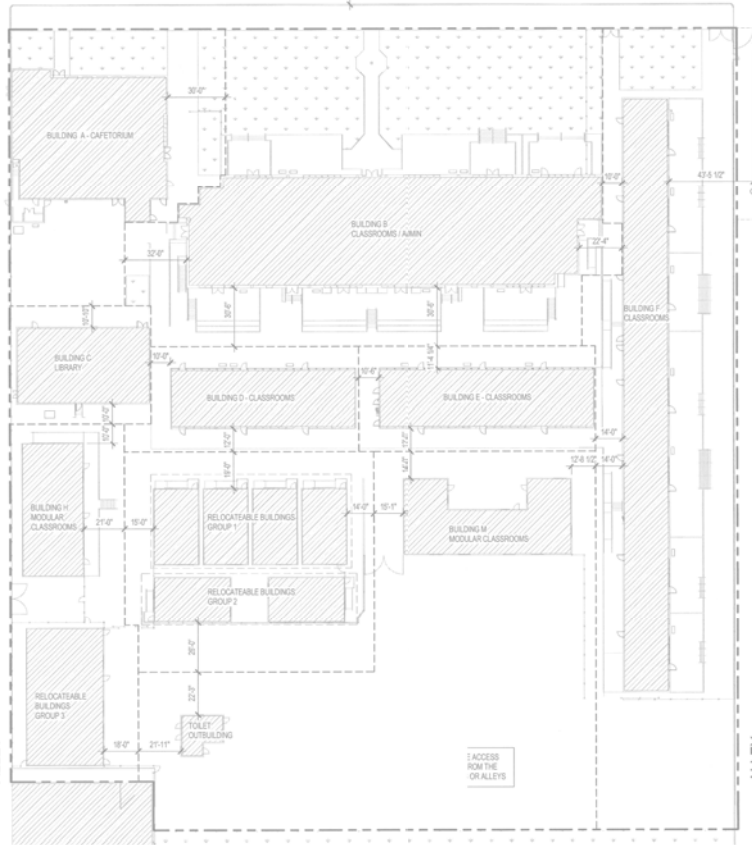

2F

Proposed Phasing: 1A Build

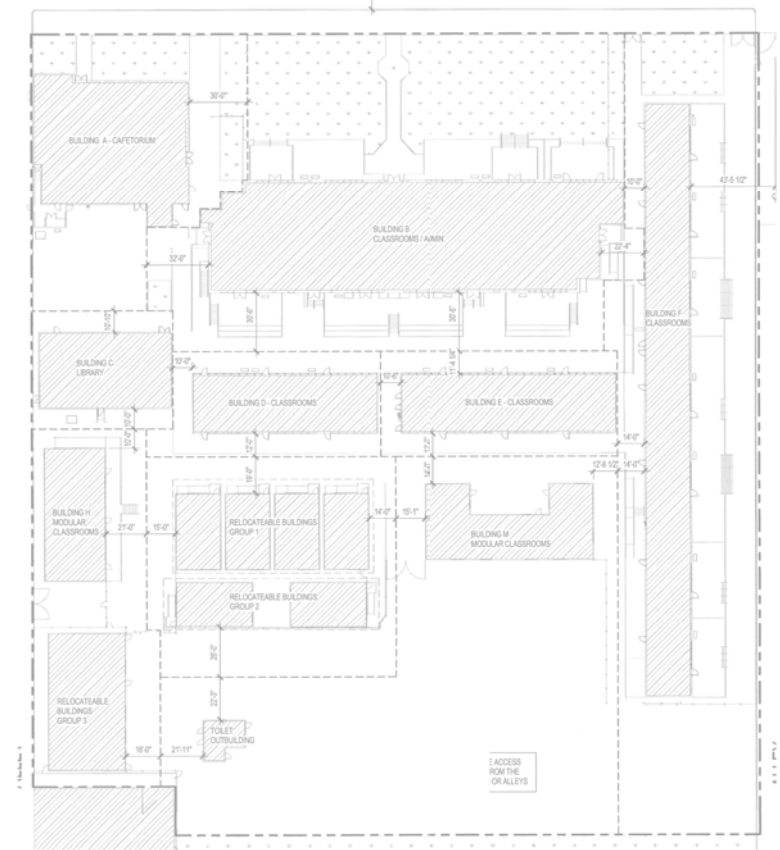
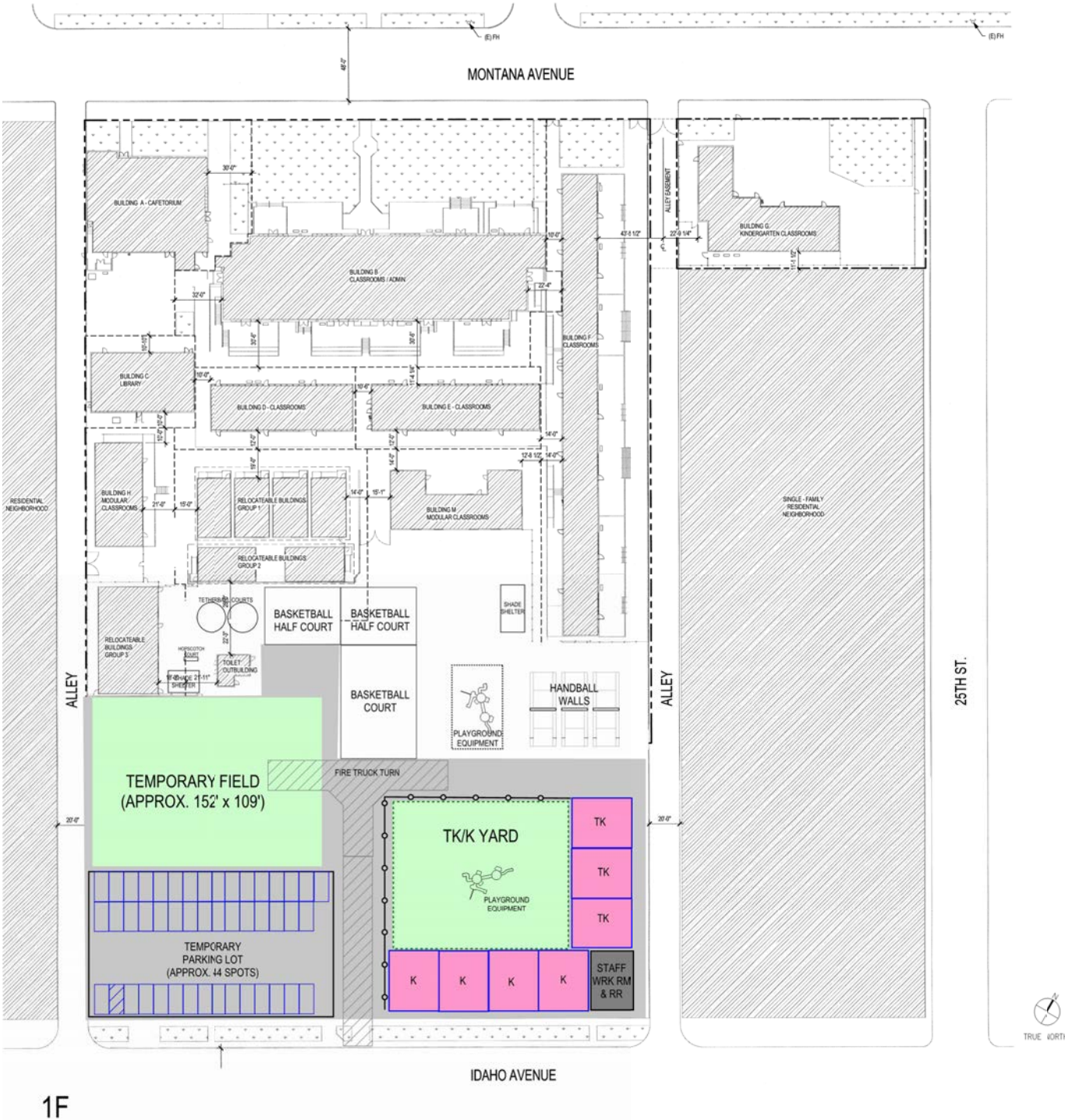

2F

Proposed Phasing: 1B Demo

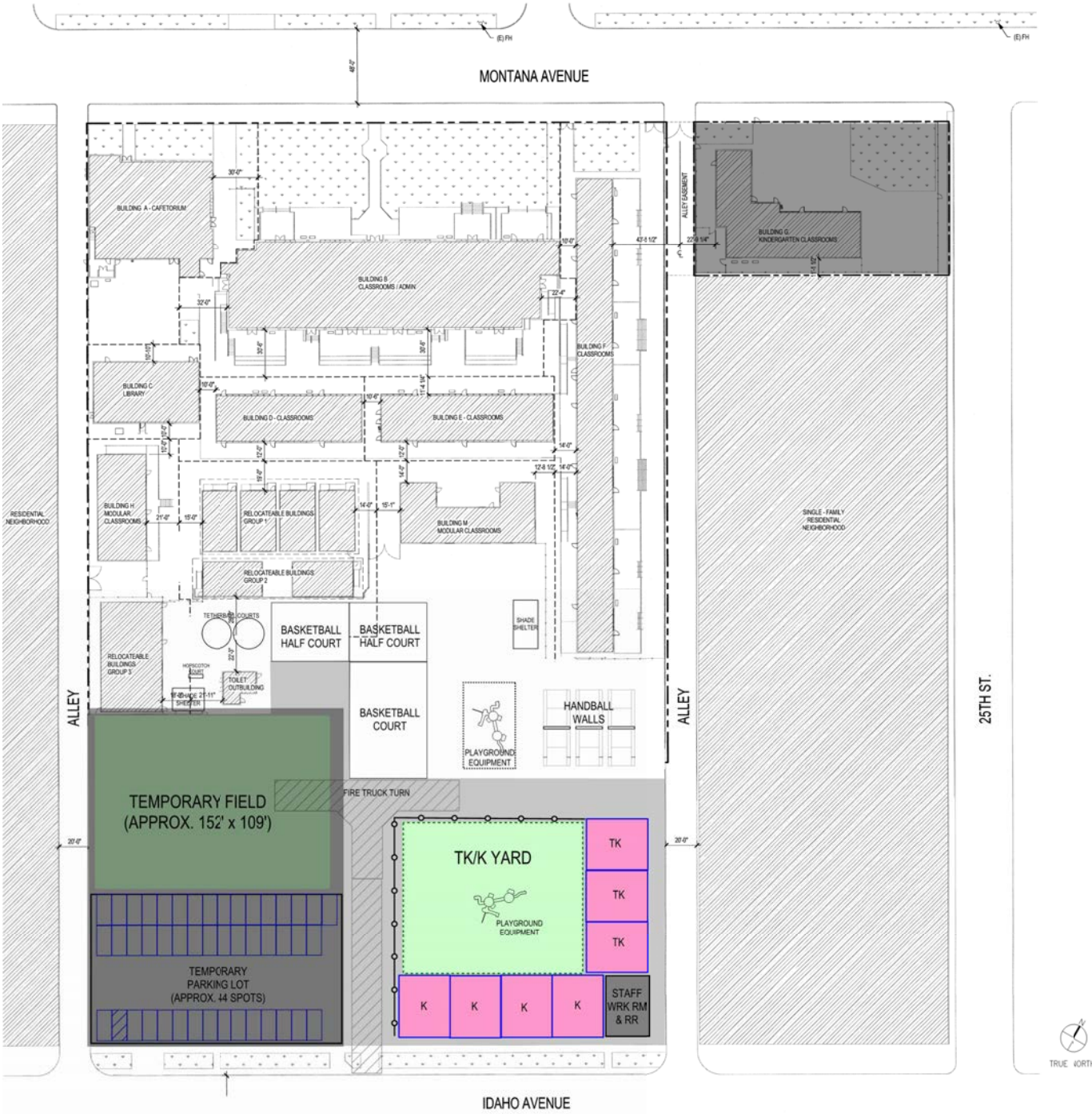

1F

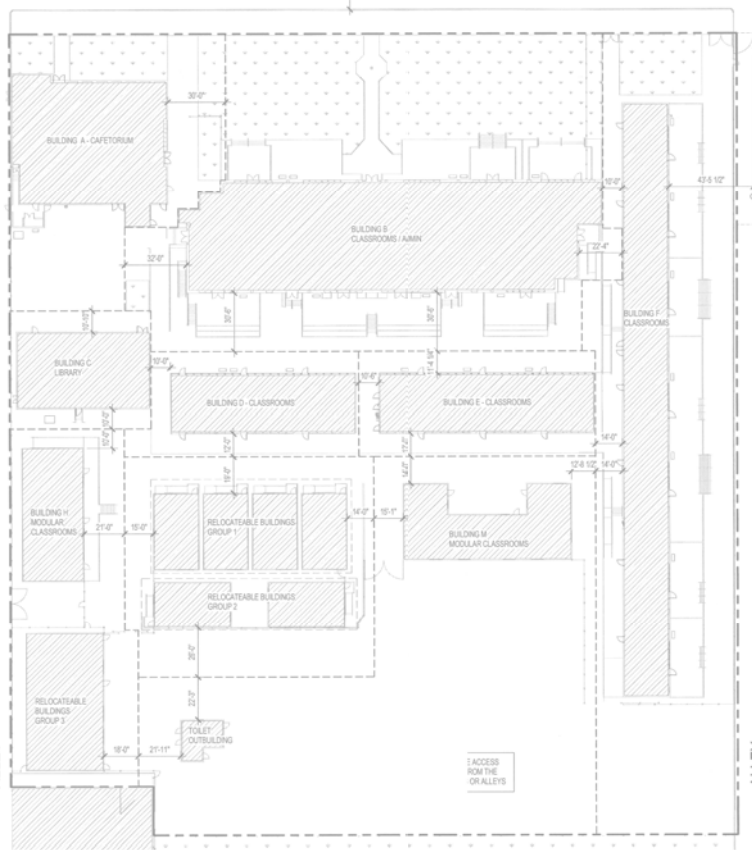

2F

Proposed Phasing: 1B Build

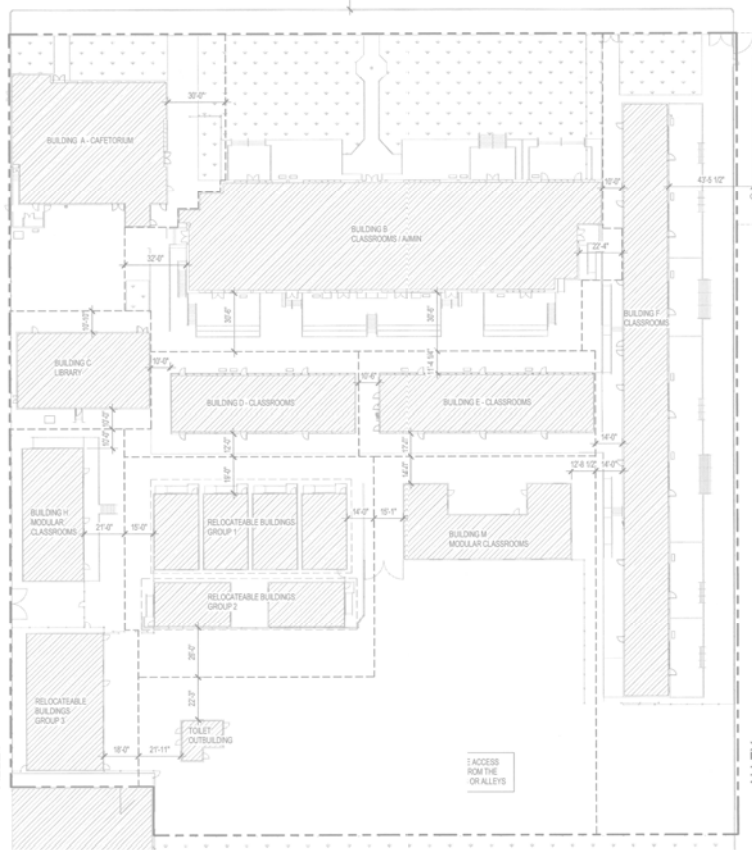
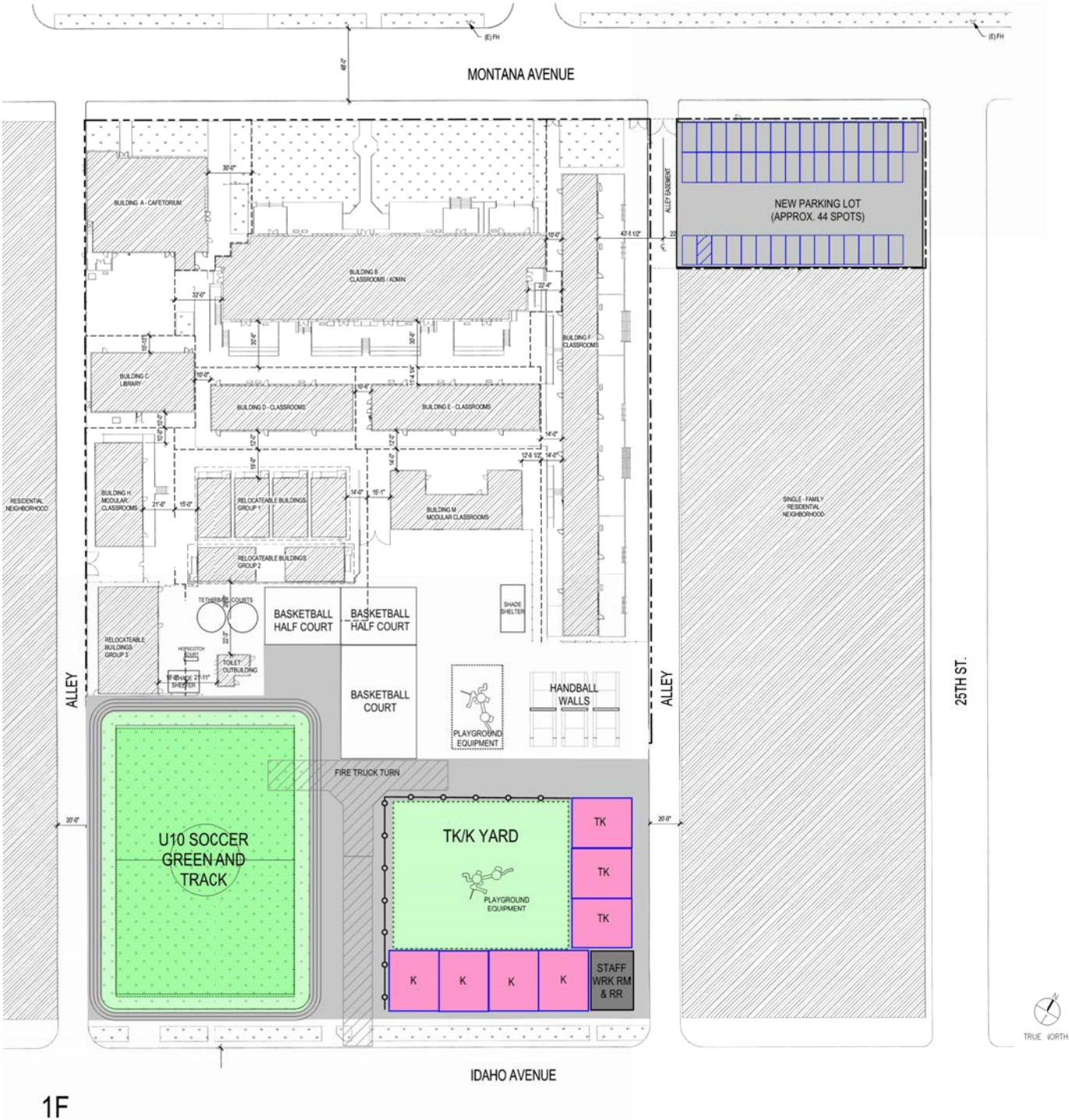

2F

Proposed Phasing: 2 Demo

3 Classrooms to be reassigned

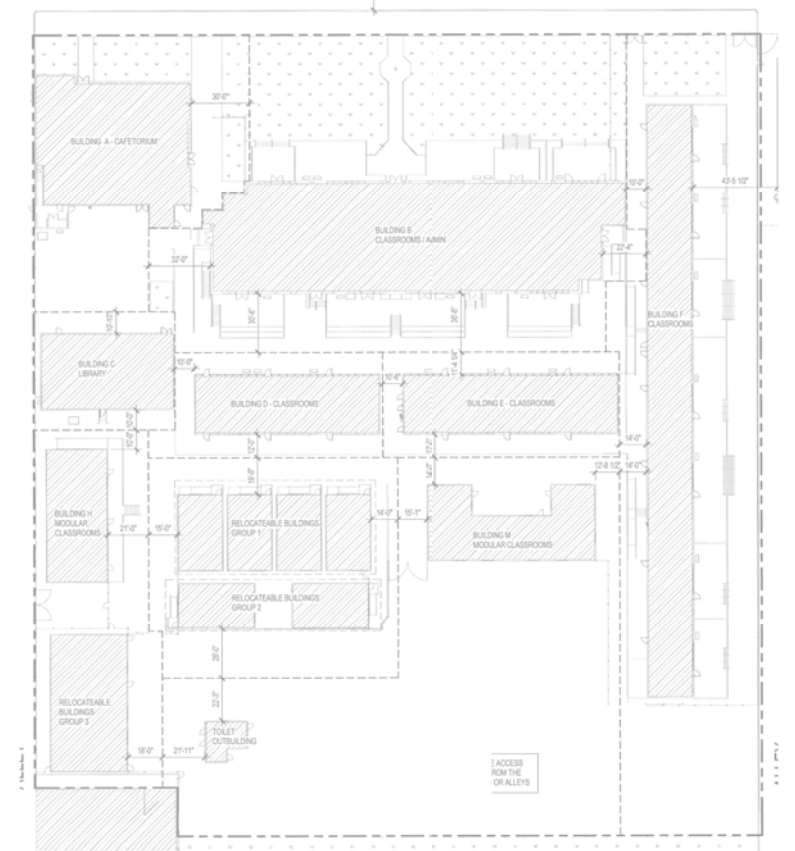
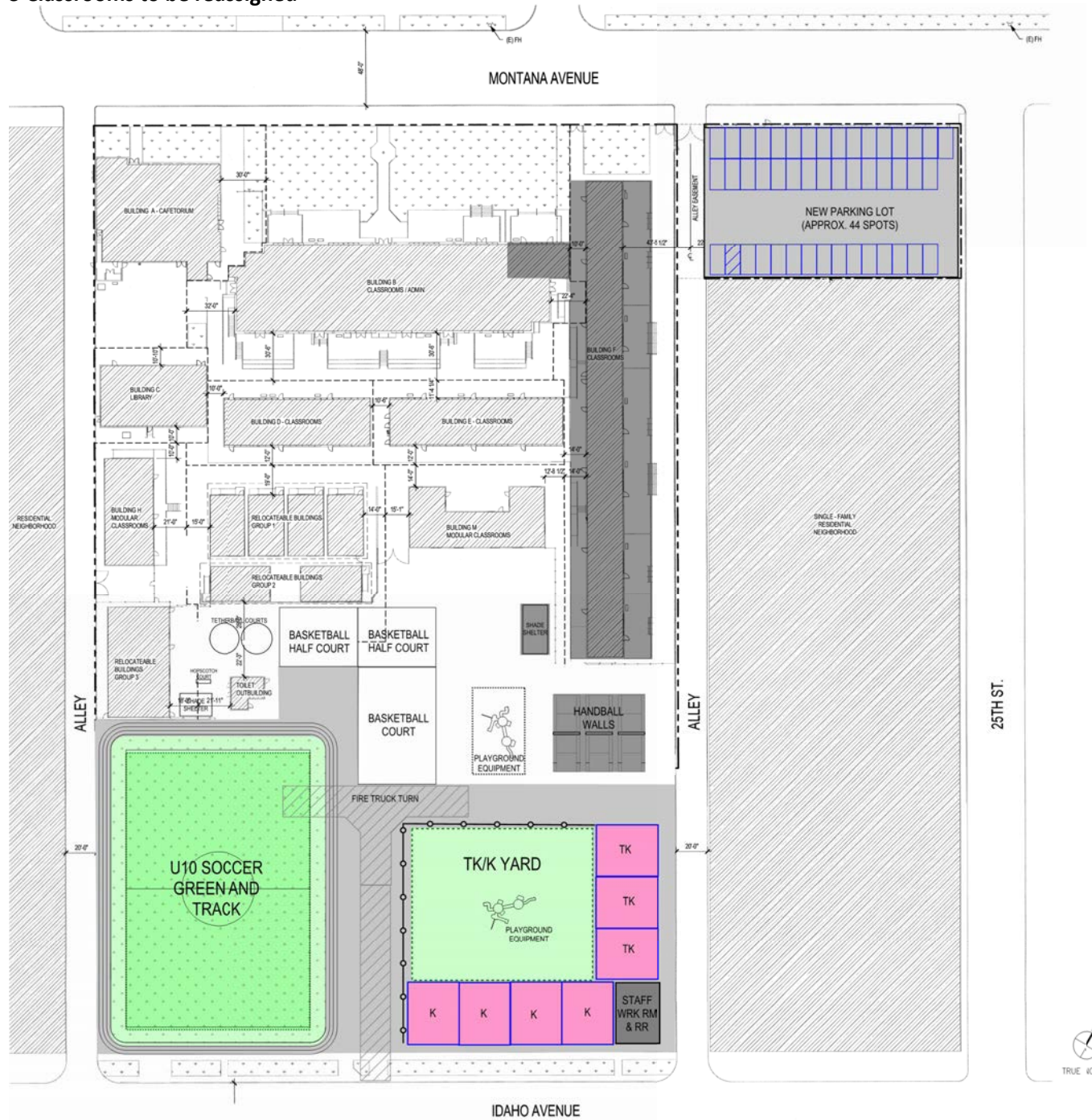

2F

Proposed Phasing: 2 Build

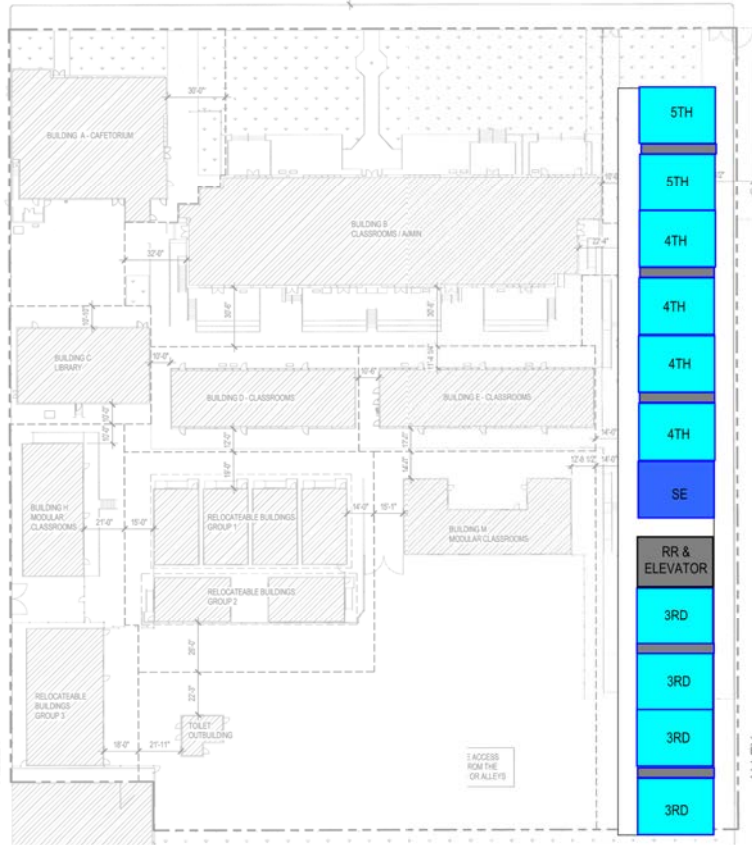
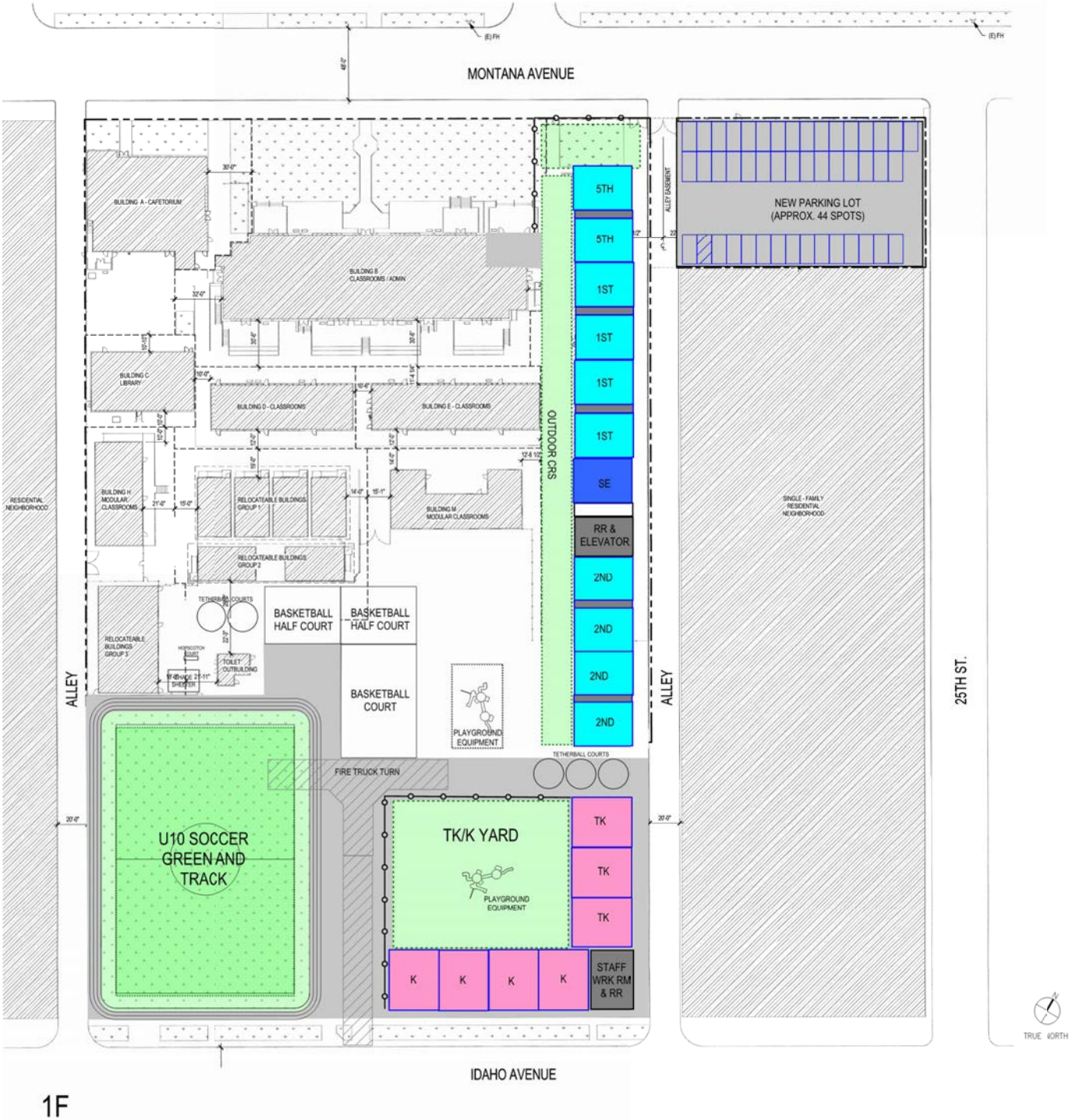

2F

Proposed Phasing: 3 Demo

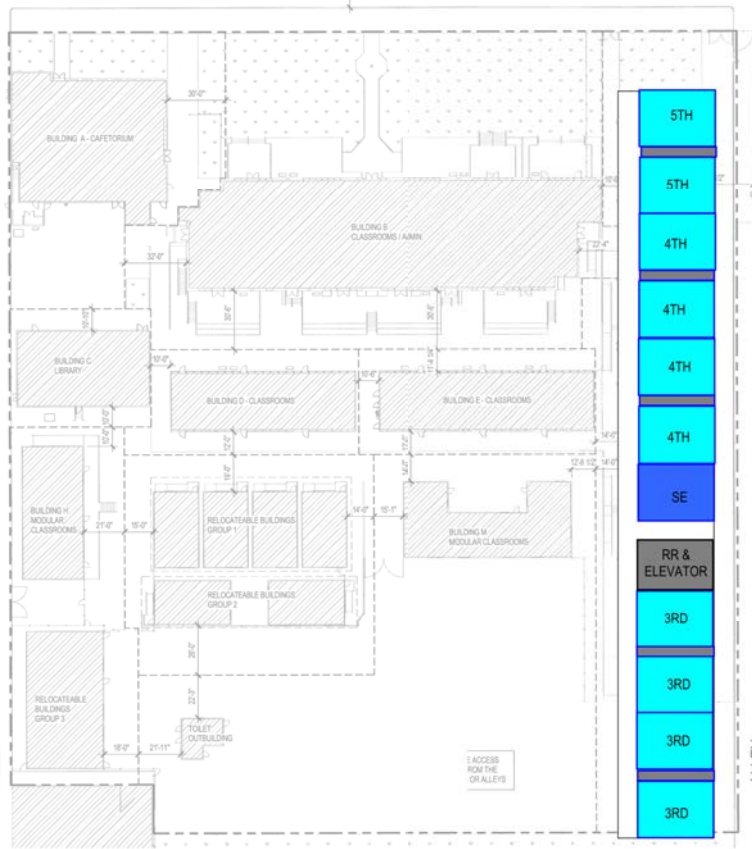
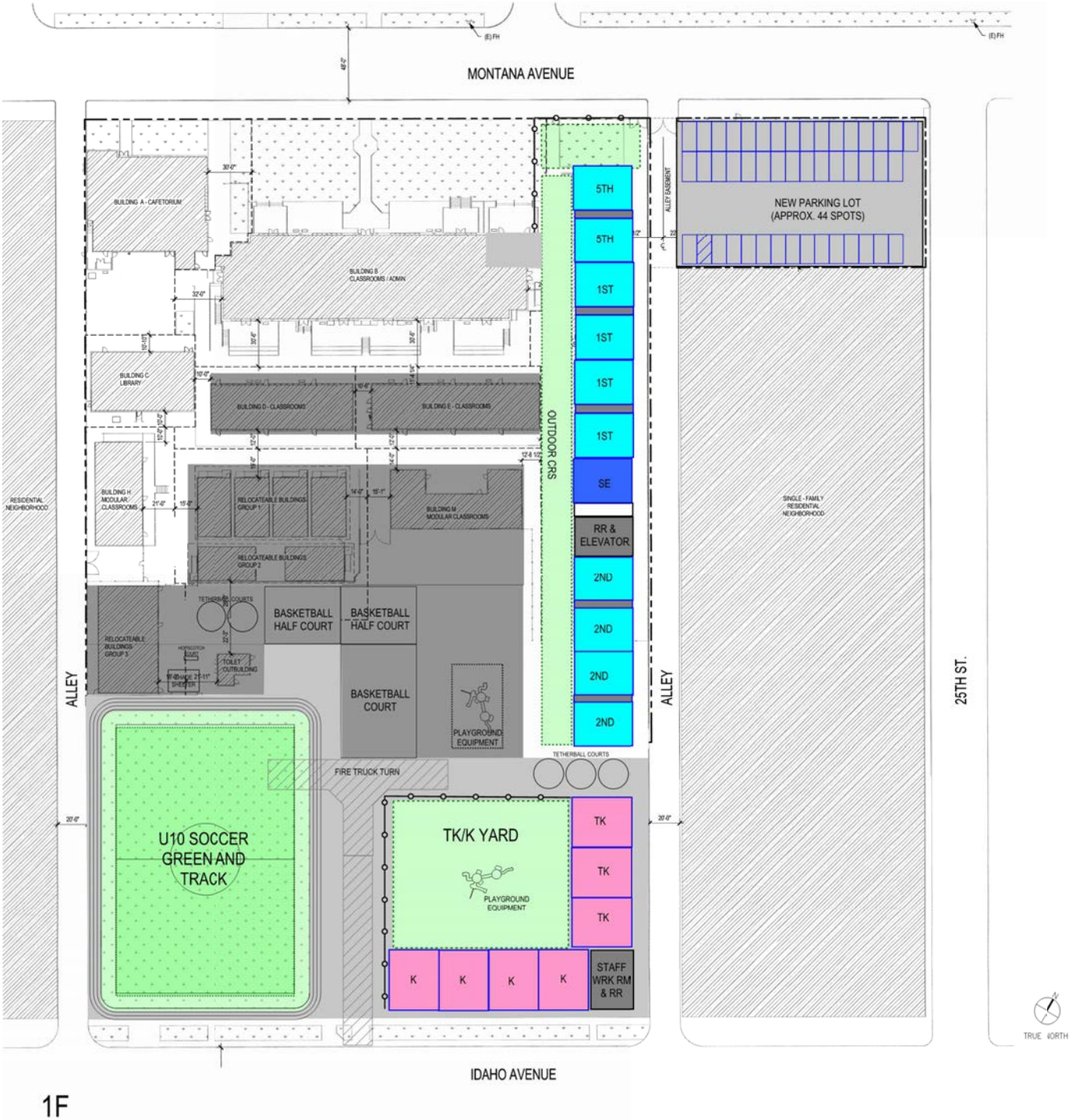

2F

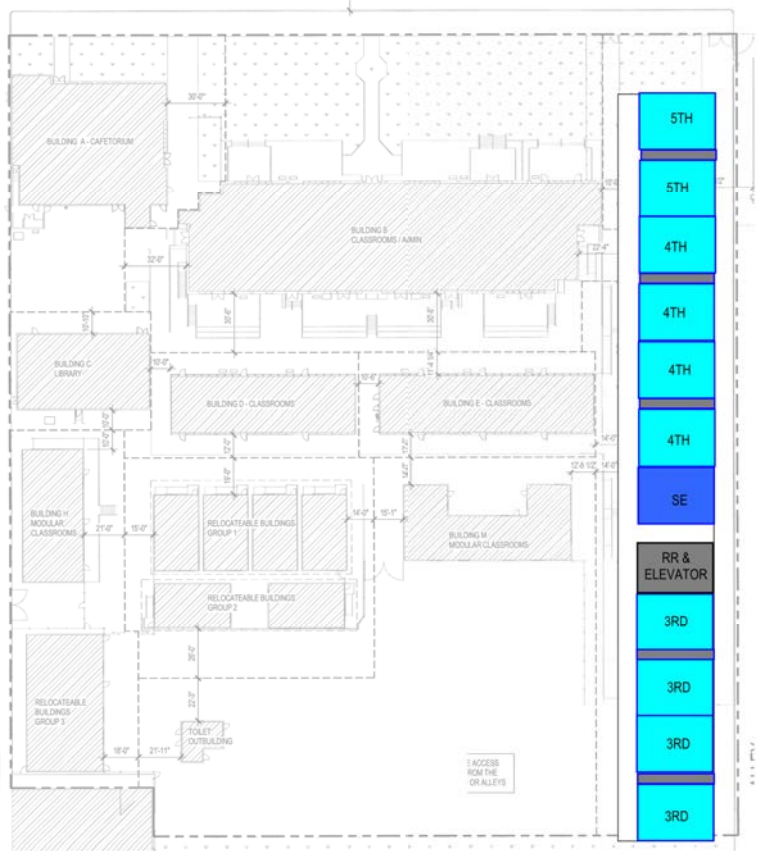
 $2F$

Proposed Phasing: 4 Demo

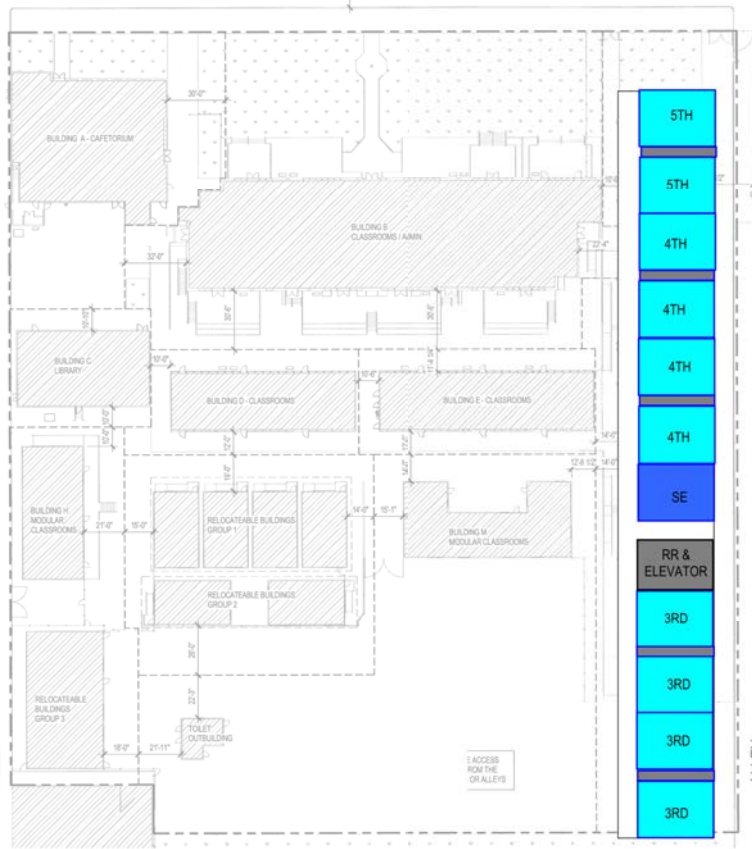
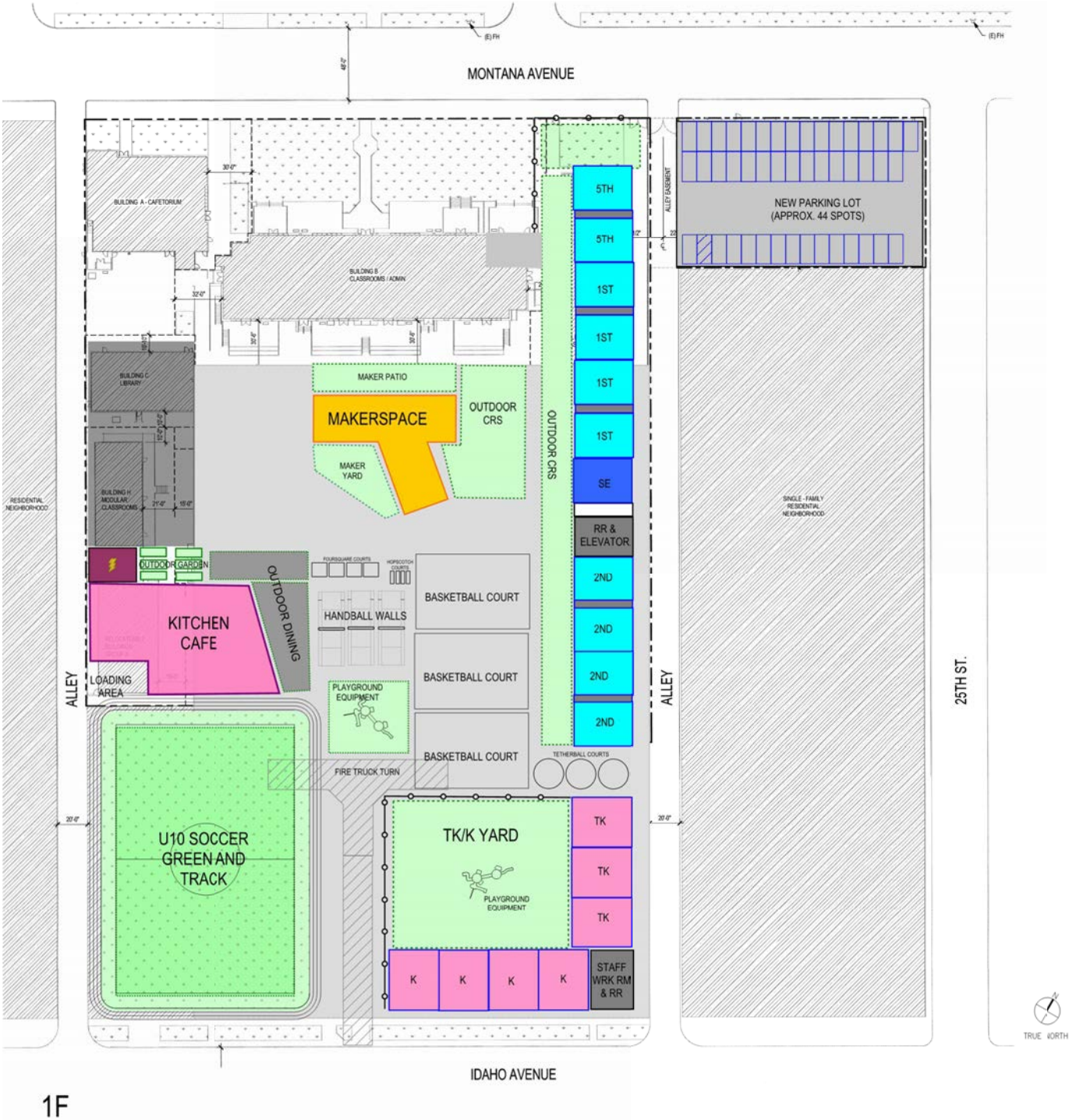

Proposed Phasing: 4 Build

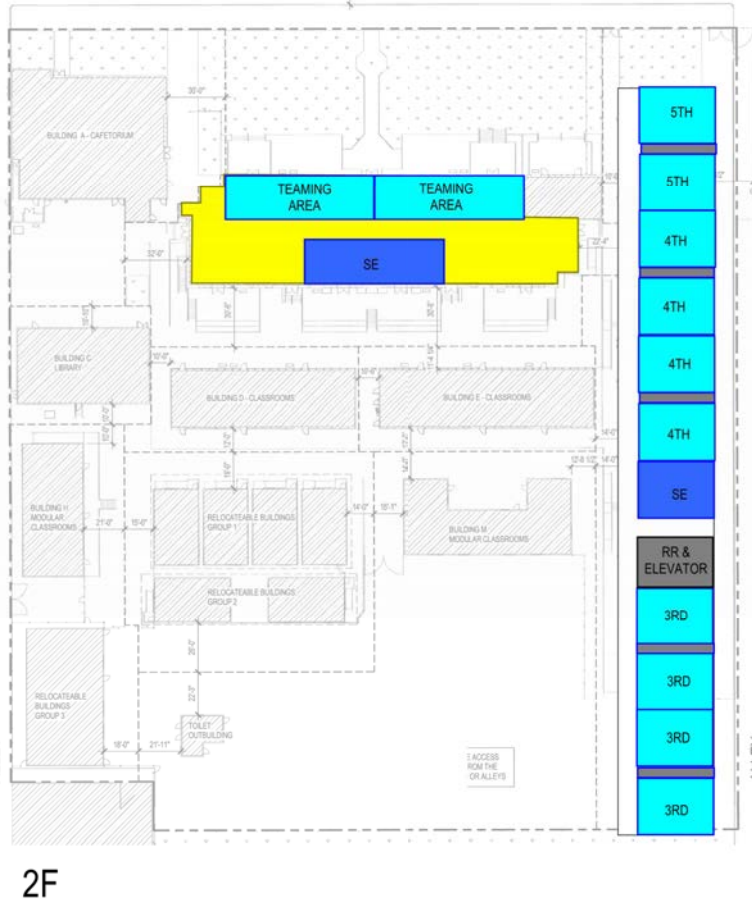

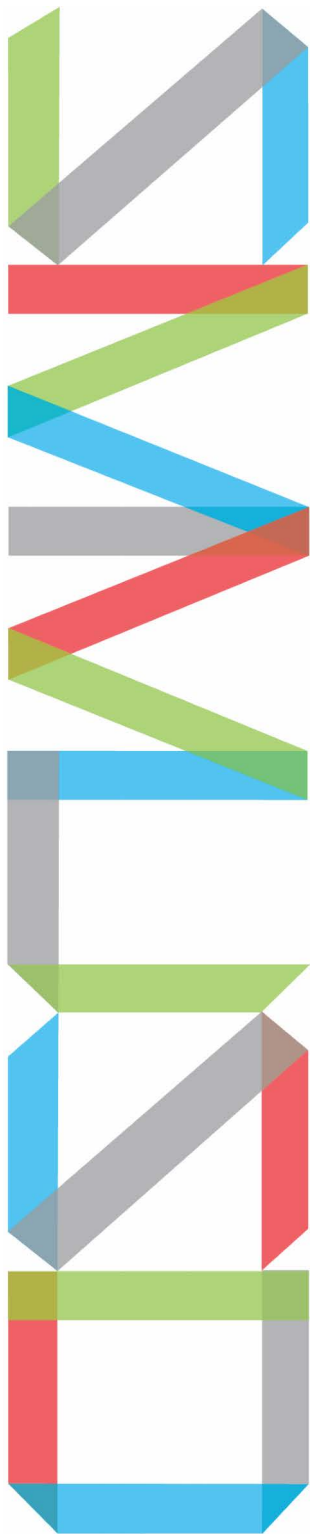

Questions