

2F

Notes:

- The Campus has the following Recreation Items:
 - Play Yard approximately 212 FT x 108 FT
 - U8 Soccer sized field & 3 Lane Track
 - 2 Basketball / Tennis Courts
 - 3 Handball Walls
 - 3 Tetherball Courts
 - 4 Hopscotch Courts
 - 4 Foursquare Courts
 - 3 Playground Equipment Structures
 - 1 Public & 2 Kindergarten
 - 3 Shade Structures
 - 1 Kickball Field

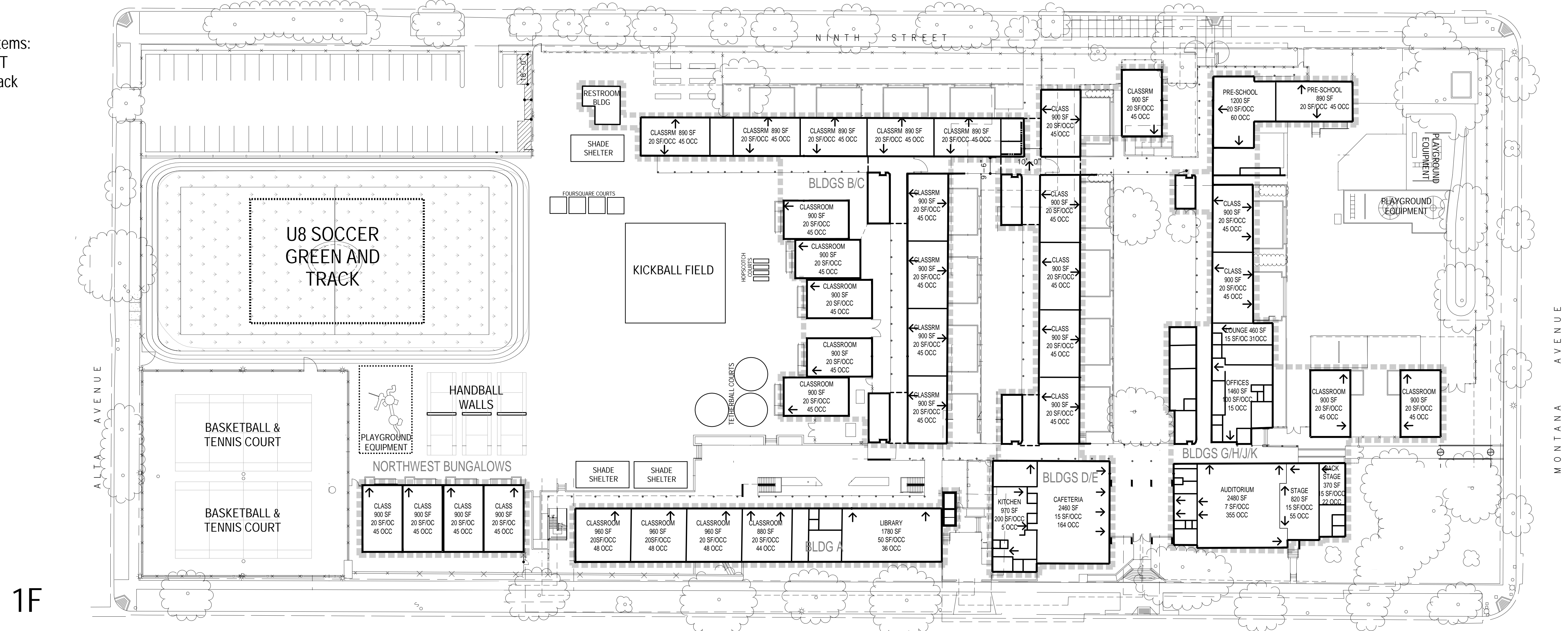

1F

CURRENT MASTERPLAN
PROPOSED AT 2020 FALL
COMMUNITY MEETING

2F



1F

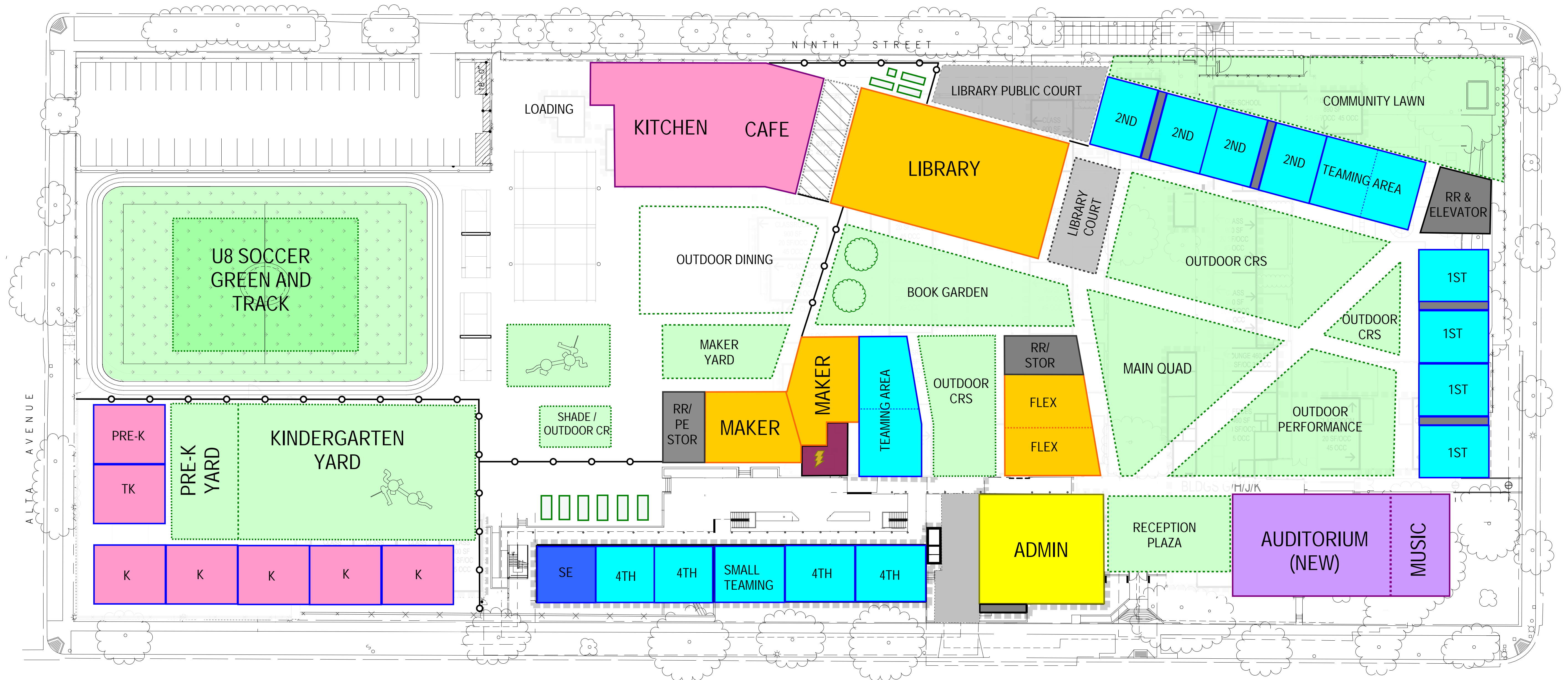

REFINED MASTERPLAN PROPOSED AT 2020 FALL COMMUNITY MEETING

2F



1F

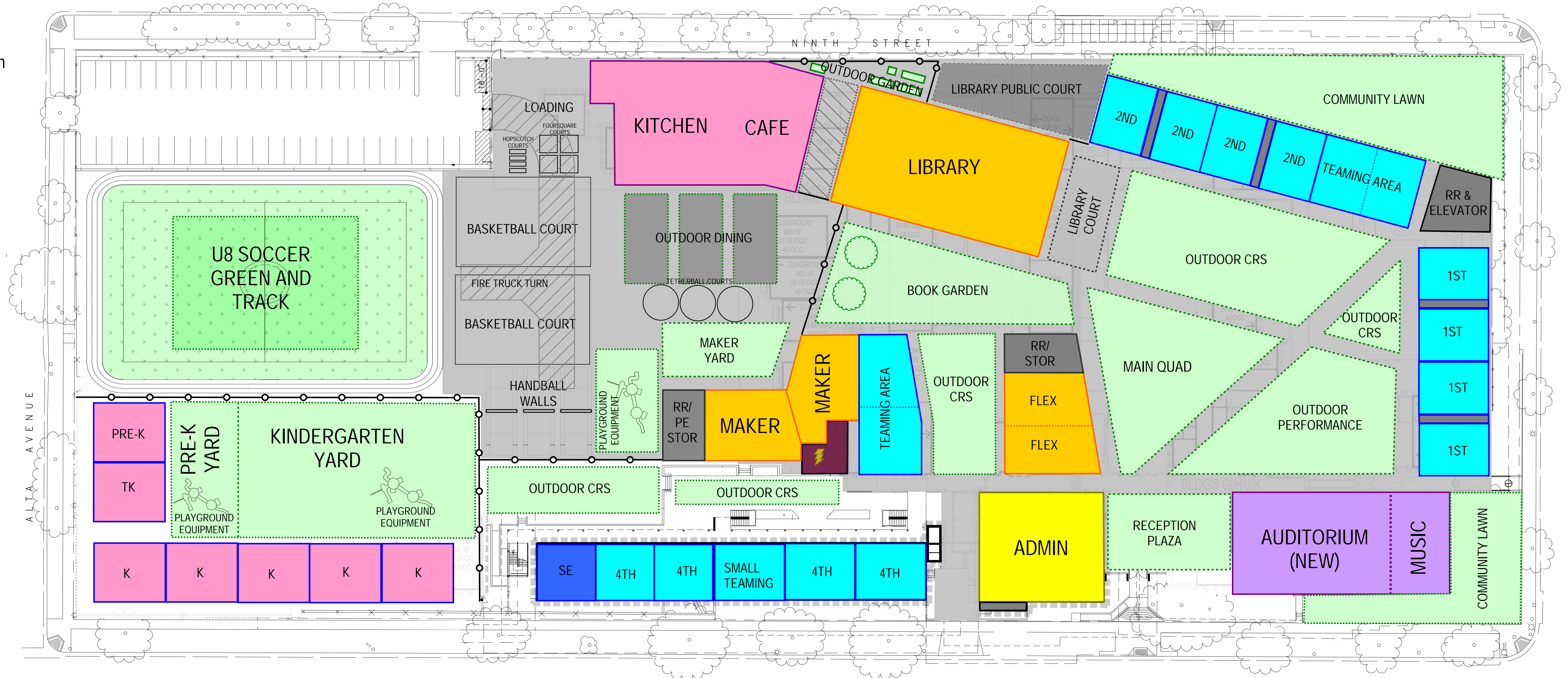

Notes:

- This option is a refined version of the original Masterplan from the 2020 Fall Community Meeting
- This option has the following Recreation Items:
 - Play Yard approximately 184 FT x 108 FT
 - A U8 Soccer sized field & 3 Lane Track
 - 2 Basketball Courts
 - 3 Handball Walls
 - 3 Tetherball Courts
 - 4 Hopscotch Courts
 - 4 Foursquare Courts
 - 3 Playground Equipment Structures
 - 1 Public & 2 Kindergarten
 - 3 Outdoor Dining Shade Structures
 - Various Shade Structures will be designed for the Outdoor Classrooms

MONTANA AVENUE

ALTA AVENUE

NINTH STREET

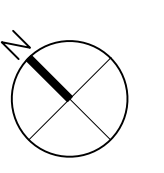

CAMPUS PLAN AFTER PK/TK/K CLASSROOM BUILDING CONSTRUCTION

2F

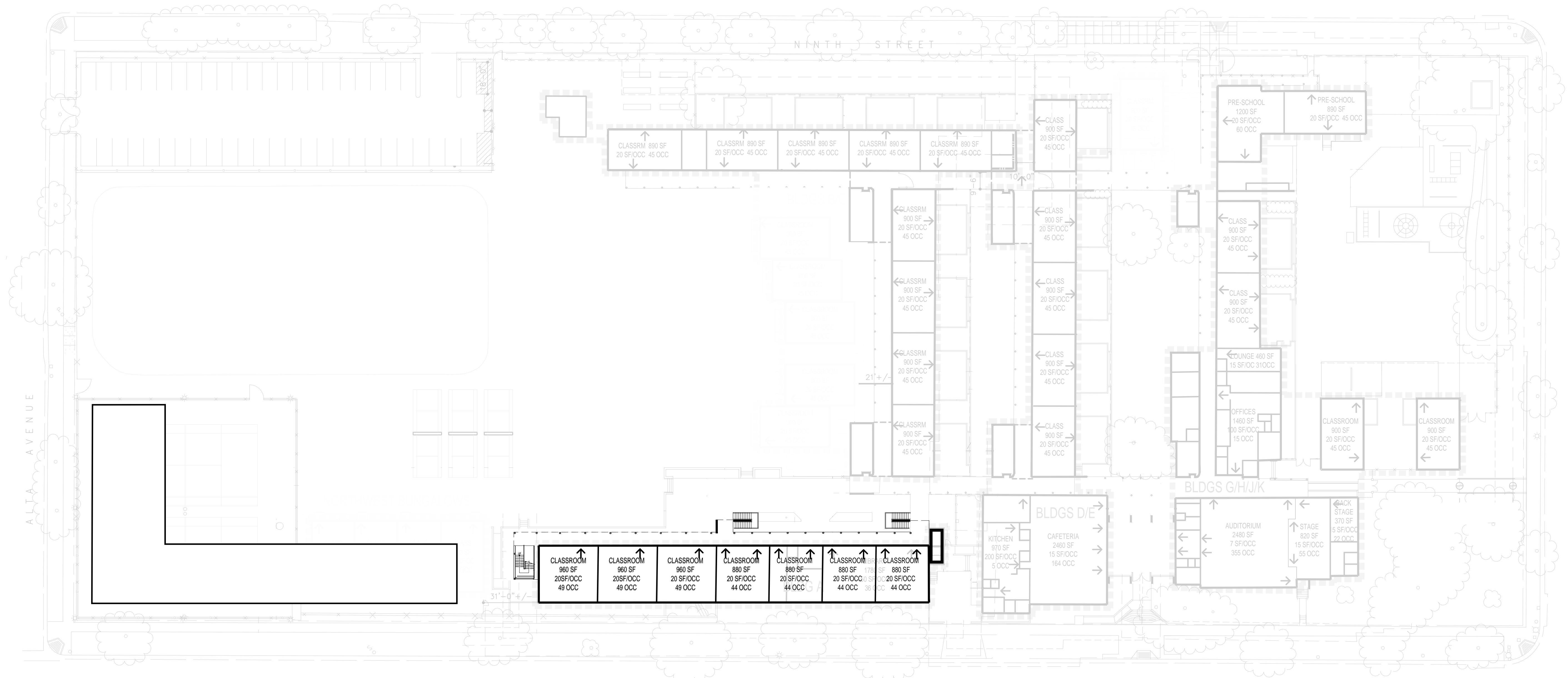

1F



Notes:

- This is the Masterplan after the first SMS project is constructed
- This plan has the following Recreation Items:
 - Play Yard approximately 184 FT x 108 FT
 - A U8 Soccer sized field & 3 Lane Track
 - 2 Basketball Courts
 - 3 Handball Walls
 - 3 Tetherball Courts
 - 4 Hopscotch Courts
 - 4 Foursquare Courts
 - 5 Playground Equipment Structures
 - 1 New Public, 2 New Kindergarten & 2 Existing Non-Public
 - 3 Existing Shade Structures (one may need to be removed to comply with the Fire Truck Turn shown in a gray hatch)

REFINED MASTERPLAN OPTION A

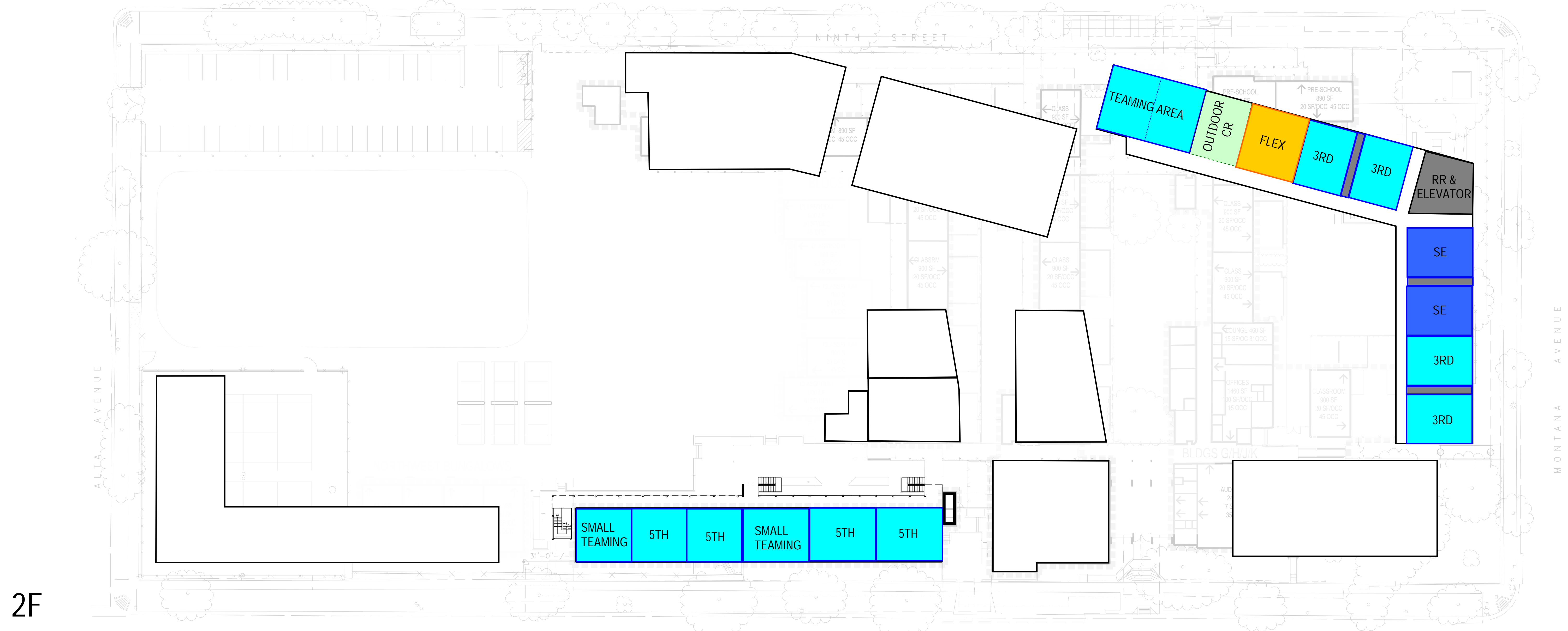

Notes for how this option differs from the Masterplan Proposed at the 2020 Fall Community Mtg:

- Removes the Restroom / PE Storage Building (Restrooms will be located in the Kitchen / Cafe for use after hours)
- Moves one of the Flex rooms to the second floor of the Boomerang Building
- Shifts the Makerspace Building
- Shifts the Teaming Area with one of the Flex Rooms
- Moves and reduces the Maker Yard
- The Play Yard is the same size as the Proposed Masterplan from the 2020 Fall Community Meeting
- This option has the following Recreation Items:
 - Play Yard approximately 184 FT x 108 FT
 - A U8 Soccer sized field & 3 Lane Track
 - 2 Basketball Courts
 - 3 Handball Walls
 - 3 Tetherball Courts
 - 4 Hopscotch Courts
 - 4 Foursquare Courts
 - 3 Playground Equipment Structures
 - 1 Public & 2 Kindergarten
 - 3 Outdoor Dining Shade Structures
 - Various Shade Structures will be designed for the Outdoor Classrooms
 - 1 Kickball Field

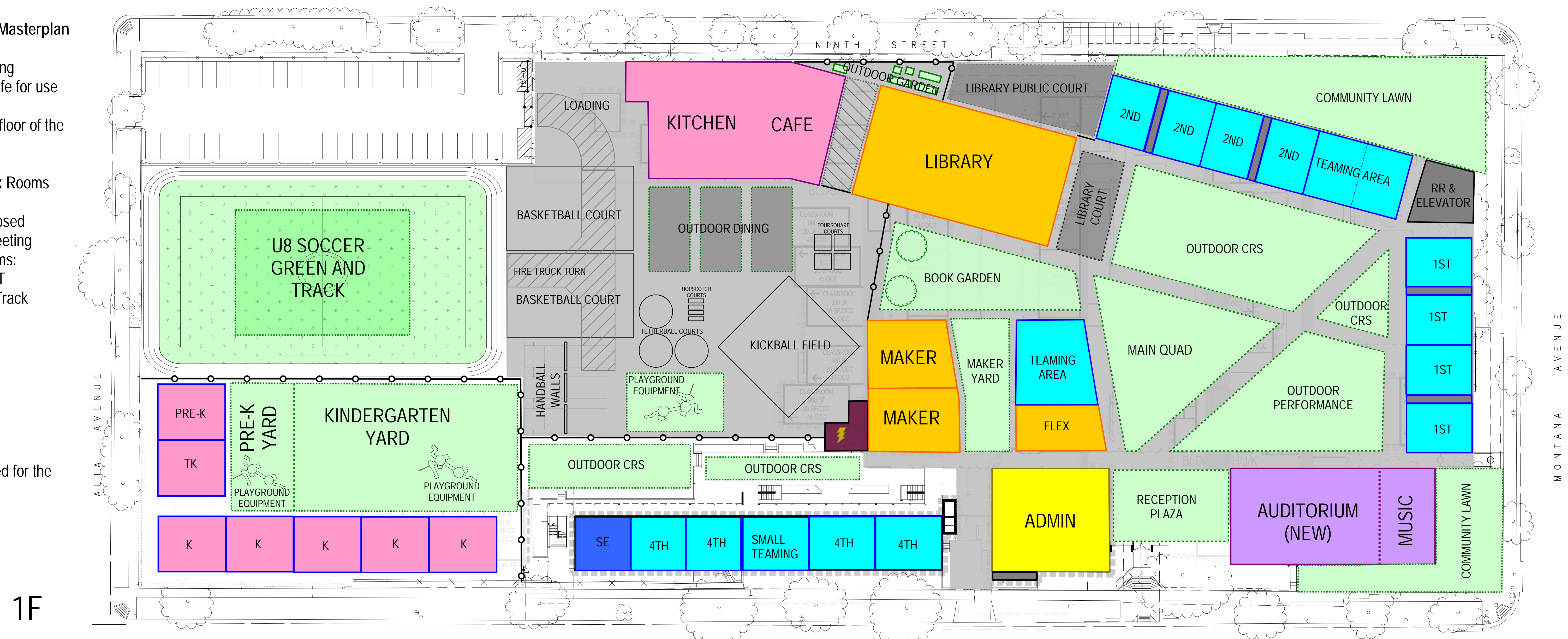

REFINED MASTERPLAN OPTION B

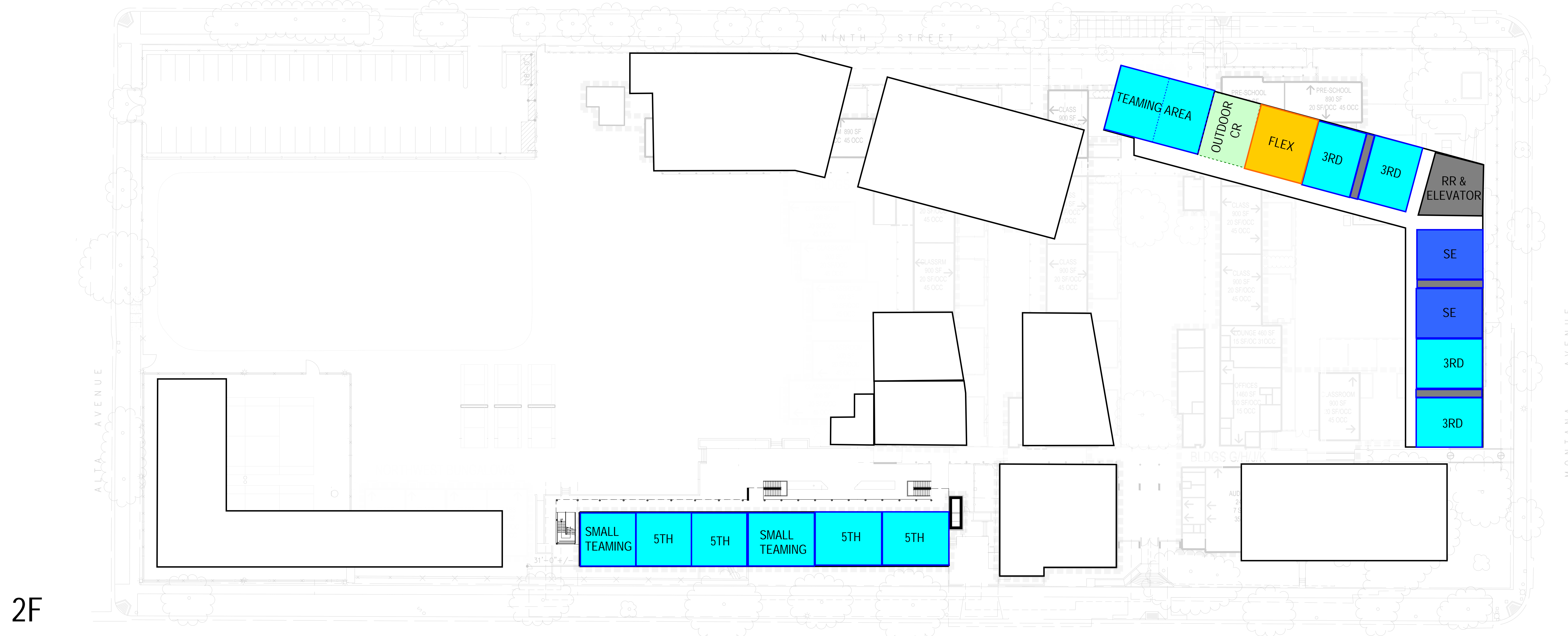

Notes for how this option differs from the Masterplan Proposed at the 2020 Fall Community Mtg:

- Removes the Restroom / PE Storage Building (Restrooms will be located in the Kitchen / Cafe for use after hours)
- Moves one of the Flex rooms to the second floor of the Boomerang Building
- Shifts the Makerspace Building
- Shifts the Teaming Area with one of the Flex Rooms
- Moves and reduces the Maker Yard
- The Play Yard is the same size as the Proposed Masterplan from the 2020 Fall Community Meeting
- This option has the following Recreation Items:
 - Play Yard approximately 184 FT x 108 FT
 - A U8 Soccer sized field & 3 Lane Track
 - 3 Basketball Courts (one more than Option A)
 - 3 Handball Walls
 - 3 Tetherball Courts
 - 4 Hopscotch Courts
 - 4 Foursquare Courts
 - 3 Playground Equipment Structures
 - 1 Public & 2 Kindergarten
 - 3 Outdoor Dining Shade Structures
 - Various Shade Structures will be designed for the Outdoor Classrooms
 - 1 Kickball Field

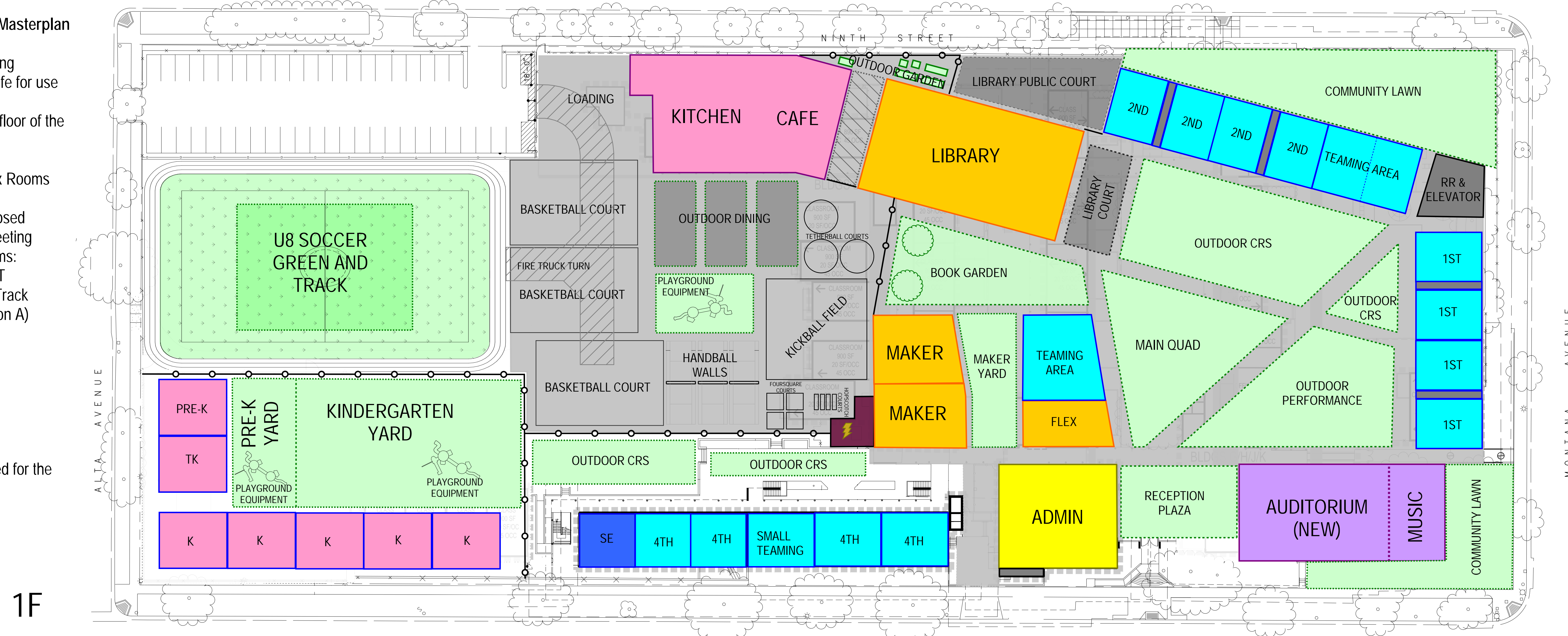

REFINED MASTERPLAN OPTION C

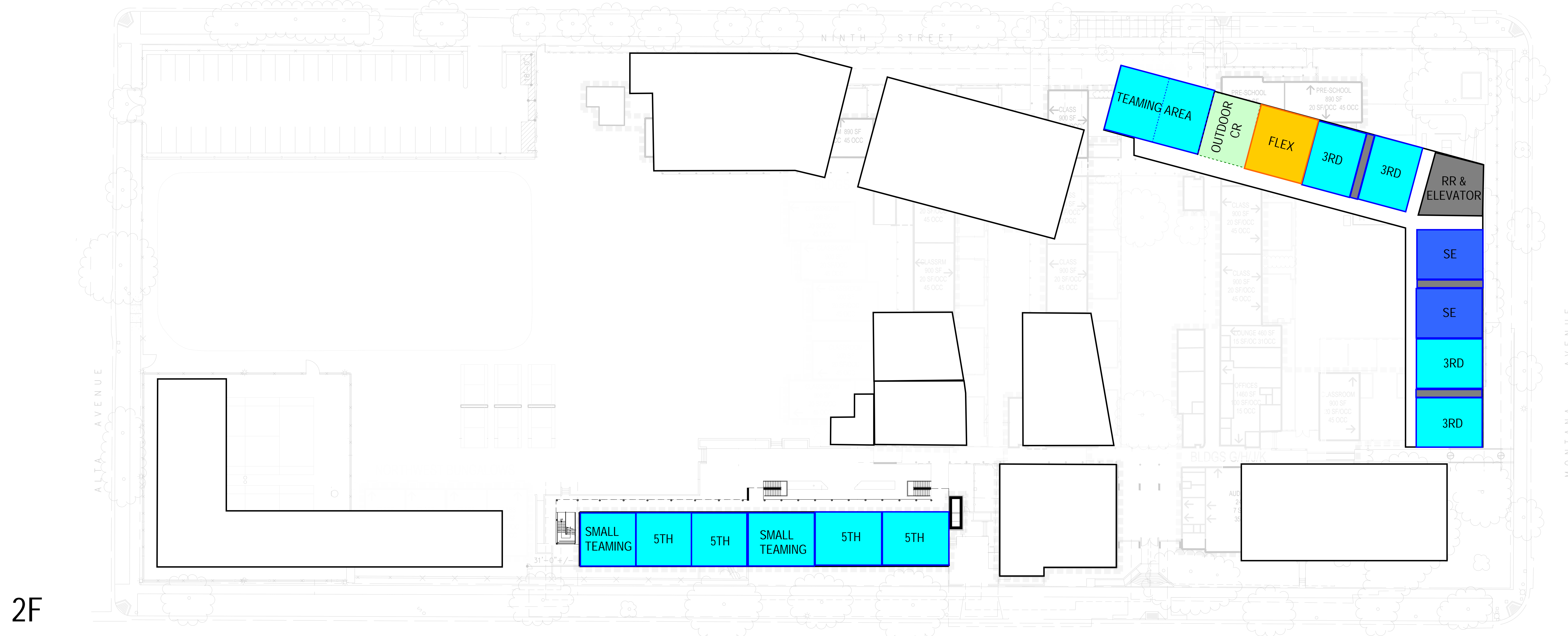

Notes for how this option differs from the Masterplan Proposed at the 2020 Fall Community Mtg:

- Removes the Restroom / PE Storage Building (Restrooms will be located in the Kitchen / Cafe for use after hours)
- Moves one of the Flex rooms to the second floor of the Boomerang Building
- Shifts the Makerspace Building
- Shifts the Teaming Area with one of the Flex Rooms
- Moves and reduces the Maker Yard
- Adjusts Kitchen / Cafe footprint
- The Play Yard matches the size of the current Play Yard
- This option has the following Recreation Items:
 - Play Yard approximately 212 FT x 108 FT
 - A U8 Soccer sized field & 3 Lane Track
 - 3 Basketball Courts (matches Option B, one more than Option A)
 - 3 Handball Walls
 - 3 Tetherball Courts
 - 4 Hopscotch Courts
 - 4 Foursquare Courts
 - 3 Playground Equipment Structures
 - 1 Public & 2 Kindergarten
 - 2 Outdoor Dinning Shade Structures (one less than Options A & B)
 - Various Shade Structures will be designed for the Outdoor Classrooms
 - 1 Kickball Field

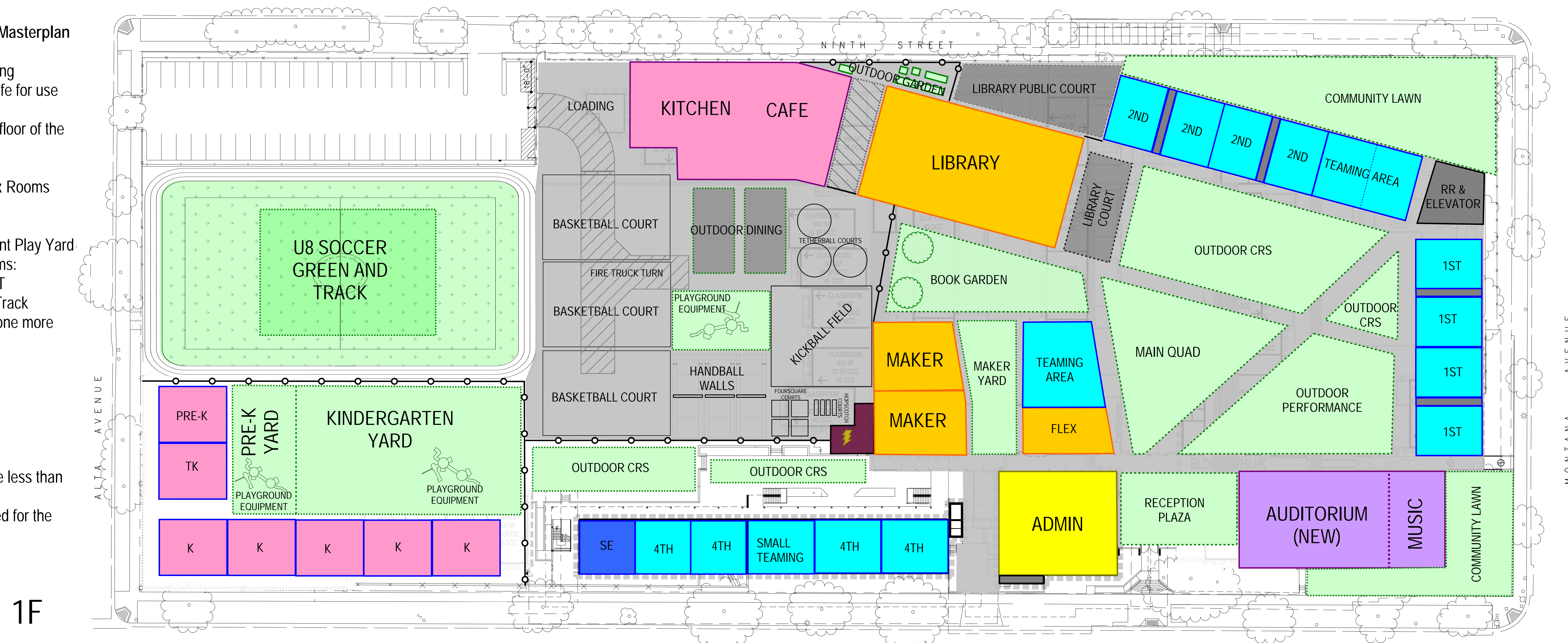

REFINED MASTERPLAN OPTION D

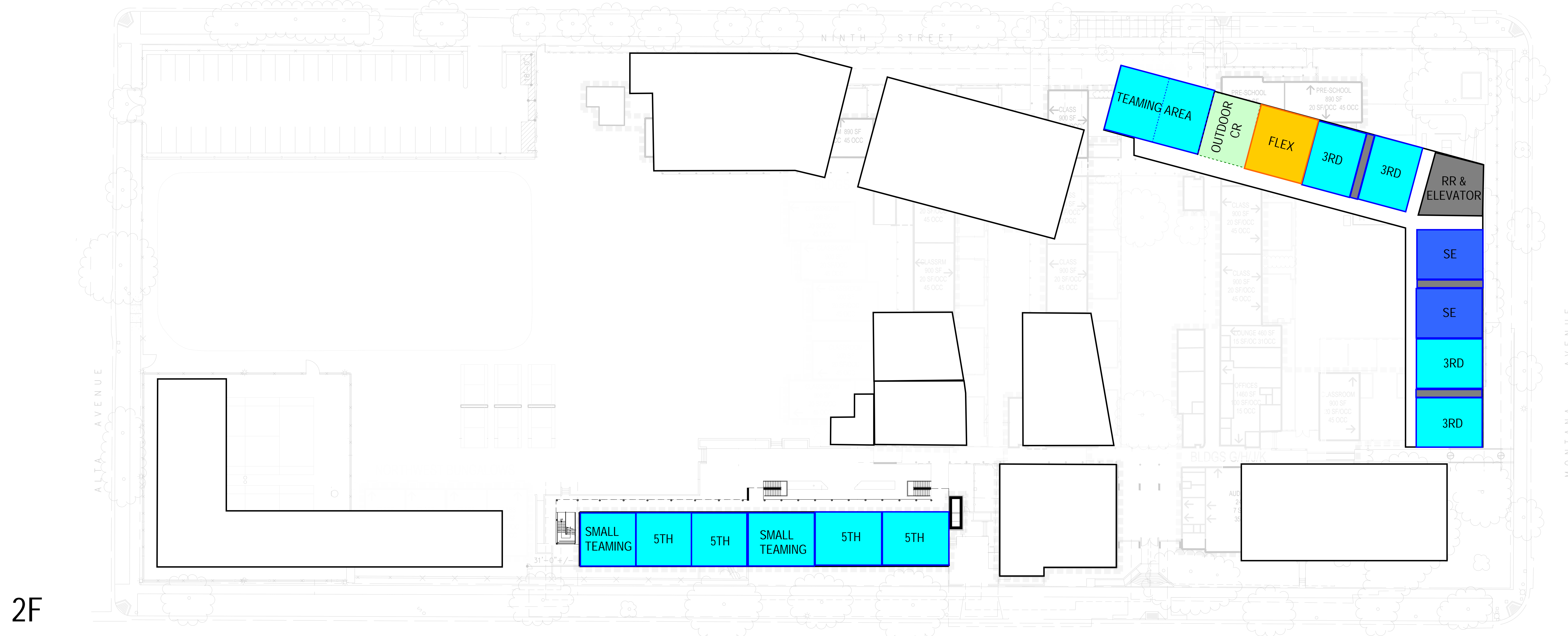

Notes for how this option differs from the Masterplan Proposed at the 2020 Fall Community Mtg:

- Shifts the Restroom / PE Storage Building behind the Electrical Yard
- Moves one of the Flex rooms to the second floor of the Boomerang Building
- Combines the Makerspace with the Teaming Area and Flex Room into one building
- Combines the Maker Yard with the Book Garden
- The Play Yard matches the size of the current Play Yard
- This option has the following Recreation Items:
 - Play Yard approximately 212 FT x 108 FT
 - A U8 Soccer sized field & 3 Lane Track
 - 2 Basketball Courts (matches Option A, one less than Options B & C)
 - 3 Handball Walls
 - 3 Tetherball Courts
 - 4 Hopscotch Courts
 - 4 Foursquare Courts
 - 3 Playground Equipment Structures
 - 1 Public & 2 Kindergarten
 - 3 Outdoor Dining Shade Structures (one is smaller than the previous versions)
 - Various Shade Structures will be designed for the Outdoor Classrooms
 - 1 Kickball Field

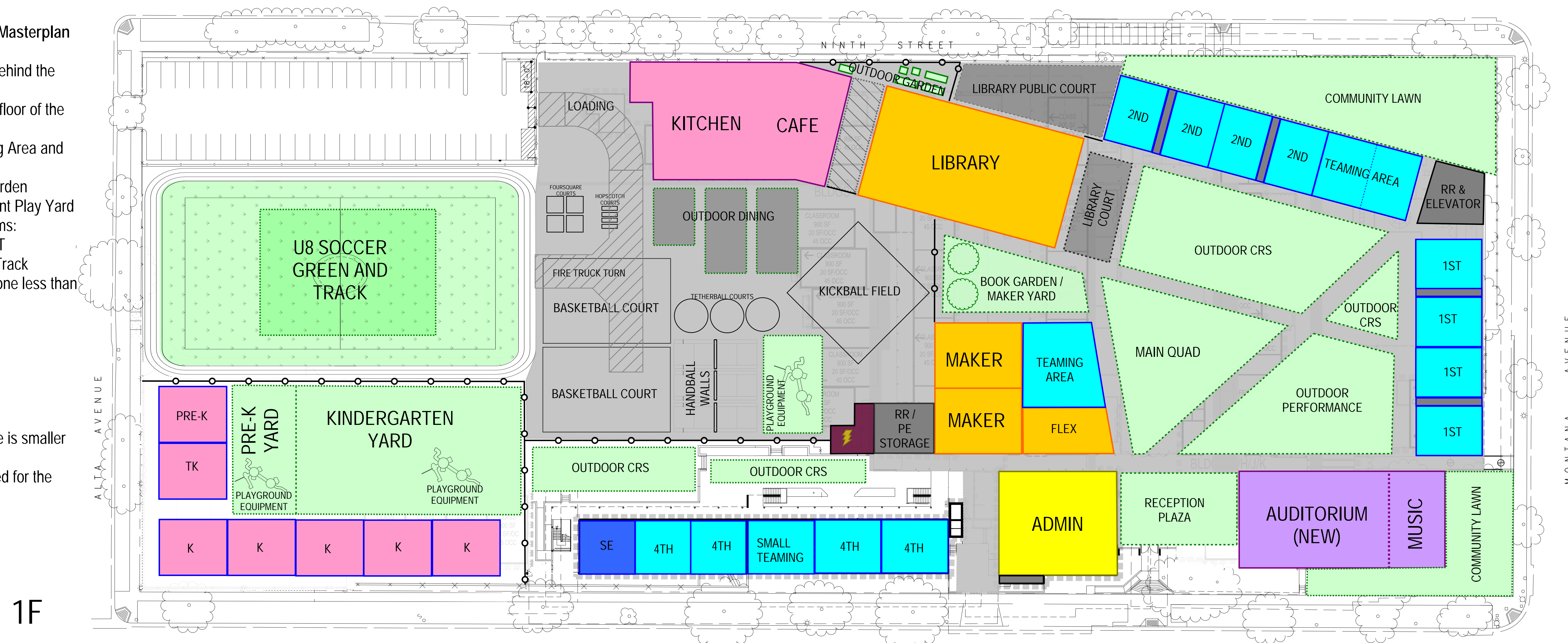

REFINED MASTERPLAN OPTION E

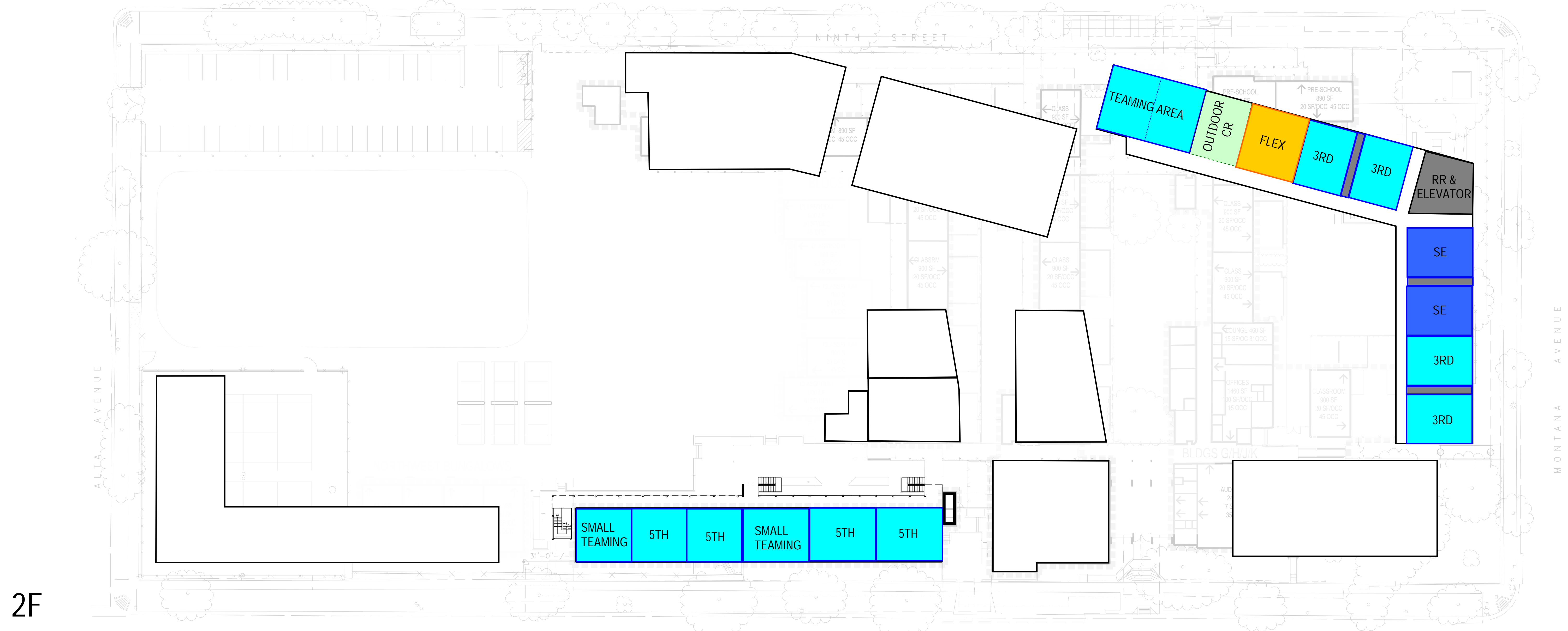

Notes for how this option differs from the Masterplan Proposed at the 2020 Fall Community Mtg:

- Shifts the Restroom / PE Storage Building behind the Electrical Yard
- Moves one of the Flex rooms to the second floor of the Boomerang Building
- Combines the Makerspace with the Teaming Area and Flex Room into one building
- Combines the Maker Yard with the Book Garden
- Adjusts Kitchen / Cafe footprint
- The Play Yard matches the size of the current Play Yard
- This option has the following Recreation Items:
 - Play Yard approximately 212 FT x 108 FT
 - A U8 Soccer sized field & 3 Lane Track
 - 3 Basketball Courts (matches Options B & C, one more than Options A & D)
 - 3 Handball Walls
 - 3 Tetherball Courts
 - 4 Hopscotch Courts
 - 4 Foursquare Courts
 - 3 Playground Equipment Structures
 - 1 Public & 2 Kindergarten
 - 2 Outdoor Dining Shade Structures (matches Option C, one less than Options A, B & D)
 - Various Shade Structures will be designed for the Outdoor Classrooms
 - 1 Kickball Field

