

EXISTING CAMPUS PLAN

02/10/2021

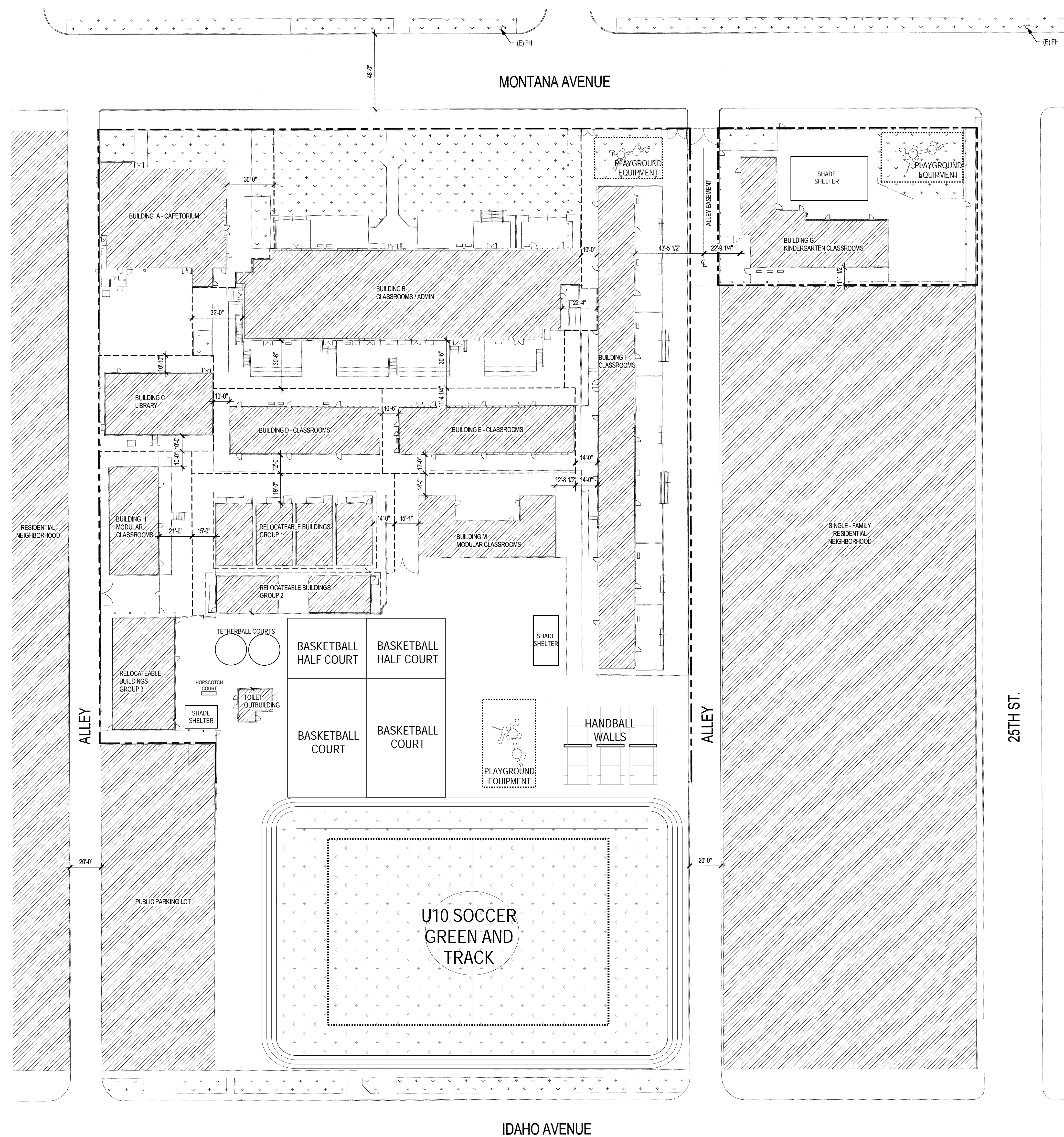

1F

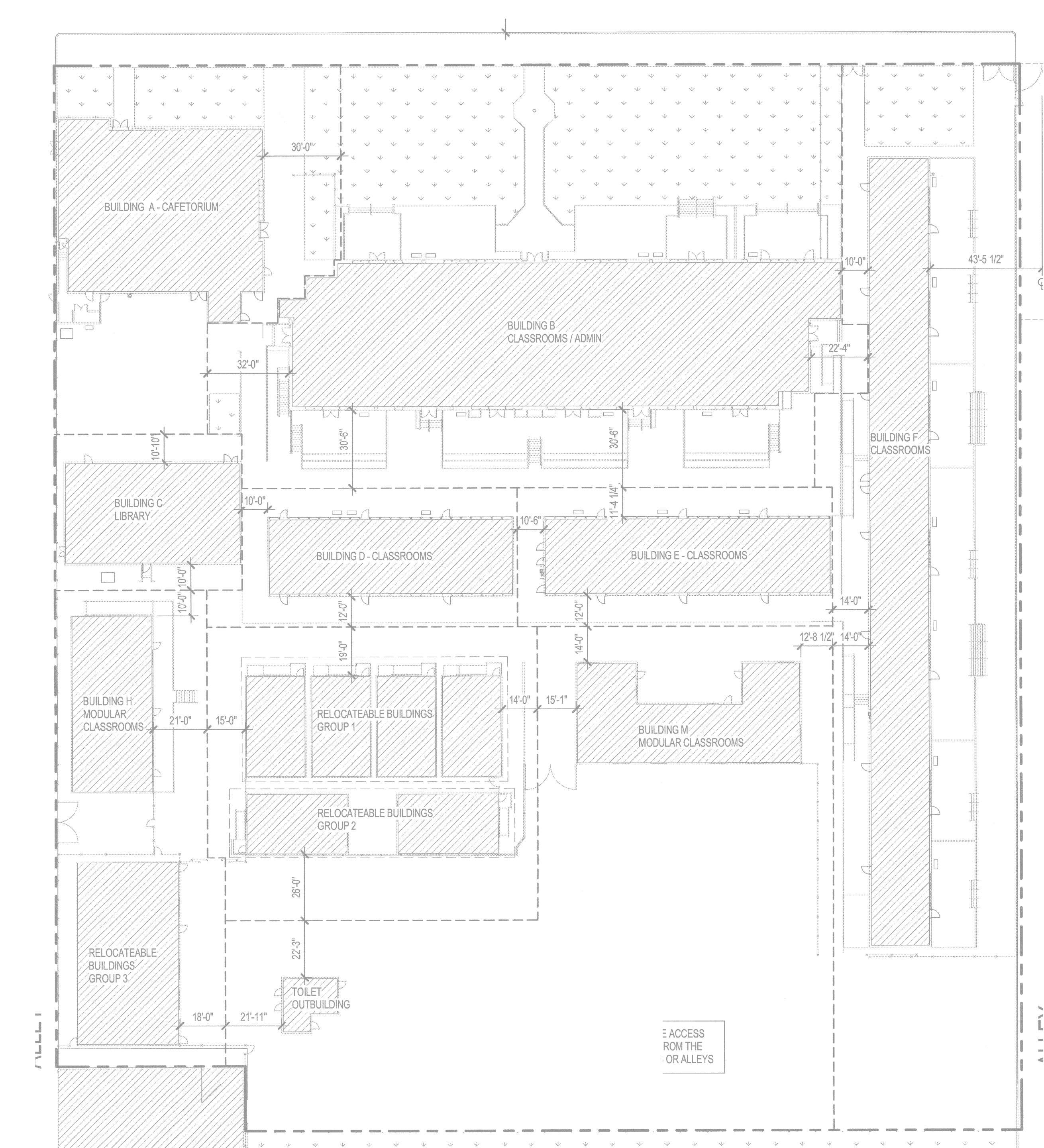

2F

- Notes:
- The Campus has the following Recreation Items:
 - Play Yard approximately 250 FT x 156 FT
 - U10 Soccer sized field & 3 Lane Track
 - 2 Basketball Courts & 2 Half Basketball Courts
 - 3 Handball Walls
 - 2 Tetherball Courts
 - 1 Hopscotch Court
 - 3 Playground Equipment Structures
 - 1 Public & 2 Kindergarten
 - 3 Shade Structures
 - 2 Public & 1 Kindergarten

CURRENT MASTERPLAN PROPOSED
AT 2020 FALL COMMUNITY MEETING

02/10/2021

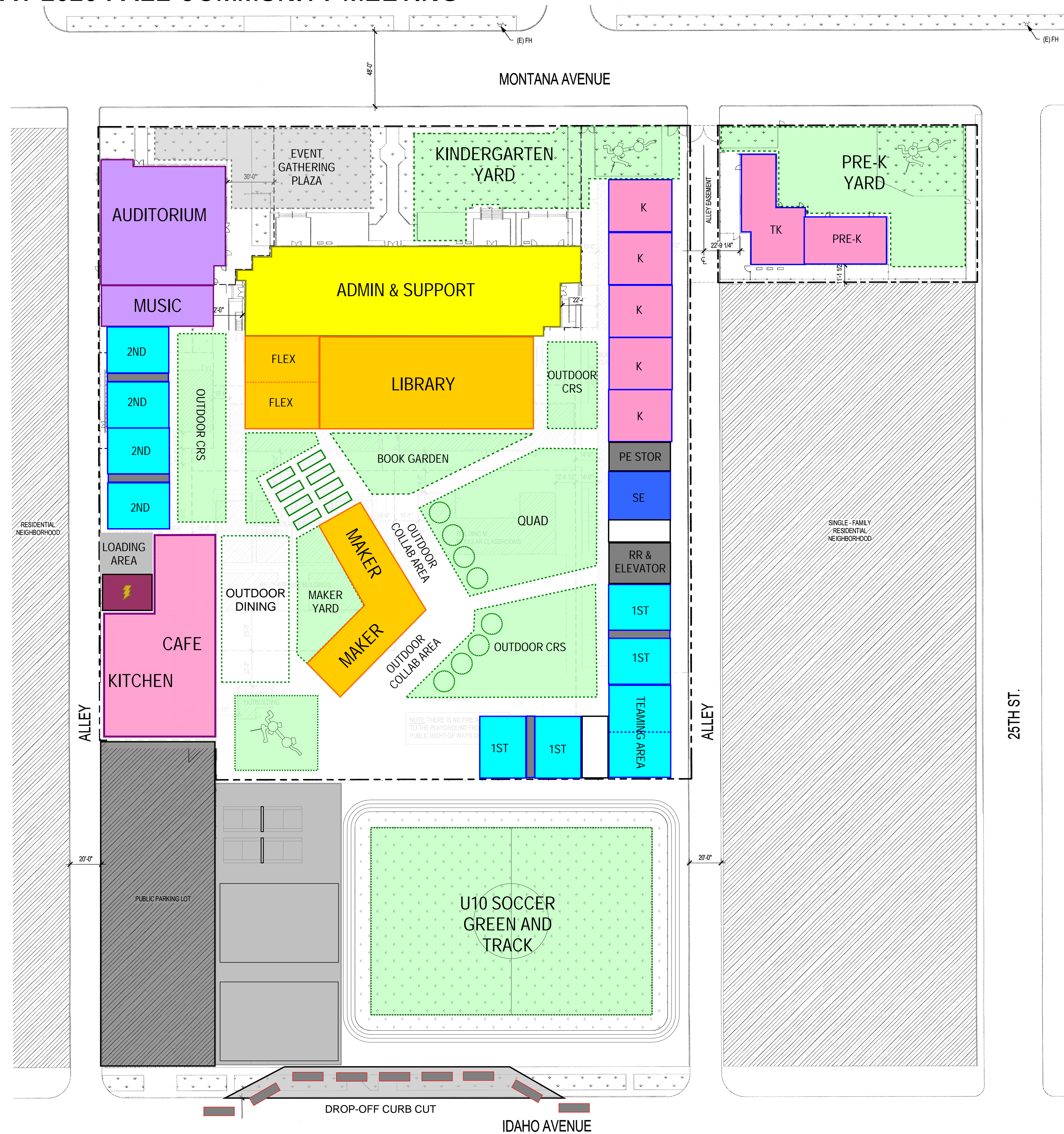

1F

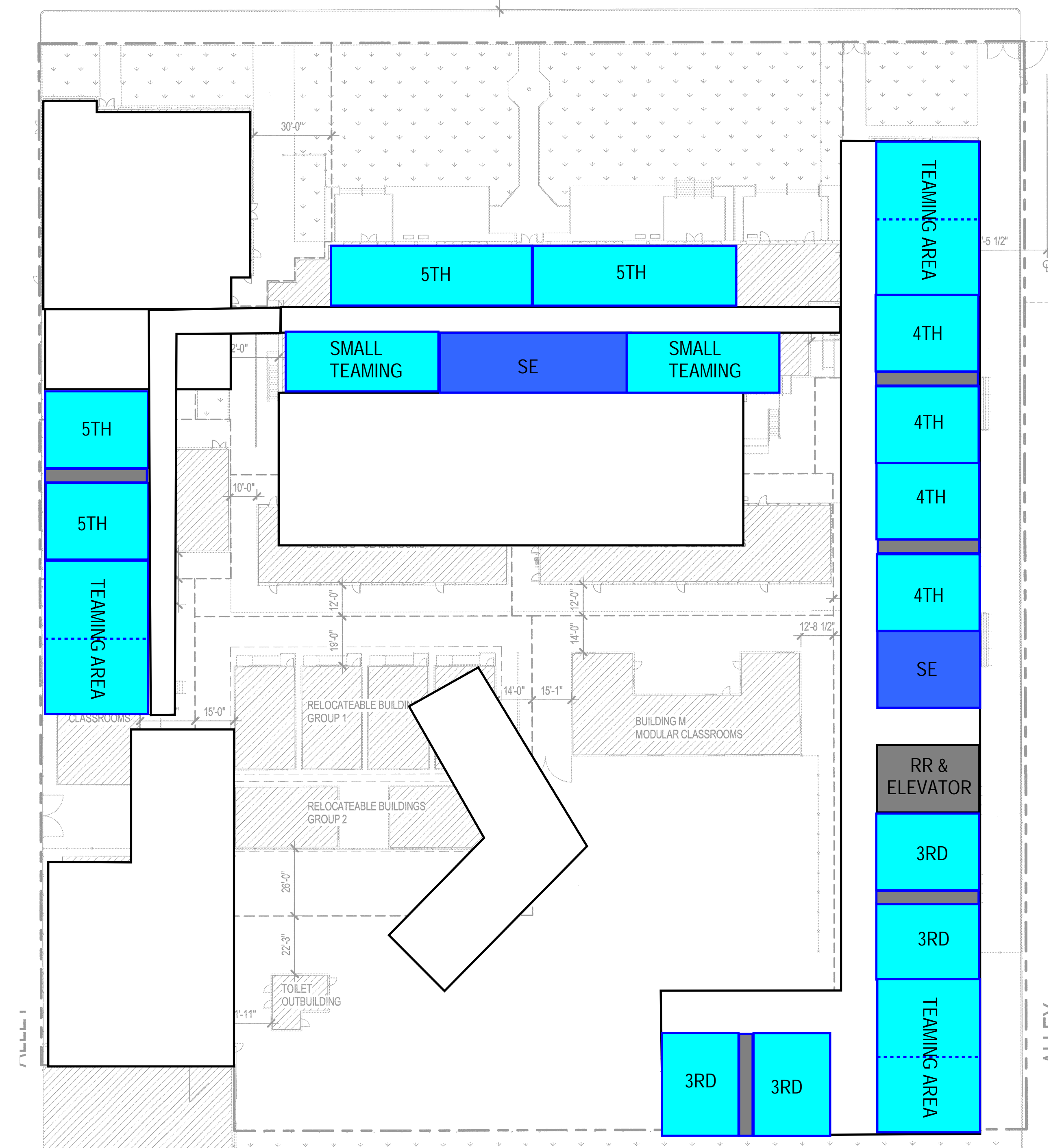

2F

REFINED MASTERPLAN PROPOSED
AT 2020 FALL COMMUNITY MEETING

02/10/2021

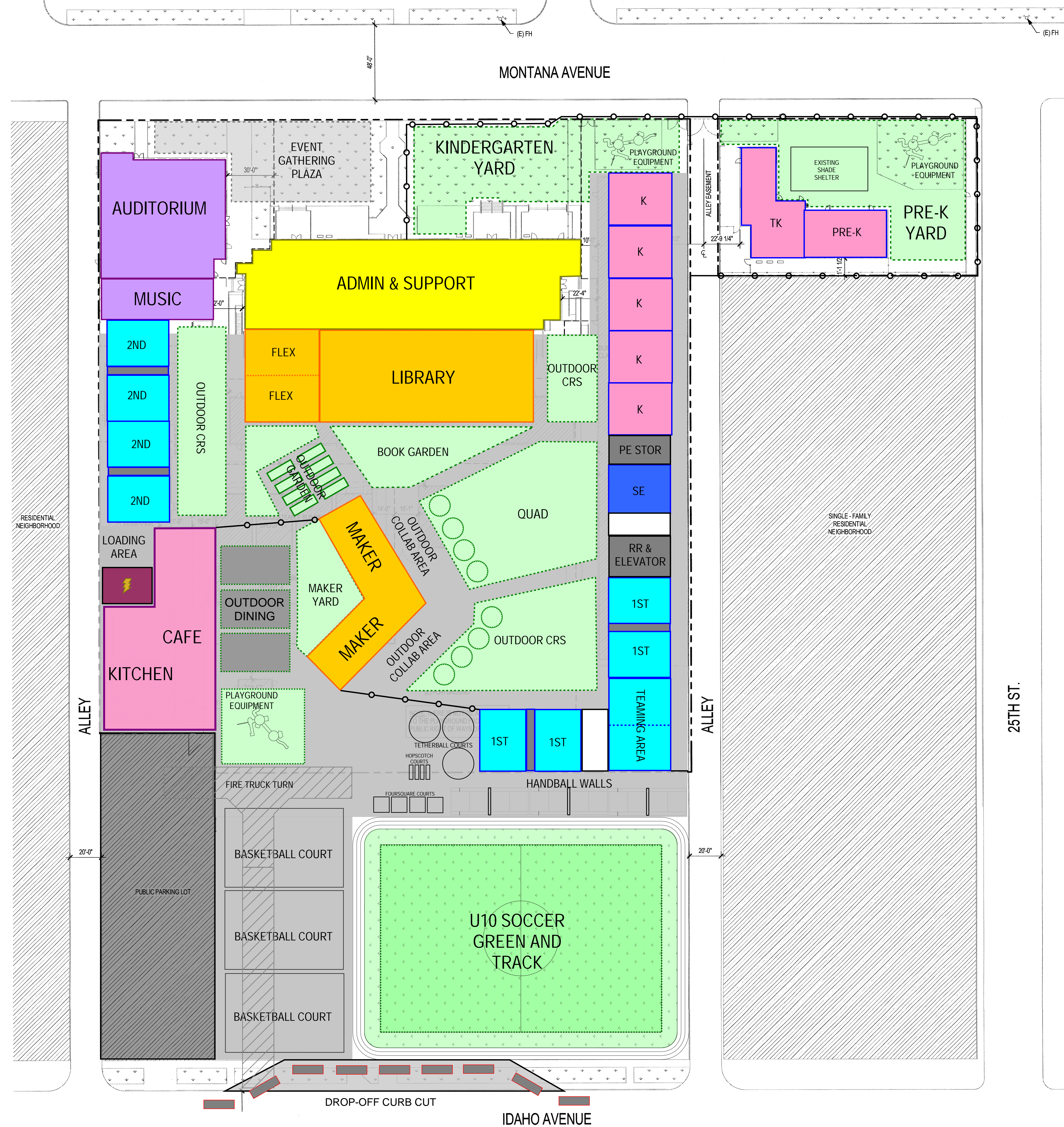

1F

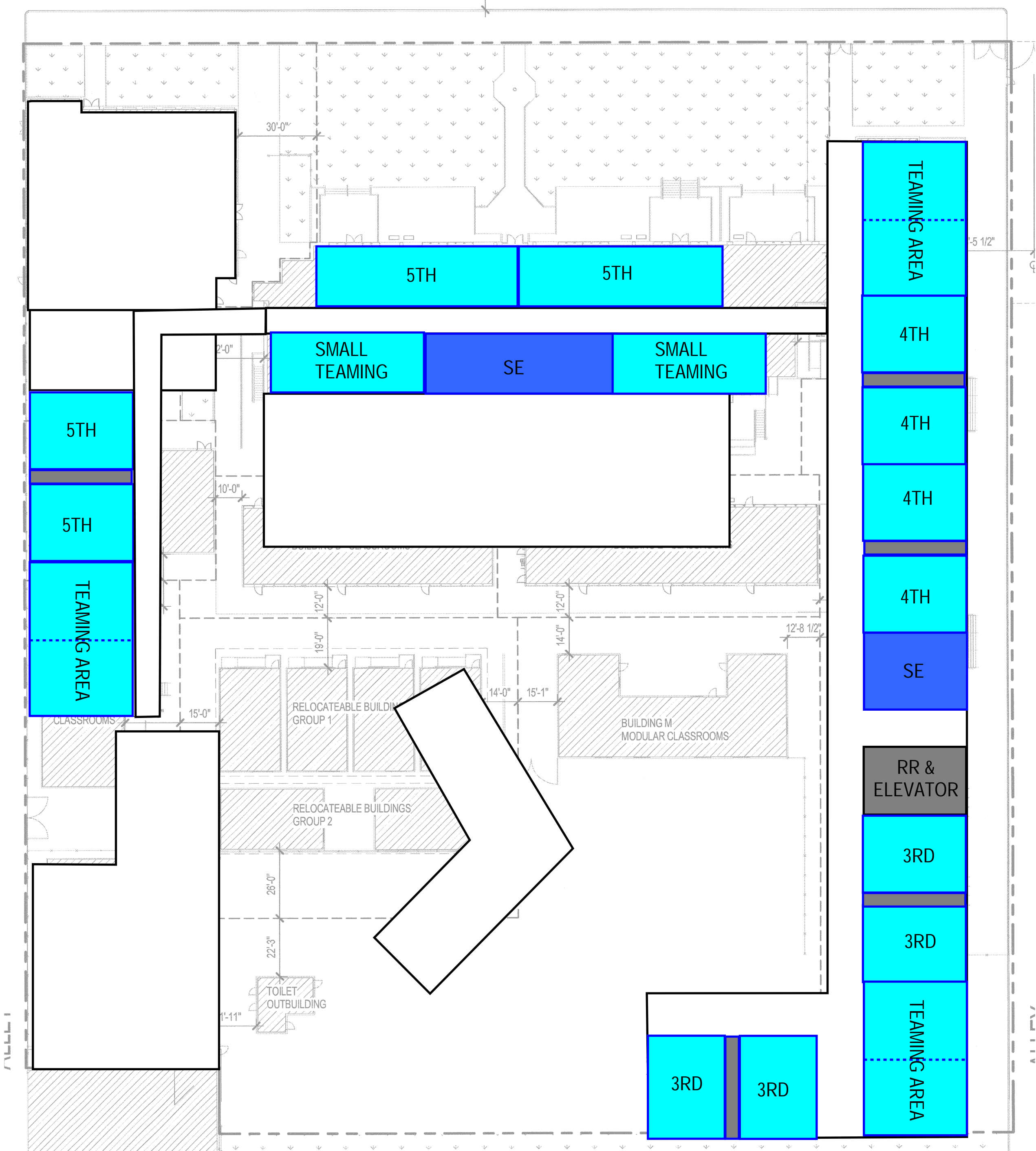

2F

- Notes:
- This option is a refined version of the original Masterplan from the 2020 Fall Community Meeting
 - This option has the following Recreation Items:
 - Play Yard approximately 200 FT x 140 FT
 - U10 Soccer sized field & 3 Lane Track
 - 3 Basketball Courts
 - 3 Handball Walls
 - 3 Tetherball Courts
 - 4 Hopscotch Courts
 - 4 Foursquare Courts
 - 3 Playground Equipment Structures
 - 1 Public & 2 Kindergarten
 - 3 Outdoor Dining Shade Structures
 - Various Shade Structures will be designed for the Outdoor Classrooms
 - Existing Shade Structure in Pre-K Yard to remain

CAMPUS PLAN AFTER MAKERSPACE
BUILDING CONSTRUCTION

02/10/2021

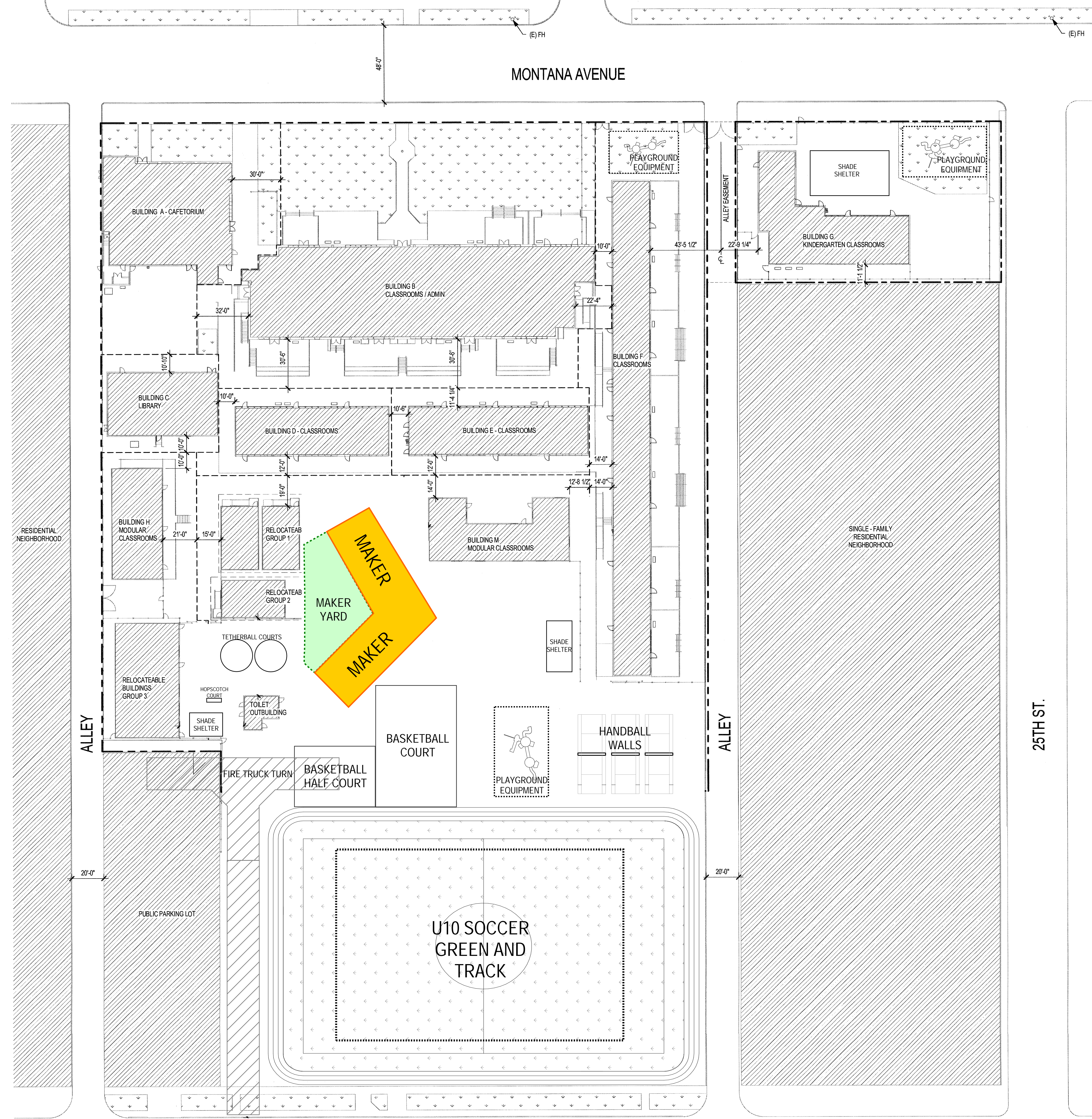

1F

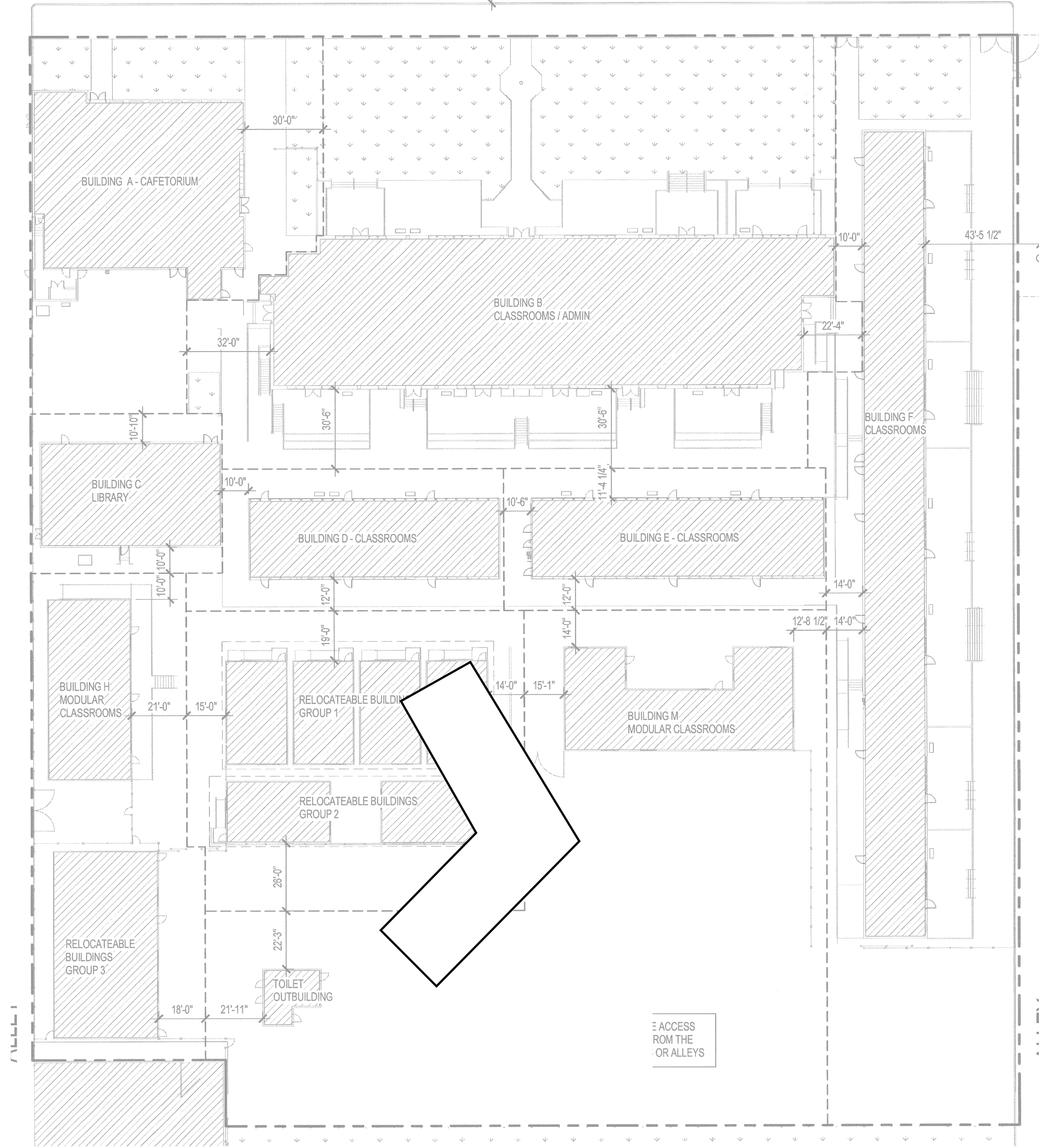

2F

- Notes:
- This is the Masterplan after the first SMS project is constructed
 - This plan has the following Recreation Items:
 - Play Yard approximately 250 FT x 156 FT
 - U10 Soccer sized field & 3 Lane Track
 - 1 Basketball Court & 1 Half Basketball Court
 - 3 Handball Walls
 - 2 Tetherball Courts
 - 1 Hopscotch Court
 - 3 Playground Equipment Structures
 - 1 Public & 2 Kindergarten
 - 3 Shade Structures
 - 2 Public & 1 Kindergarten

REFINED MASTERPLAN OPTION A

02/10/2021

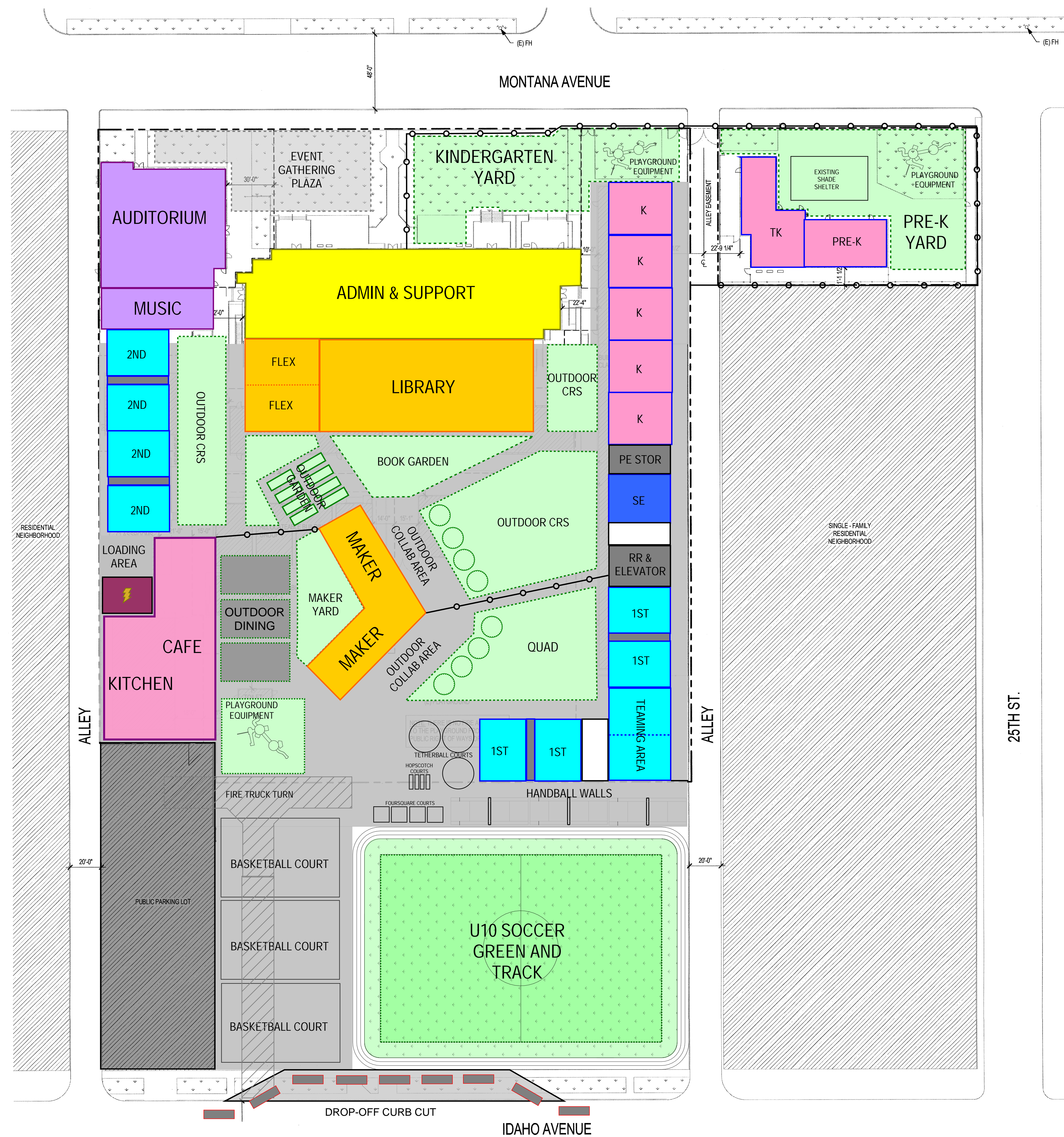

1F

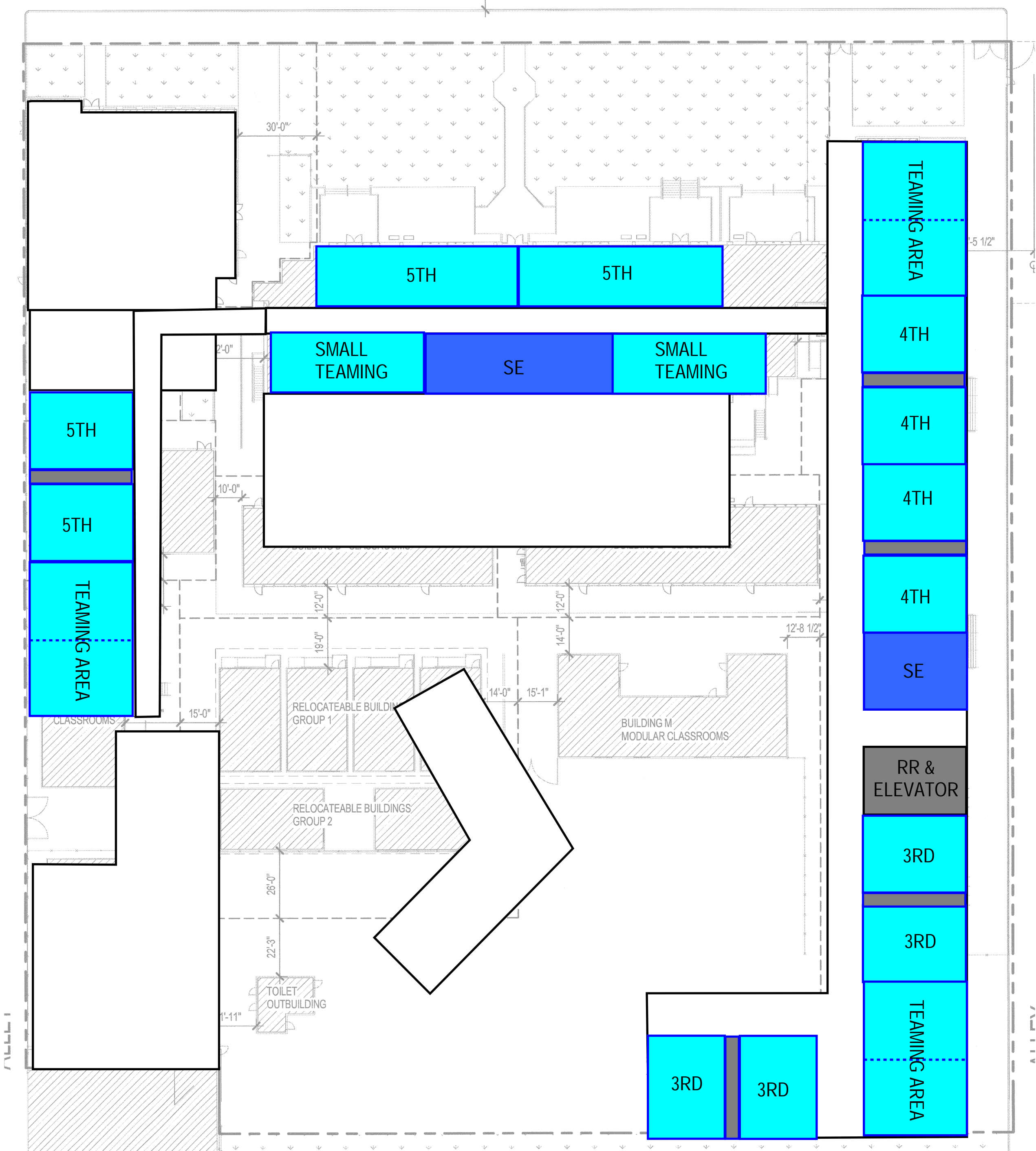

2F

- Notes for how this option differs from the Masterplan Proposed at the 2020 Fall Community Mtg:
- Adjusts fence line to allow public further into Campus
 - Switches the Quad and Outdoor Classrooms
 - This option has the following Recreation Items:
 - Play Yard approximately 200 FT x 140 FT
 - U10 Soccer sized field & 3 Lane Track
 - 3 Basketball Courts
 - 3 Handball Walls
 - 3 Tetherball Courts
 - 4 Hopscotch Courts
 - 4 Foursquare Courts
 - 3 Playground Equipment Structures
 - 1 Public & 2 Kindergarten
 - 3 Outdoor Dining Shade Structures
 - Various Shade Structures will be designed for the Outdoor Classrooms
 - Existing Shade Structure in Pre-K Yard to remain



1F

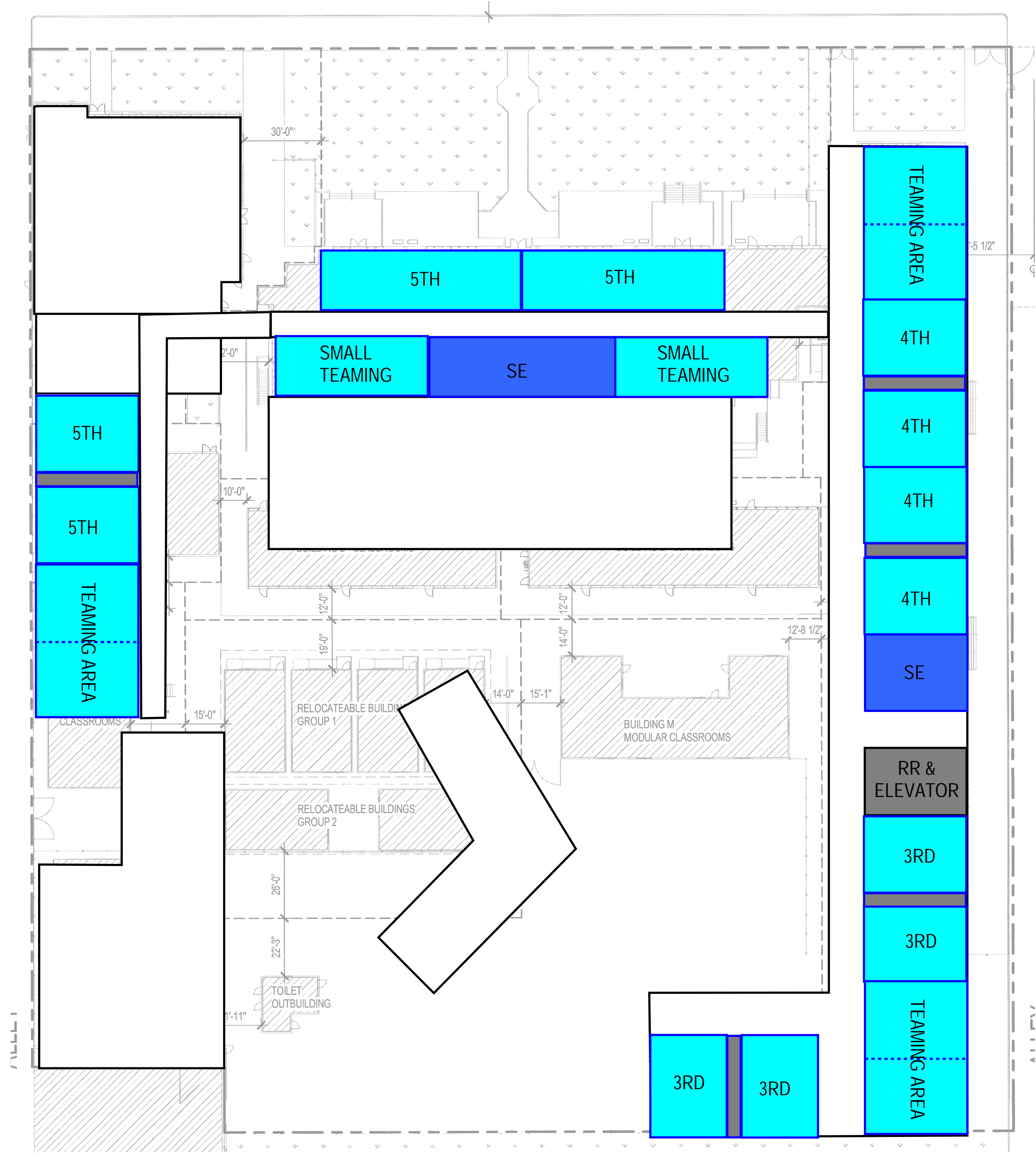

2F

- Notes for how this option differs from the Masterplan Proposed at the 2020 Fall Community Mtg:
- Adjusts fence line to allow public further into Campus
 - Switches the Quad and Outdoor Classrooms
 - Adjusts location of Public Playground Equipment, Tetherball Courts, etc.
 - This option has the following Recreation Items:
 - Play Yard approximately 200 FT x 140 FT
 - U10 Soccer sized field & 3 Lane Track
 - 3 Basketball Courts
 - 3 Handball Walls
 - 3 Tetherball Courts
 - 4 Hopscotch Courts
 - 4 Foursquare Courts
 - 3 Playground Equipment Structures
 - 1 Public & 2 Kindergarten
 - 3 Outdoor Dining Shade Structures
 - Various Shade Structures will be designed for the Outdoor Classrooms
 - Existing Shade Structure in Pre-K Yard to remain



1F

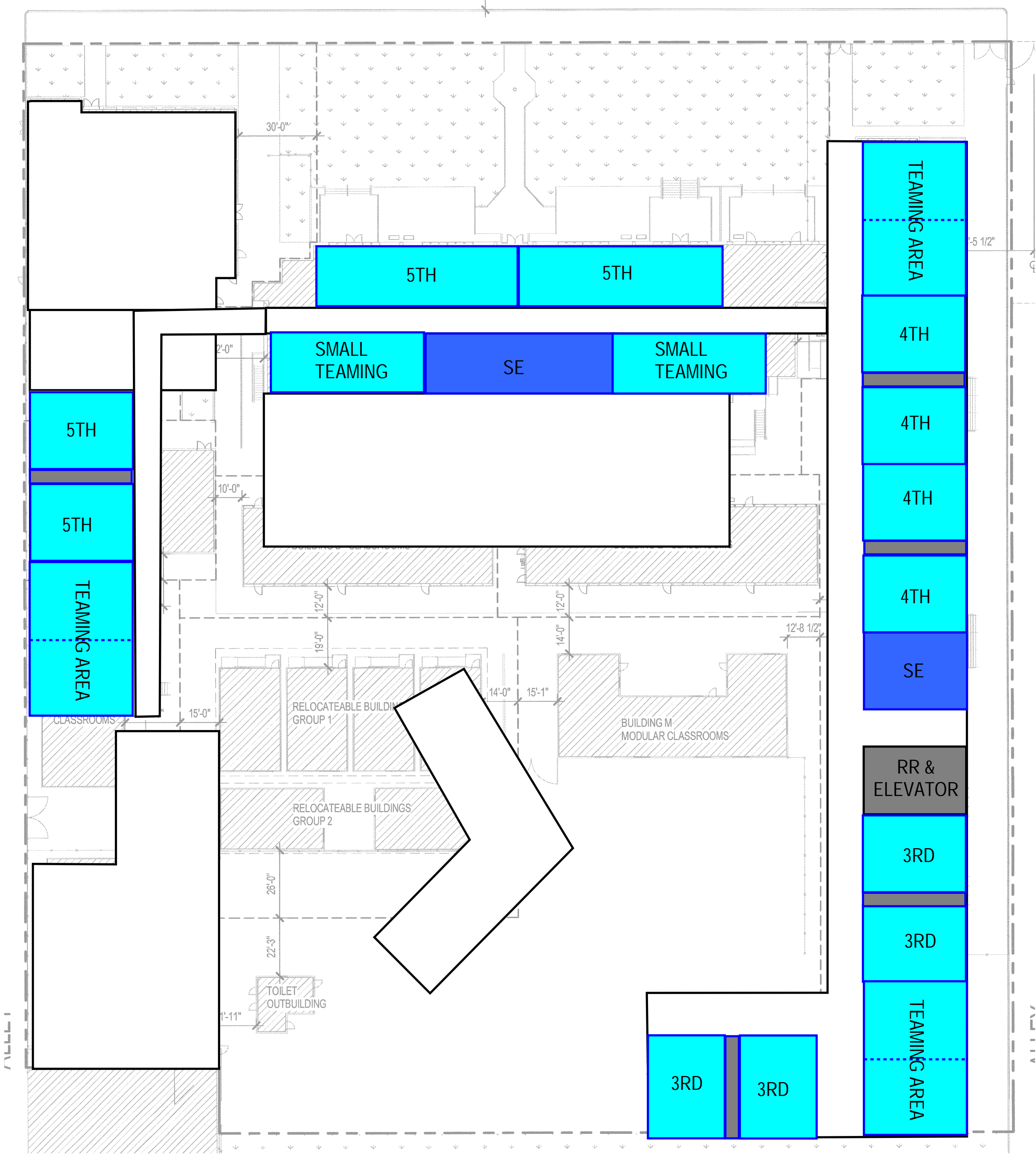

2F

- Notes for how this option differs from the Masterplan Proposed at the 2020 Fall Community Mtg:
- Adjusts fence line to allow public further into Campus
 - Switches Outdoor Classrooms location
 - Removes green space for asphalt between Makerspace Building & "L" Building
 - Adjusts location of Public Playground Equipment, Tetherball Courts, etc.
 - This option has the following Recreation Items:
 - Play Yard approximately 200 FT x 140 FT
 - U10 Soccer sized field & 3 Lane Track
 - 3 Basketball Courts
 - 3 Handball Walls
 - 3 Tetherball Courts
 - 4 Hopscotch Courts
 - 4 Foursquare Courts
 - 3 Playground Equipment Structures
 - 1 Public & 2 Kindergarten
 - 3 Outdoor Dinning Shade Structures
 - Various Shade Structures will be designed for the Outdoor Classrooms
 - Existing Shade Structure in Pre-K Yard to remain

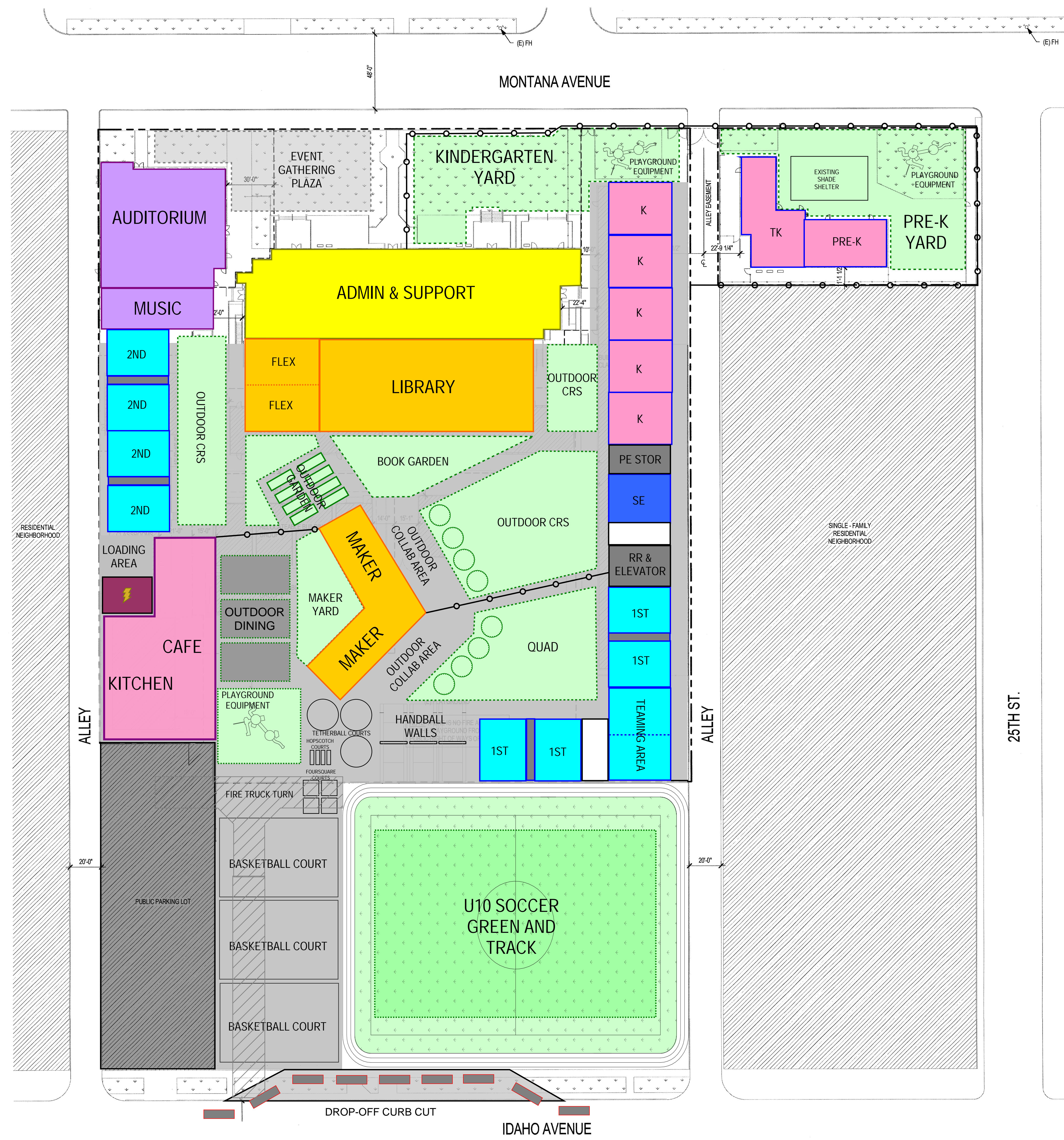

1F

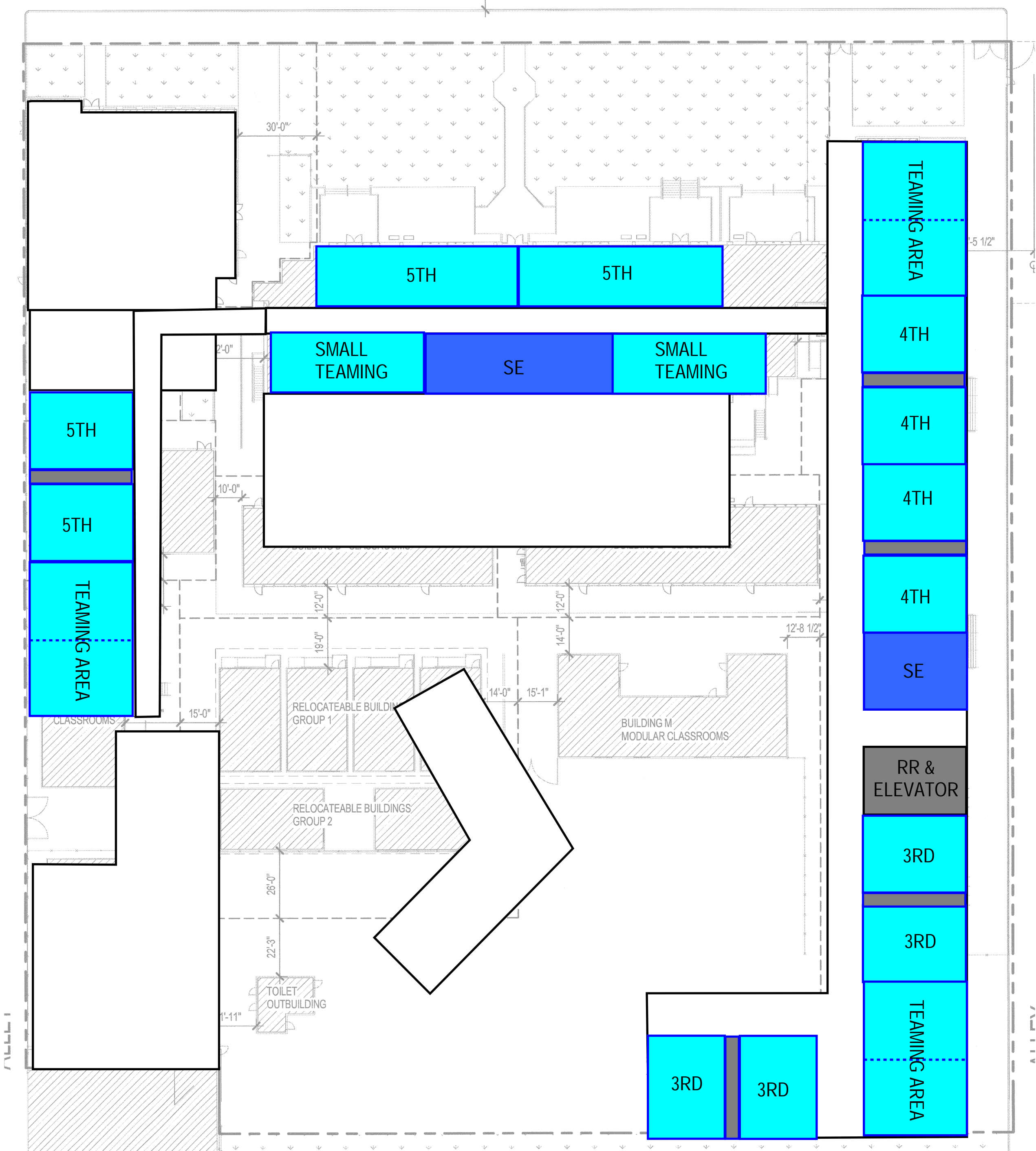

2F

- Notes for how this option differs from the Masterplan Proposed at the 2020 Fall Community Mtg:
- Adjusts fence line to allow public further into Campus
 - Switches the Quad and Outdoor Classrooms
 - Adjusts location of Handball Walls, Tetherball Courts, etc.
 - Enlarges the Play Yard
 - This option has the following Recreation Items:
 - Play Yard approximately 200 FT x 164 FT
 - U10 Soccer sized field & 3 Lane Track
 - 3 Basketball Courts
 - 3 Handball Walls
 - 3 Tetherball Courts
 - 4 Hopscotch Courts
 - 4 Foursquare Courts
 - 3 Playground Equipment Structures
 - 1 Public & 2 Kindergarten
 - 3 Outdoor Dinning Shade Structures
 - Various Shade Structures will be designed for the Outdoor Classrooms
 - Existing Shade Structure in Pre-K Yard to remain

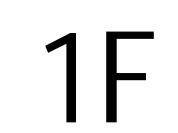

- Adjusts fence line to allow public further into Campus
- Switches Outdoor Classrooms location
- Removes green space for asphalt between Makerspace Building & "L" Building
- Adjusts location of Public Playground Equipment, Handball Walls, Tetherball Courts, etc.
- Enlarges the Play Yard
- This option has the following Recreation Items:
 - Play Yard approximately 200 FT x 164 FT
 - U10 Soccer sized field & 3 Lane Track
 - 3 Basketball Courts
 - 3 Handball Walls
 - 3 Tetherball Courts
 - 4 Hopscotch Courts
 - 4 Foursquare Courts
 - 3 Playground Equipment Structures
 - 1 Public & 2 Kindergarten
 - 3 Outdoor Dinning Shade Structures
 - Various Shade Structures will be designed for the Outdoor Classrooms
 - Existing Shade Structure in Pre-K Yard to remain