



IMPLEMENTATION



MALIBU MIDDLE HIGH SCHOOL
SANTA MONICA-MALIBU UNIFIED SCHOOL DISTRICT



8.0-1 Proposed Master Plan Phasing

The construction sequencing or “Phasing” of the Campus Plan is critical to the successful implementation of the plan over time. The phasing strategies outlined in the following pages must also align with the cash flow of dollars available to the District. The guiding principals of a successful phasing strategy are as follows:

1. Each construction phase must align with available funding source;
2. School(s) must remain operational during each construction phase, minimizing impact to occupied spaces;
3. Safety for the occupants of the school with appropriate separation between construction areas and the school(s).
4. Minimize need for temporary or “Interim” housing of students during construction.
5. Assure students and teachers have access to all required program spaces throughout the construction periods.

The diagram below gives an overall thumbnail view of the proposed 4 phases to build out the new high school and middle school. On the pages to follow, the initial phase 1 is defined in greater detail. As you will see, we have included an alternate to the first phase. Either Phase 1 options are achievable and each has unique advantages that will be explored prior to initiating phase 1.

The District must evaluate each phase to determine how it best serves the school at that time, given the fluctuations in both educational programs and enrollment.

Figure 8.0-1 Proposed Master Plan Phasing

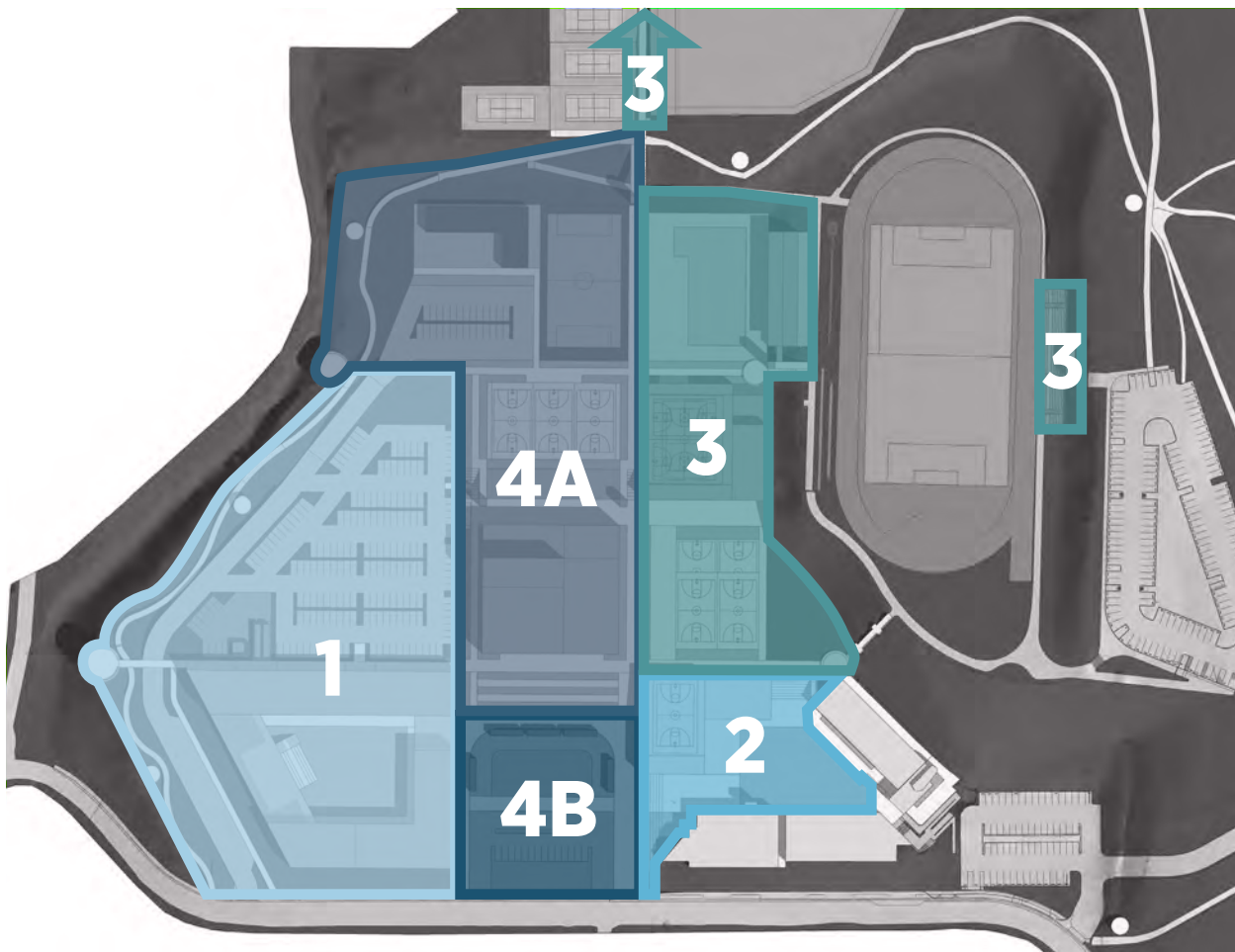

Figure 8.0-2 Existing Condition

This diagram illustrates the existing campus including the approximate number of teaching stations for the high school, middle school and Cabrillo Elementary School. The buildings highlighted in blue represent buildings recently completed or currently in construction.

- MMHS (60) teaching stations
 - MS humanities (8)
 - MS STEAM (7)
 - MS student support services (3)
 - MS support services (1)
 - VAPA (3)
 - HS humanities (14)
 - HS STEAM (18)
 - HS student support services (4)
 - HS support services (2)
- MMHS (6) portable classrooms

- Cabrillo ES (22) teaching stations
- Cabrillo ES (5) portable classrooms

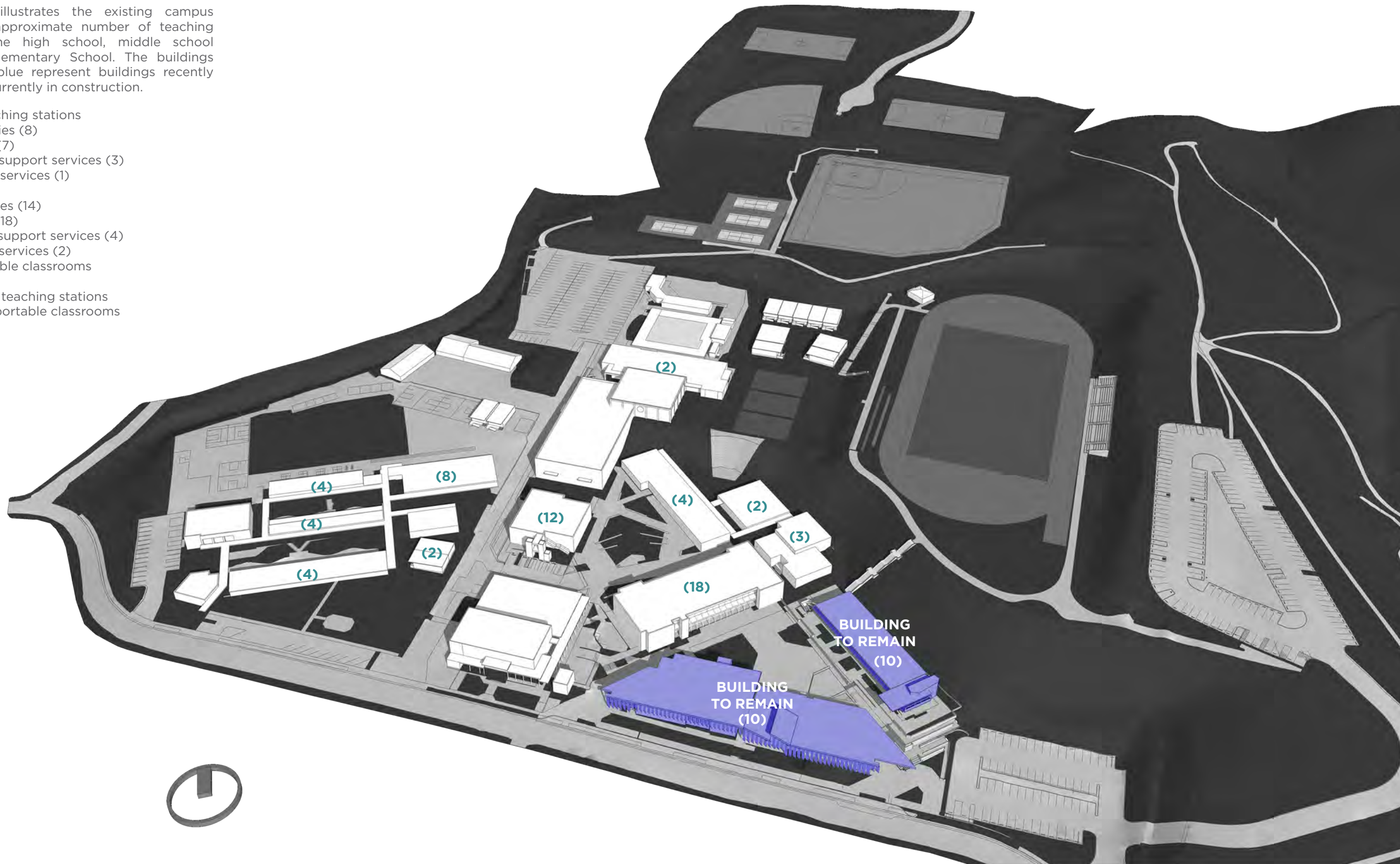

Figure 8.0-4 Phase 1 Build

High school academic building

- STEM classrooms (+9)
- General classrooms (+8)
- VAPA classrooms (+1)
- Special ed (+3)
- Food service
- Student union (+1)
- Library
- Administration

Site

- Loading dock and small parking area

(66) teaching stations total

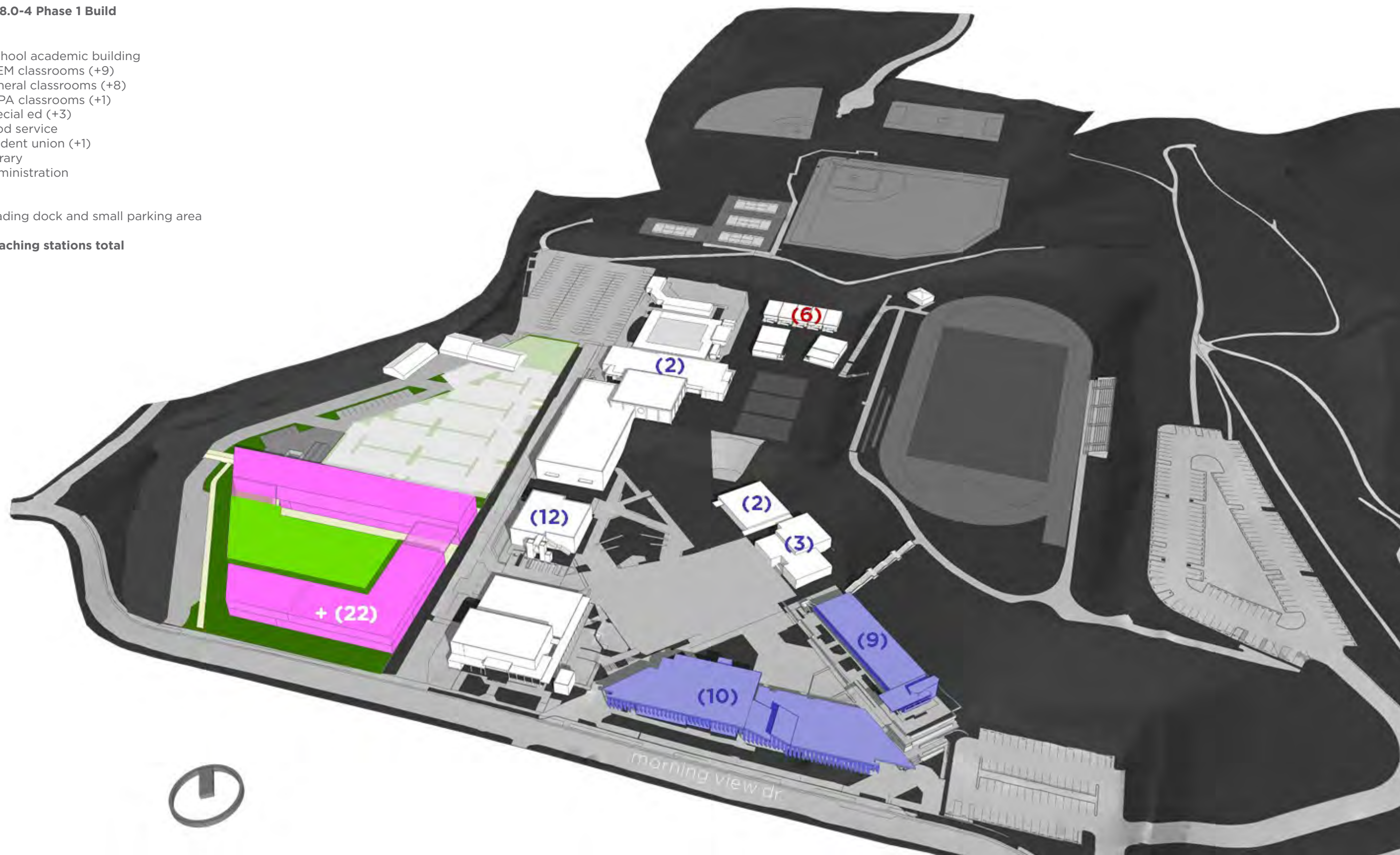

Figure 8.0-4 Phase 1 Build - Alternate A

High school academic building

- STEM classrooms (+10)
- VAPA classrooms (+2)
- Administration

Site

HS quad

- Grading for future HS expansion

(65) teaching stations total

