



Don G. Murphy Inc.
Architect, AIA

118 WEST OLIVE AVENUE
MONROVIA, CALIFORNIA 91016
(618) 357-8734

INTERIOR PLANNING
ARCHITECTURAL
CHARETTES, INC.

MARINA DEL REY, CA
CONSULTANT

REVISIONS

NO.	DATE	BY	DESCRIPTION
1			
2			
3			
4			
5			
6			
7			
8			

PROJECT TITLE

SANTA MONICA BUSINESS PARK
1651 16TH STREET
SANTA MONICA

DEVELOPER:
MIDIS PROPERTIES, LTD.
5743 CORSA AVE, SUITE 208
WESTLAKE VILLAGE, CA 91362

CONTRACTOR:
CITY DEVELOPERS, INC.
5743 CORSA AVE, SUITE 208
WESTLAKE VILLAGE, CA 91362

SHEET TITLE
FURNITURE LAYOUT
SECOND FLOOR

COPYRIGHT NOTICE	PROJECT NO.	SHEET
DATE	DATE	1-8
DESIGNED BY	CHECKED BY	
DRAWN BY	DATE	

NOTICE TO TENANT
DO NOT REMOVE
OR ALTER ANYTHING
FROM THIS FLOOR
IF YOU HAVE A
SPECIAL REQUIREMENT
IN AN UNOCCUPIED AREA,
PLEASE CONTACT DESIGN
DEPT. ARCHITECTURAL CHARETTES

1.407

478

6.093

2.568

1.878

3.039

2.600

TOTAL SQUARE FEET:
18,063 APPROXIMATE

FIXED WALLS & PARTITIONS
MOVABLE PARTITION PANELS (M.C.)

FURNISHINGS BY GENERAL BOARD

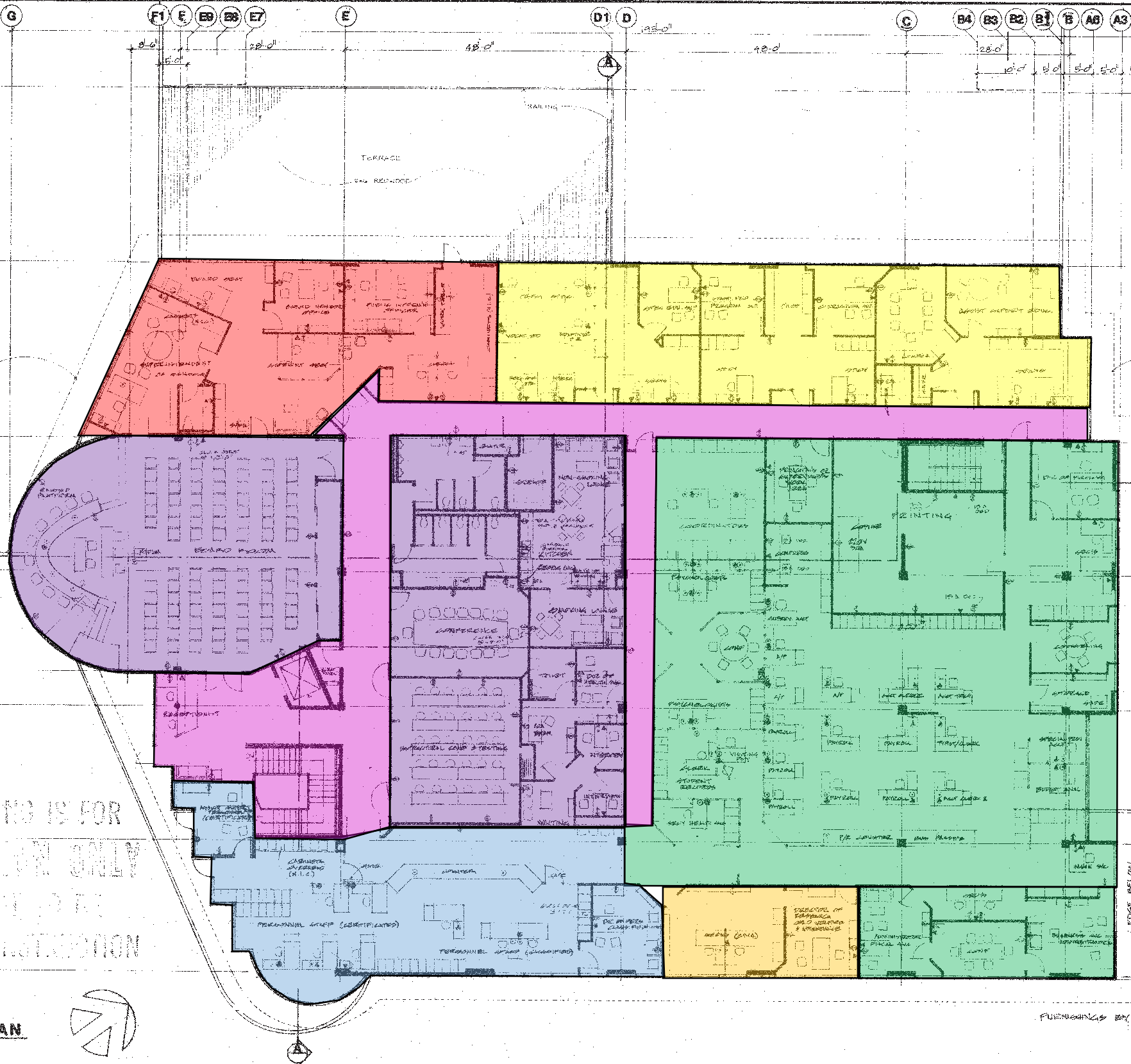

THIS DRAWING IS FOR
REVISION ONLY
AND NOT TO BE
USED FOR CONSTRUCTION

SECOND FLOOR PLAN

SCALE: 1/8"=1'-0"

