



Measure MM Project List

SFID #2

November 2024 Bond Measure

Fall 2024

Measure MM Project List

In our rapidly evolving world, education must adapt to meet the changing needs of 21st-century learners. The classrooms must adapt to support the changes in learning. It is imperative all students have access to the resources and facilities necessary for their academic growth and development. In addition, many of our aging facilities require modernization or even replacement to continue to be safe and effective learning facilities.

The 2024 general obligation bond measure for School Facility Improvement District (SFID #2) (Malibu only) will provide a vital source of funding to support much-needed construction projects. By investing in the modernization of our school buildings, we have the opportunity to continue to create world-class 21st-century learning spaces that foster creativity, collaboration and critical thinking. As we proceed on this journey towards educational excellence, SMMUSD embraces the importance of prioritizing the needs of our students to ensure every child has the opportunity to thrive in a dynamic and innovative learning environment.

The Facility Improvement Projects (FIP) Department has been working extensively with school sites, teachers, staff, students and members of the community to develop and prioritize the projects that will meet the greatest needs and have the most impact to improving student learning. This document recommends some proposed projects to be funded from the next bond measure.

Malibu Middle School: Phase 2: Gymnasium and Aquatics Center



Contact: Michael Burke

Renderings are subject to change.

Project Description:

This project is centered around the completion of the middle school campus. A new student services building will become the center of that campus leading with a large broadcast/media center and an area for ASB functions. The building and outdoor area will include food service, dining and an exterior shaded lunch shelter/gathering area. In addition, the building will also be the central location for special education-life skills, counseling and wellness center.

Project Description: Gymnasium

A new middle school gymnasium will feature a full-size basketball court or three volleyball courts with bleacher seating, lockers/shower room and staff offices. A second-floor fitness studio and outside exercise deck will provide additional space for recreation. Exterior play courts and seating areas and will join the two buildings. An outdoor fitness area including climbing areas and a slide from upper campus will create areas for recreation and outdoor learning.



(continued)

Malibu Middle School: continued

Phase 2: Gymnasium and Aquatics Center

Project Description:

Aquatic Center

An aquatics center will complete the project. The pool will be used for physical education, sports teams and the community. It will replace the current pool. The aquatic center will include a 2-story support building with offices, lockers and equipment rooms on the lower floor. The upper floor will have bleachers to observe pool activities and team rooms, concessions and storage to support all field sports. The center will also provide a separate structure with an office for city functions including locker/shower rooms for community use.



Renderings are subject to change.



Construction is scheduled to begin by June 2026.

Construction Cost: \$86 Million

(continued)

Webster Elementary School – Assessments: Science, Technology, Engineering and Mathematics (STEM) lab, new library, central courtyard and resurfacing entry road

Contact: Michael Burke

Project Description:

As education changes and the elementary school campuses age, it is essential to plan how these school facilities need to evolve to support future learning. The elementary school campuses assessments will review use of the current facilities, develop plans to improve learning and create a phased campus plan to support education for the next 50 years.



Education Specifications were developed to guide the improvement of facilities to support changes in education. In addition to describing the District's educational goals, this document explains the range of facility space requirements necessary to facilitate project based, discovery, and collaborative approaches to teaching and learning that encourage individual and small group collaboration—a learning model that more closely aligns with today's workforce needs.

The District has engaged Huckabee Architects on the Webster and Malibu Elementary School campuses. Working with the education specifications as a blueprint they are developing several schemes that foster the growth of a new campus over the next decade. Some of the first projects at the Webster campus would be a new STEAM lab, in place of the upper portables, new library, new central courtyard and a renovation of the exterior courtyards behind the classrooms. Other projects include the relocation of the Boy's and Girl's Club and resurfacing of the entry road.

Later phases could include a new administration building in the front and center of campus, allowing more site supervision from drop-off through daily operations. A rethinking of the playfields is also underway and new staff parking

(continued)

Malibu Elementary School – Assessments: New 2-story administration building, kitchen/cafeteria, upper elementary classrooms

Contact: Michael Burke

Project Description:

The ideas from the design team on Malibu Elementary site are also centered around a more efficient campus. Removing the current portables from the back of campus would allow new 2-story administration building along Greyfox. Having administration along that side of campus would allow for student drop off on that road, providing a more central and secure entry area.

The new kitchen/cafeteria would be adjacent to administration and new upper elementary classrooms could be on the second floor. This one building would provide a strong central organizational element for the school allowing for the future development of classrooms, library, art, marine science rooms, courtyards and a multi-purpose building.

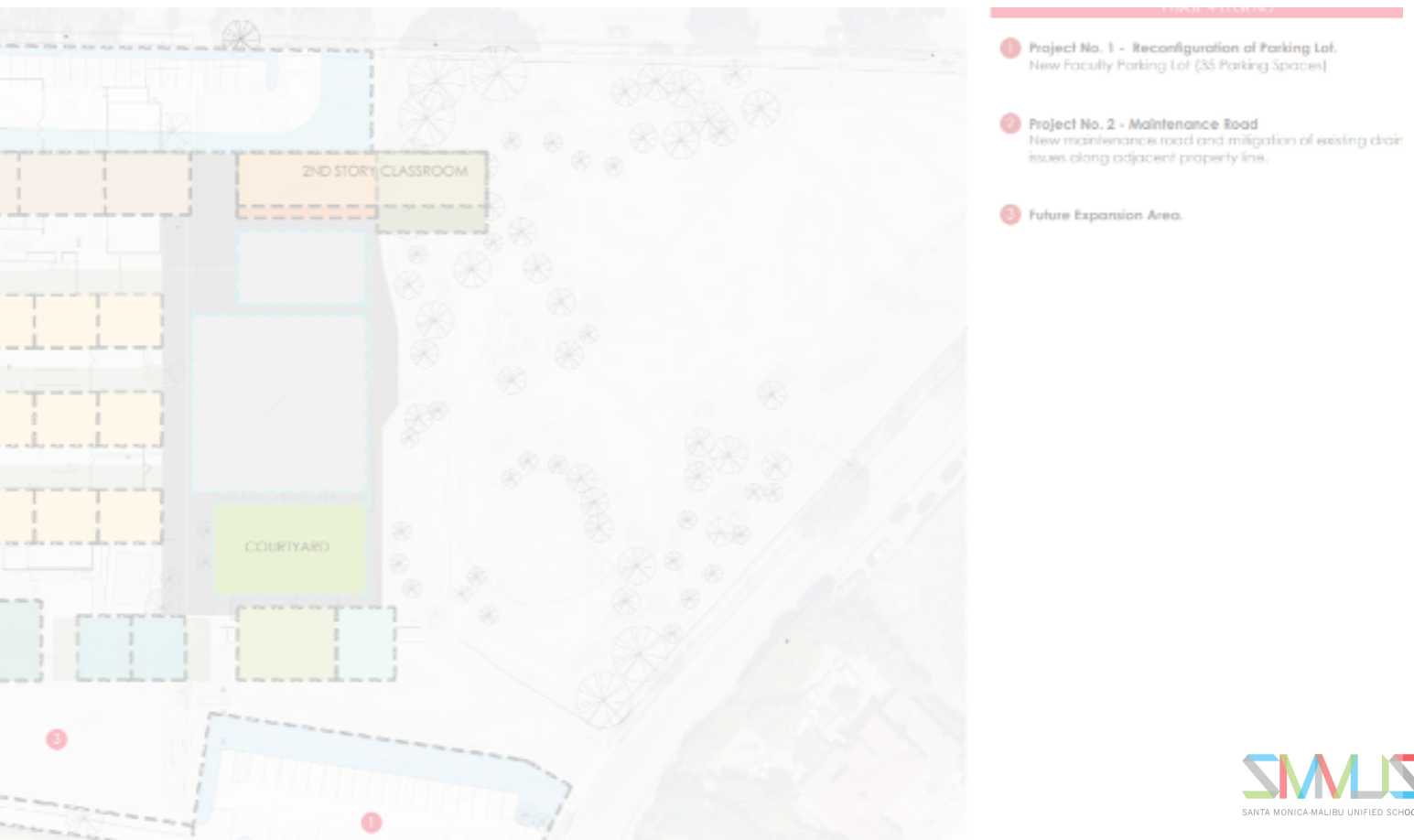
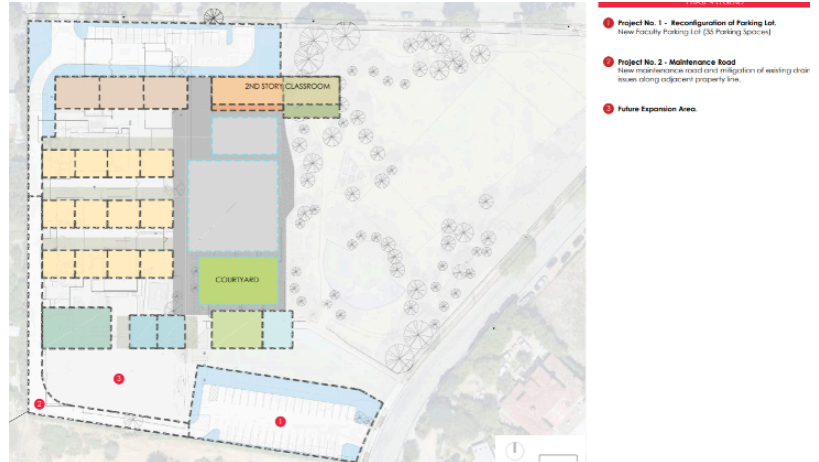

The background image is a photograph of a modern school cafeteria. It features long, white, curved tables arranged in rows. Underneath the tables are orange chairs with metal frames and wheels. The room has a high ceiling with exposed wooden beams and several long, rectangular pendant lights hanging from it. Large windows on the right side of the room provide a view of the outdoors, which includes a fence and some greenery. The overall atmosphere is bright and clean.

Thank You!